



**HUNTERS**<sup>®</sup>  
HERE TO GET *you* THERE

10, Amphion House Thunderer Walk, London, SE18 6NW

10, Amphion House Thunderer Walk, London, SE18 6NW

Guide Price £350,000 - £400,000

GUIDE PRICE - £350,000- £375,000.

Discover true urban living in this exquisite Manhattan-style first floor super studio apartment, nestled within the prestigious Royal Arsenal Riverside Complex, just 0.1 mile from the Crossrail/Elizabeth Line. This meticulously designed residence offers a fusion of elegance and functionality.

Upon entry, you'll be greeted by a communal entrance boasting a secure entry system, ensuring your peace of mind. Step inside to find a thoughtfully laid out space, comprising an inviting open-plan lounge/kitchen area, seamlessly integrated to create a harmonious living experience.

Enjoy the luxury of balcony views overlooking a meticulously landscaped courtyard, providing a serene retreat from the hustle and bustle of city life. Additionally, residents gain exclusive access to the Waterside Club, complete with concierge services, a state-of-the-art gym, rejuvenating spa facilities, a sparkling swimming pool, lush gardens, and a private cinema—perfect for entertaining or unwinding in style.

The sleeping quarters, cleverly delineated by unique bi-folding doors, offer privacy without compromising on space or natural light. Completing this haven is a well-appointed bathroom, offering a sanctuary for relaxation.

Experience the vibrant lifestyle that Royal Arsenal Riverside has to offer, with an array of on-site amenities including charming cafes, theatres, Starbucks, and food halls just moments away. For those seeking outdoor adventures, the tranquil Thames Path awaits mere steps from your doorstep.

To truly appreciate the allure of this exceptional property, an early viewing is strongly recommended. Don't miss the opportunity to make this urban oasis your own.

Hunters Abbey Wood 19-21 Wilton Road, Abbey Wood, London SE2 9RH | 020 8311 1000  
abbeywood@hunters.com | www.hunters.com

# Amphion House, Thunderer Walk, London, SE18

Approximate Area = 428 sq ft / 39.7 sq m

For identification only - Not to scale

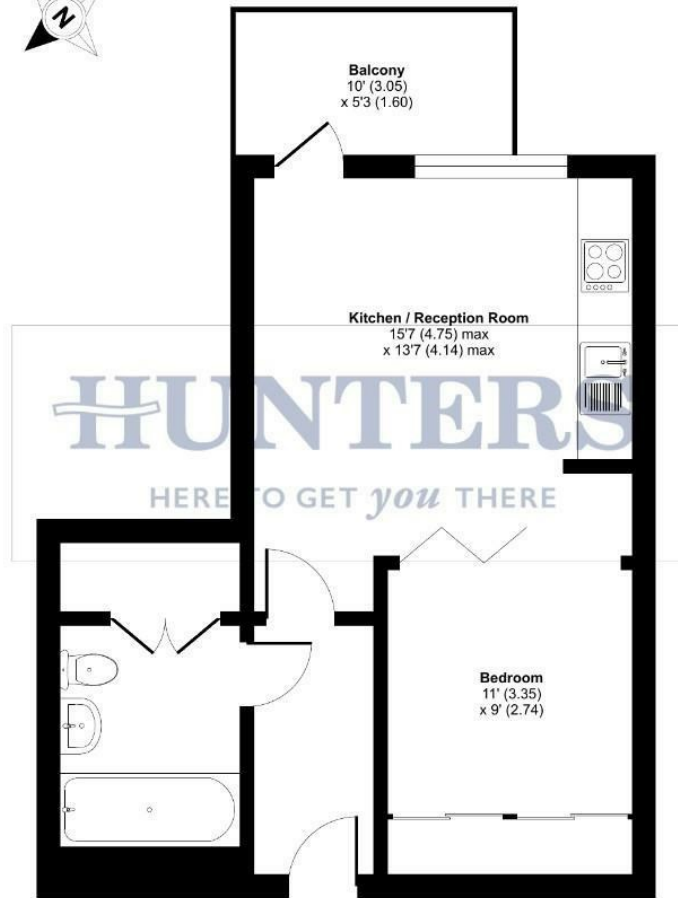

FIRST FLOOR



Floor plan produced in accordance with RICS Property Measurement Standards incorporating International Property Measurement Standards (IPMS2 Residential). © rics/ecom 2024. Produced for Hunters Kent Ltd - Abbeywood & Bevley Heath. REF: 1070009

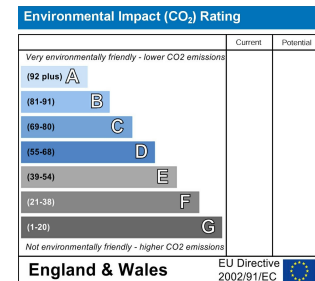
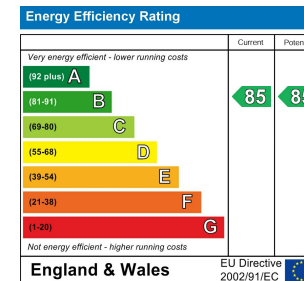

**Communal Entrance**

**Entrance Hall**

**Open Plan Living, Kitchen and Bedroom Area**

**Bathroom**

**Balcony**

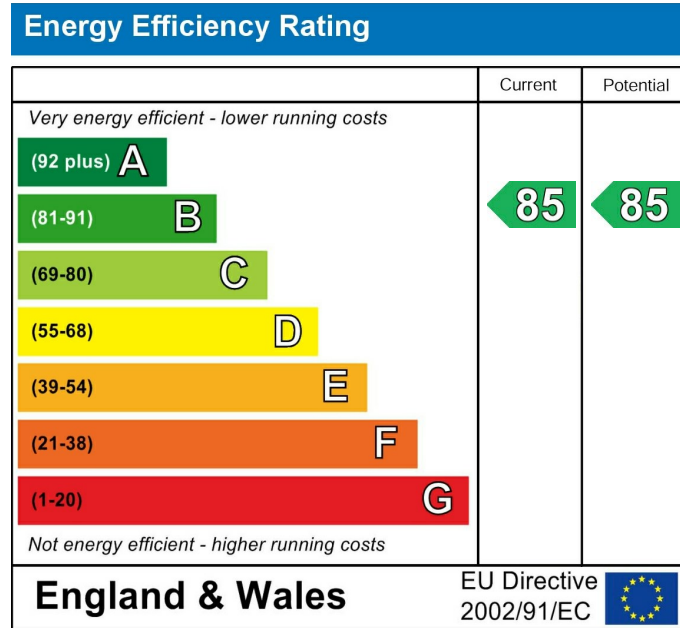

These particulars are intended to give a fair and reliable description of the property but no responsibility for any inaccuracy or error can be accepted and do not constitute an offer or contract. We have not tested any services or appliances (including central heating if fitted) referred to in these particulars and the purchasers are advised to satisfy themselves as to the working order and condition. If a property is unoccupied at any time there may be reconnection charges for any switched off/disconnected or drained services or appliances - All measurements are approximate. If you are thinking of selling your home or just curious to discover the value of your property, Hunters would be pleased to provide free, no obligation sales and marketing advice. Even if your home is outside the area covered by our local offices we can arrange a Market Appraisal through our national network of Hunters estate agents.







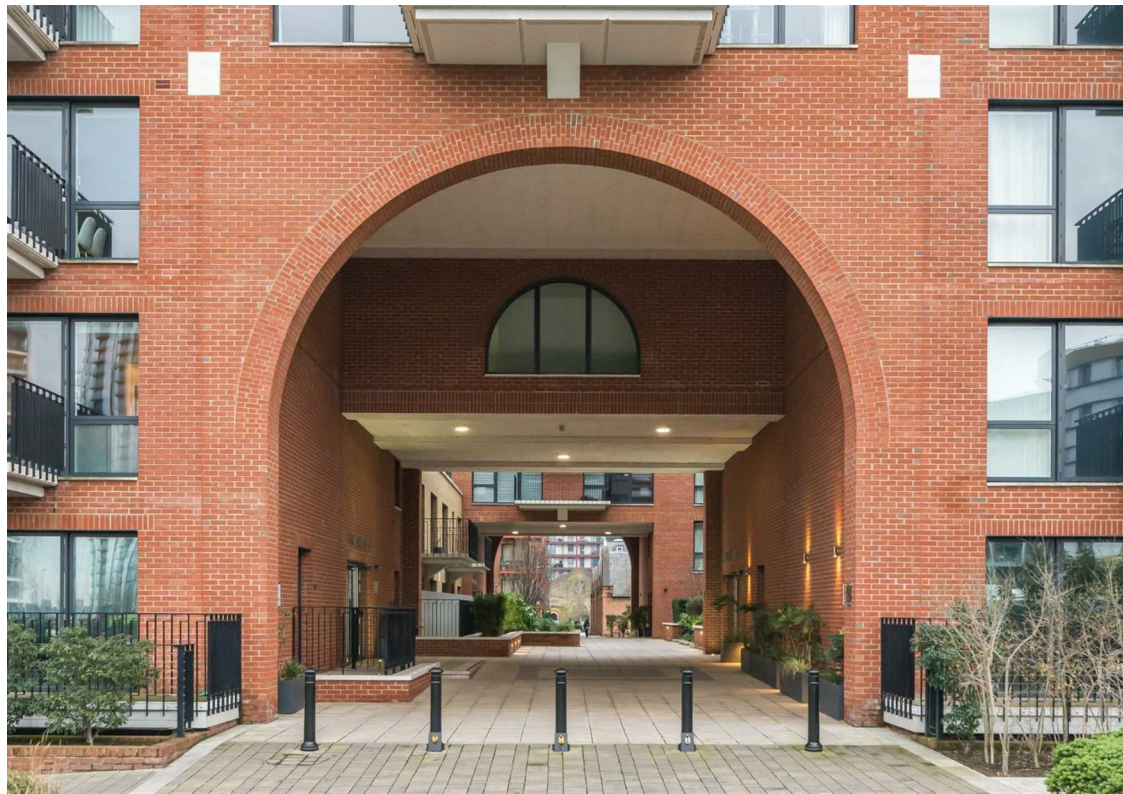





WODEREN WY  
TODOR HOUSE  
15A HOUSE  
15B HOUSE  
15C HOUSE