



1 Woodleigh Fore Street
Redruth, TR16 5QS







1 Woodleigh Fore Street Redruth, TR16 5QS

Situated in the charming village of Carharrack, this immaculate end of terrace cottage offers a delightful blend of modern comfort and character. With two bedrooms, this property is perfect for a first time buyer or investor. As you step inside, you will be greeted by a beautifully presented interior that boasts an abundance of natural light, creating a warm and inviting atmosphere throughout. The layout is thoughtfully designed, with a first floor bathroom that adds convenience to daily living. The kitchen/dining room offers a great space with patio doors leading out to the garden. The cottage features parking at the front, ensuring ease of access, while the rear garden is a true gem. This enclosed, low-maintenance outdoor space is ideal for enjoying the fresh air or entertaining guests, and it benefits from side gated access for added practicality.



The Mather Partnership, Offices in Helston & Hayle

Tel: 01326 565016 | hello@thematherpartnership.co.uk | www.thematherpartnership.co.uk

Guide Price - £210,000

Location

Carharrack is a village located mid Cornwall, growing in popularity and for good reason. The village enjoys a well stocked convenience store and a strong community. A super central location from which can be accessed stunning beaches on both the North and the South Coasts as well as the nearby mining trails perfect for walking and cycling. The A30 is also within easy reach as well as a selection of major towns such as Truro, Redruth, Camborne, Falmouth and Helston. There is a village church and Methodist Chapel , A Chinese takeaway village hall and popular sports and social club with associated football ground. There are a number of mining trails that cross the village and make splendid cycle ways or dog walking , spanning from Devoran to Portreath

Accommodation

Sitting Room
Kitchen/Dining Room
First Floor Landing
Bathroom
Bedroom One
Bedroom Two

Parking

At the front of the property.

Outside

At the rear of the property is a low maintenance garden which is enclosed and has gated side access.





Energy Efficiency Rating		Environmental Impact (CO ₂) Rating	
	Current	Potential	
<p><i>Very energy efficient - lower running costs</i></p> <p>(92 plus) A</p> <p>(81-91) B</p> <p>(69-80) C</p> <p>(55-68) D</p> <p>(39-54) E</p> <p>(21-38) F</p> <p>(1-20) G</p> <p><i>Not energy efficient - higher running costs</i></p>		<p>100+</p> <p>61</p>	<p><i>Very environmentally friendly - lower CO₂ emissions</i></p> <p>(92 plus) A</p> <p>(81-91) B</p> <p>(69-80) C</p> <p>(55-68) D</p> <p>(39-54) E</p> <p>(21-38) F</p> <p>(1-20) G</p> <p><i>Not environmentally friendly - higher CO₂ emissions</i></p>
England & Wales		England & Wales	
EU Directive 2002/91/EC		EU Directive 2002/91/EC	

Services

Mains water, drainage and electricity. LPG Bottled Gas.

Council Tax Band- B

What3Words

Anti Money Laundering Regulations – Purchasers

It is a legal requirement that we receive verified ID from all buyers before a sale can be instructed. We will inform you of the process once your offer has been accepted.

Proof of Finances

Before agreeing a sale, we will require proof of your financial ability to purchase. We will inform you of what we require prior to agreeing a sale.

Broadband & Mobile Phone Coverage

To check the broadband coverage for this property please visit <https://www.openreach.com/fibre-broadband>. To check mobile phone coverage please visit <https://checker.ofcom.org.uk/>



Approximate Area = 625 sq ft / 58 sq m

For identification only - Not to scale

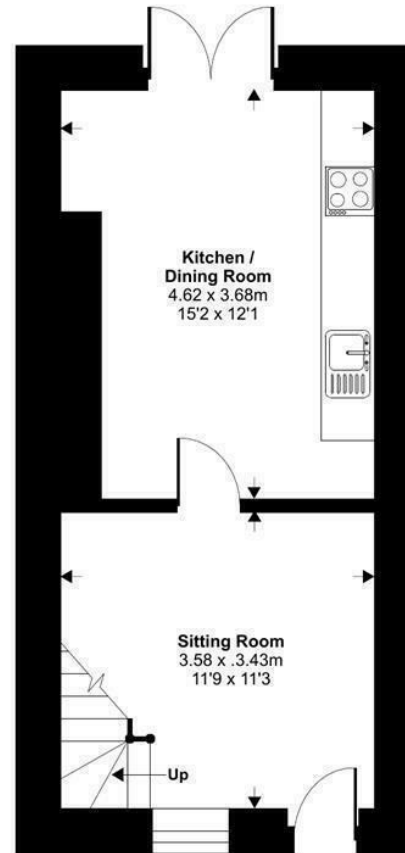
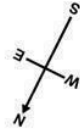

Ground Floor

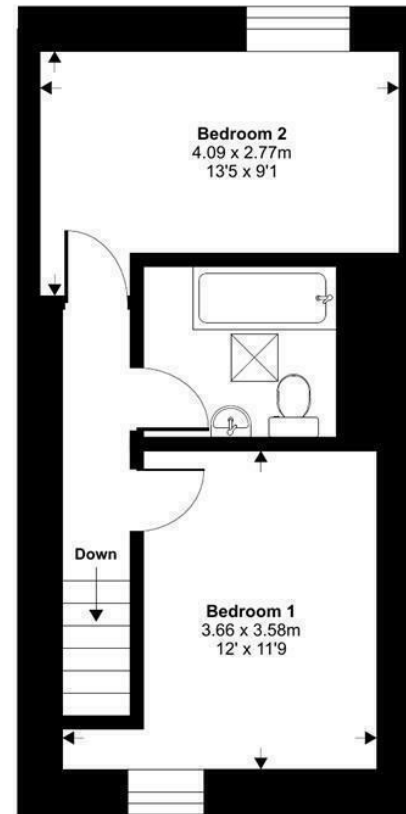

First Floor



Floor plan produced in accordance with RICS Property Measurement Standards incorporating International Property Measurement Standards (IPMS2 Residential). © nichecom 2022.
Produced for Stags. REF: 871094

The Mather Partnership advises that whilst we endeavour to ensure that our sales particulars are accurate and they are produced in good faith, they are produced as a general guide only and do not constitute any part of a contract. If there is any aspect of particular importance to you, please contact the office and we will be pleased to check the position for you, especially if you are contemplating travelling some distance to view the property. No person in the employment of this company has any authority to give any representation of warranty in relation to the property. Please note that none of the services, appliances, heating, plumbing or electrical installations have been tested by the selling agent. Also, if double glazing has been mentioned, the purchaser is strongly advised to satisfy themselves as to the amount of double glazed units in the property.

