



2 Stamford House

Hill Street, Hinckley, LE10 1DS

Offers In The Region Of £120,000



A fully modernised, first floor, 2 bedroom spacious and well appointed apartment, situated in a 2 storey block totalling four units and ideally located within walking distance of Hinckley town centre and all local amenities.

The property has been maintained to a high standard throughout. Additional benefits of night storage heating, PVCu double glazing, modern bathroom with shower, fitted kitchen, lounge/dining room and security intercom.

The property is accessible for commuting to all major road links, such as the M69, M1, M6 and A5.

Viewing essential.

NO CHAIN.



Profiles Estate Agents



Profiles Estate Agents



Profiles Estate Agents

Communal ground floor entrance.

Ground floor entrance leading to a first floor apartment.

Reception hall. 15'1" (max) x 8'2" (max) (4.61 (max) x 2.49 (max))

Airing cupboard, security intercom and smoke alarm.

Bedroom 1 (side). 13'0" x 9'5" (3.97 x 2.89)

PVCu double glazed window and night storage heater.

Bedroom 2 (side) 12'0" (max) x 9'5" (max) (3.67 (max) x 2.89 (max))

Twin PVCu double glazed windows and night storage radiator.

Modern bathroom (side). 9'0" (max) x 6'7" (max) (2.76 (max) x 2.02 (max))

Full suite in white, panel bath with a chrome mixer shower and side screen, wash hand basin, low flush wc, extractor fan, heated towel rail, ceramic wall tiling and fluorescent strip light/shaver point.

Attractive lounge/dining room with integral modern 19'5" (max) x 18'7" (max) (5.92 (max) x 5.68 (max))

PVCu double glazed windows, night storage heater and coving.

Integral modern fitted kitchen (front). 9'10" x 8'0" (3.00 x 2.45)

Stainless steel unit, range of base and wall units (7 base and 2 wall), associated work surfaces, split level ceramic hob, electric (fan assisted) oven, extractor hood, plumbing for a washing machine and ceramic wall tiling.

Area Map



Floor Plans

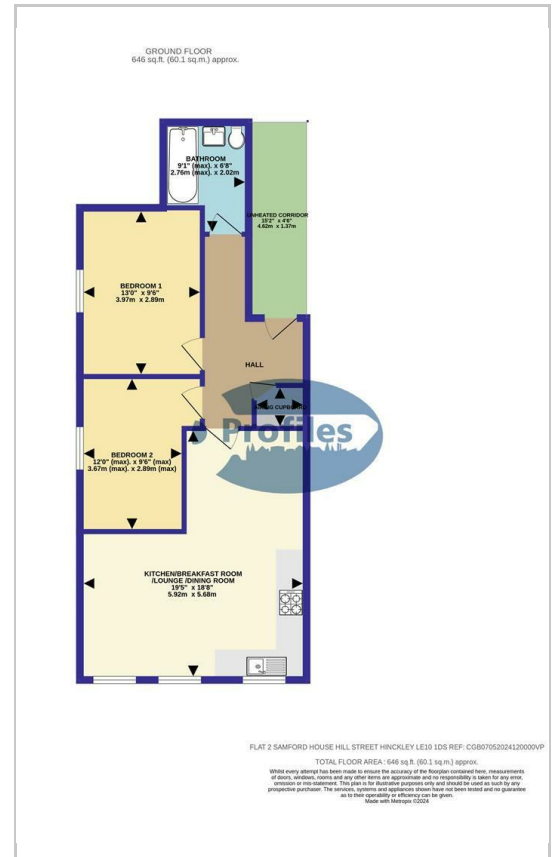

Energy Efficiency Graph

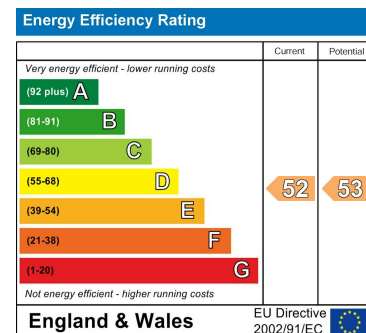

These particulars, whilst believed to be accurate are set out as a general outline only for guidance and do not constitute any part of an offer or contract. Intending purchasers should not rely on them as statements of representation of fact, but must satisfy themselves by inspection or otherwise as to their accuracy. No person in this firm's employment has the authority to make or give any representation or warranty in respect of the property.

28-30 New Buildings, Hinckley, Leicestershire, LE10 1HW

Tel: 01455 613555 Email: profilesea@aol.com <https://www.profiles-estates.co.uk>