

HUNTERS®

HERE TO GET *you* THERE

2 Bateman Drive, Sutton Coldfield, B73 5NY

£445,000

Property Images



HUNTERS®

HERE TO GET *you* THERE

Property Images



Property Images



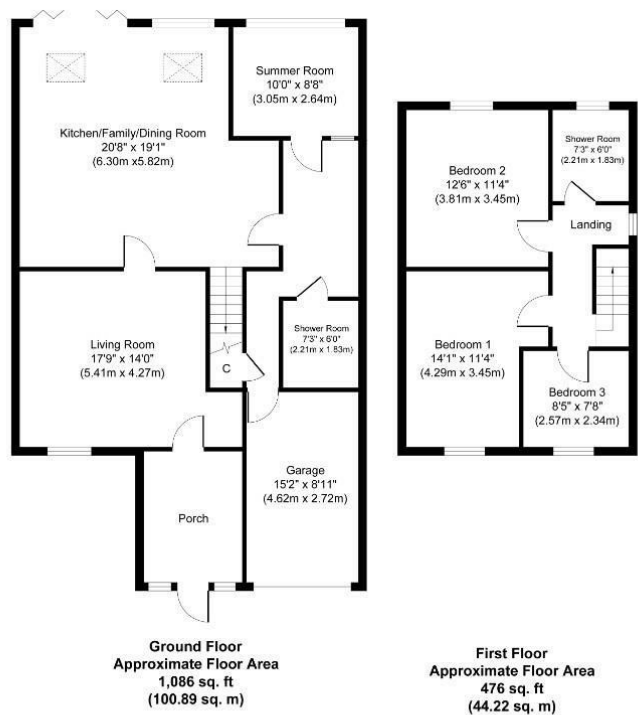

Whilst every attempt has been made to ensure the accuracy of the floor plan contained here, measurements of doors, windows, rooms and any other items are approximate and no responsibility is taken for any error, omission, or mis-statement. The measurements should not be relied upon for valuation, transaction and/or funding purposes. This plan is for illustrative purposes only and should be used as such by any prospective purchaser or tenant. The services, systems and appliances shown have not been tested and no guarantee as to their operability or efficiency can be given.

EPC

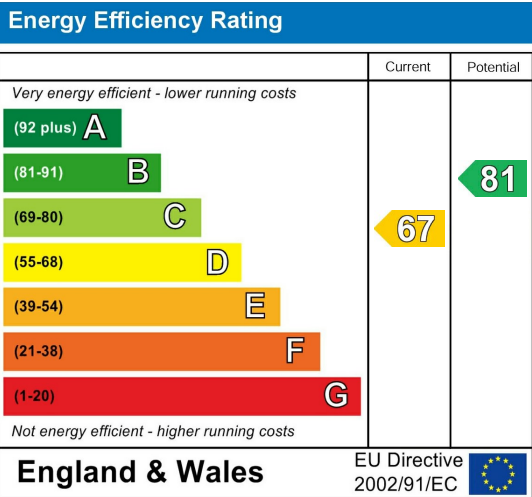

Map



Summary

Beautifully located at the head of this peaceful and sought after cul de sac, just off Vesey Road, this deceptively spacious, freehold linked detached, extended family home really must be seen. Offered with no upward chain and conveniently located for Sutton Coldfield, Boldmere, Wylde Green railway stations, as well as Sutton Park, the gas centrally heated and double glazed accommodation briefly comprises;

Enclosed porch, kitchen/family/dining room having a comprehensive range of refitted units, incorporating double oven, microwave, fridge freezer, gas hob, extractor, quartz work surfaces, roof lights and bi-fold doors to garden. Utility with doors to garage, cupboard store and shower room having white suite and rooflight. First floor, three excellent bedrooms and wet room with refitted white suite.

Outside, front garden with wide block paved driveway, garage having gas central heating boiler and pleasant, private, easily managed rear garden.

Features

- Fabulous extended linked detached • Three bedrooms • Two bathrooms • Outstanding kitchen/family/dining room • Living room • Summer room and utility • Sought after peaceful cul de sac • No upward chain • Viewing essential • Council Tax band E