

# HUNTERS<sup>®</sup>

HERE TO GET *you* THERE



## Padstow

Amington, Tamworth, B77 3QN

Asking Price £379,000

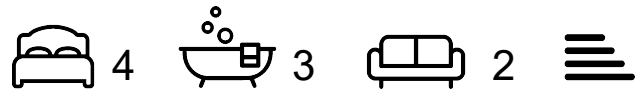

Council Tax: E



# 6 Padstow

Amington, Tamworth, B77 3QN

Asking Price £379,000



## Living room

17'3" x 11'8" (5.26m x 3.56m)

carpeted, double glazed bay window to front, power points, radiator

## Dining room

10' x 9'9" (3.05m x 2.97m)

wood effect laminate flooring, double doors to conservatory, power points, radiator

## Kitchen

10' x 10' (3.05m x 3.05m)

a range of wall and base units, range oven, wood effect laminate flooring, double glazed window to rear, radiator, Belfast sink, integrated microwave

## Utility

Power points, Belfast sink, plumbing for washing machine, dishwasher, splashback, door to side and a range of wall and base units.

## Conservatory

11'6" x 10'2" (3.51m x 3.10m)

ceramic tiled flooring, doors to garden, ceiling light with fan

## Garage

17' x 8' (5.18m x 2.44m)

up and over door, power points, lighting

## Master Bedroom

15' x 11' 9" (4.57m x 3.35m 2.74m)

wood effect laminate flooring, double glazed window to front, built in wardrobe, power points, radiator

## En-Suite

7'8" x 4' (2.34m x 1.22m)

wood effect laminate flooring, low flush WC, sink, heated towel rail, walk in shower, part tiled walls

## Bedroom 2

14' x 8' (4.27m x 2.44m)

carpeted, double glazed window to front, power points, built in wardrobe

## Bedroom 3

10'2" x 9'7" (3.10m x 2.92m)

carpeted, double glazed window to rear, built in wardrobe, radiator, power point

## Bedroom 4

8' x 7' (2.44m x 2.13m)

carpeted, double glazed window to rear, power point, radiator

## Bathroom

6'9" x 5'5" (2.06m x 1.65m)

Tiled flooring with matching bath panel, Bath with electric shower overhead, sink, low flush WC, double glazed window to rear, part tiled walls



## Road Map

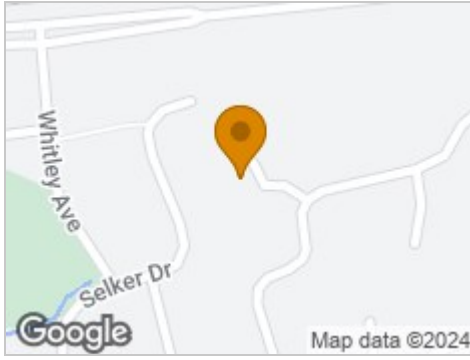

## Hybrid Map



## Terrain Map



## Floor Plan

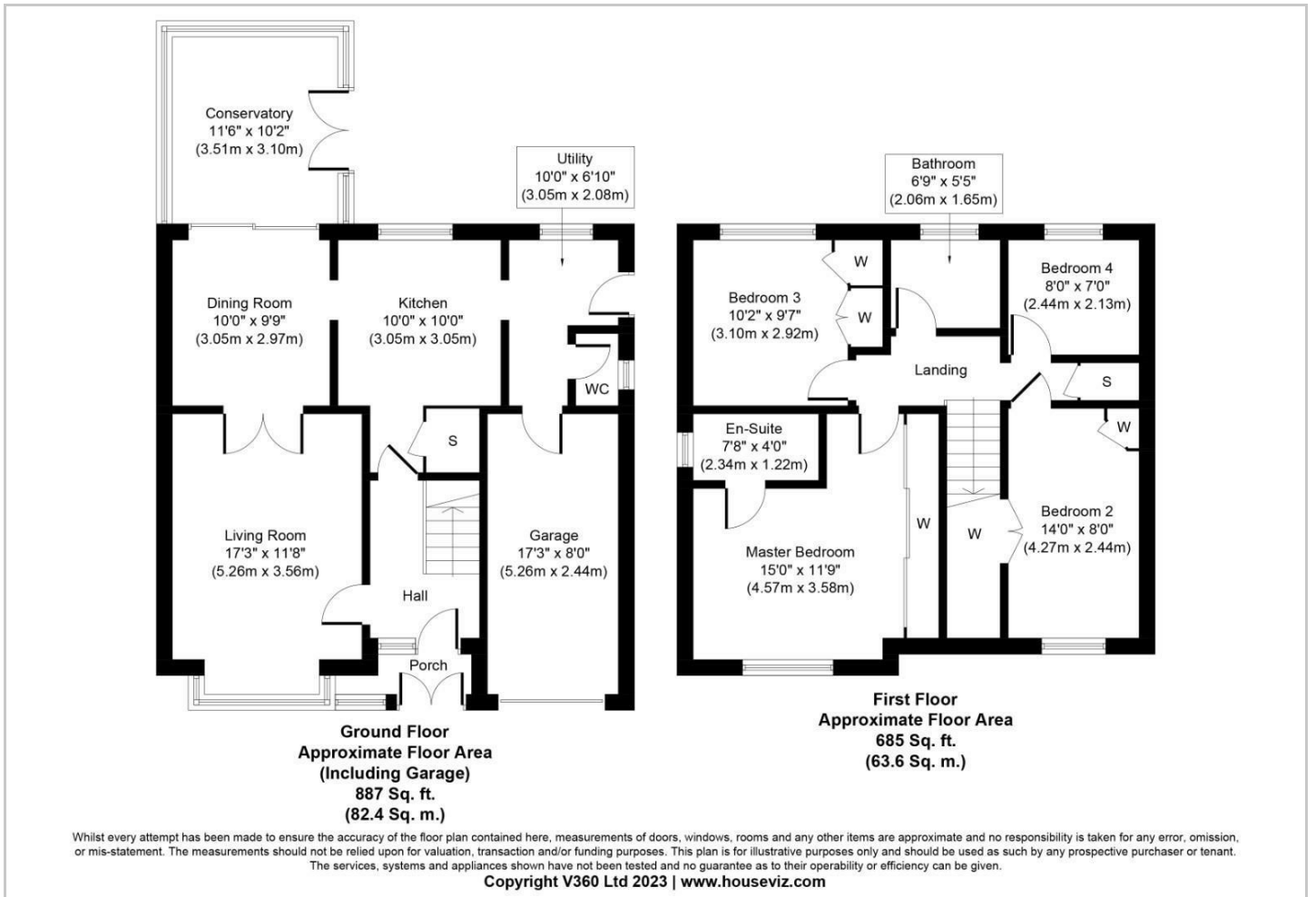

## Viewing

Please contact our Hunters Tamworth Office on 01827 66277 if you wish to arrange a viewing appointment for this property or require further information.

## Energy Efficiency Graph

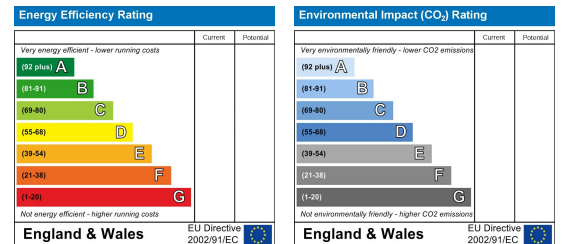

These particulars are intended to give a fair and reliable description of the property but no responsibility for any inaccuracy or error can be accepted and do not constitute an offer or contract. We have not tested any services or appliances (including central heating if fitted) referred to in these particulars and the purchasers are advised to satisfy themselves as to the working order and condition. If a property is unoccupied at any time there may be reconnection charges for any switched off/disconnected or drained services or appliances - All measurements are approximate. **THINKING OF SELLING?** If you are thinking of selling your home or just curious to discover the value of your property, Hunters would be pleased to provide free, no obligation sales and marketing advice. Even if your home is outside the area covered by our local offices we can arrange a Market Appraisal through our national network of Hunters estate agents.