



Kingfisher Close

East Hunsbury, Northampton

oriordanbond
SALES & LETTINGS



Kingfisher Close

East Hunsbury
NN4 0QT

Price
£429,995

Offered to the market with no onward chain is this well presented four double bedroom detached family home, situated in a cul-de-sac, within the popular area of East Hunsbury. This property provides generous accommodation over two floors.

Entrance hall, cloakroom/WC, 22' sitting room with conservatory off, separate dining room, kitchen/breakfast room and utility room. To the first floor are four double bedrooms and a four-piece family bathroom. There are fitted wardrobes to three bedrooms and an ensuite to the master bedroom. Outside, to the front is a lawned garden and double width driveway leading to a double garage. To the rear is a westerly facing garden being mainly laid to lawn with mature planted borders and timber fencing to enclose. Further benefits include uPVC double glazing and gas radiator heating. (B/1386/M)

- Four double bedroom detached home
- En-suite to master bedroom
- Two reception rooms and conservatory
- Gas radiator heating
- Westerly facing rear garden
- Driveway and double garage





GROUND FLOOR
760 sq.ft. (70.6 sq.m.) approx.

1ST FLOOR
626 sq.ft. (58.2 sq.m.) approx.

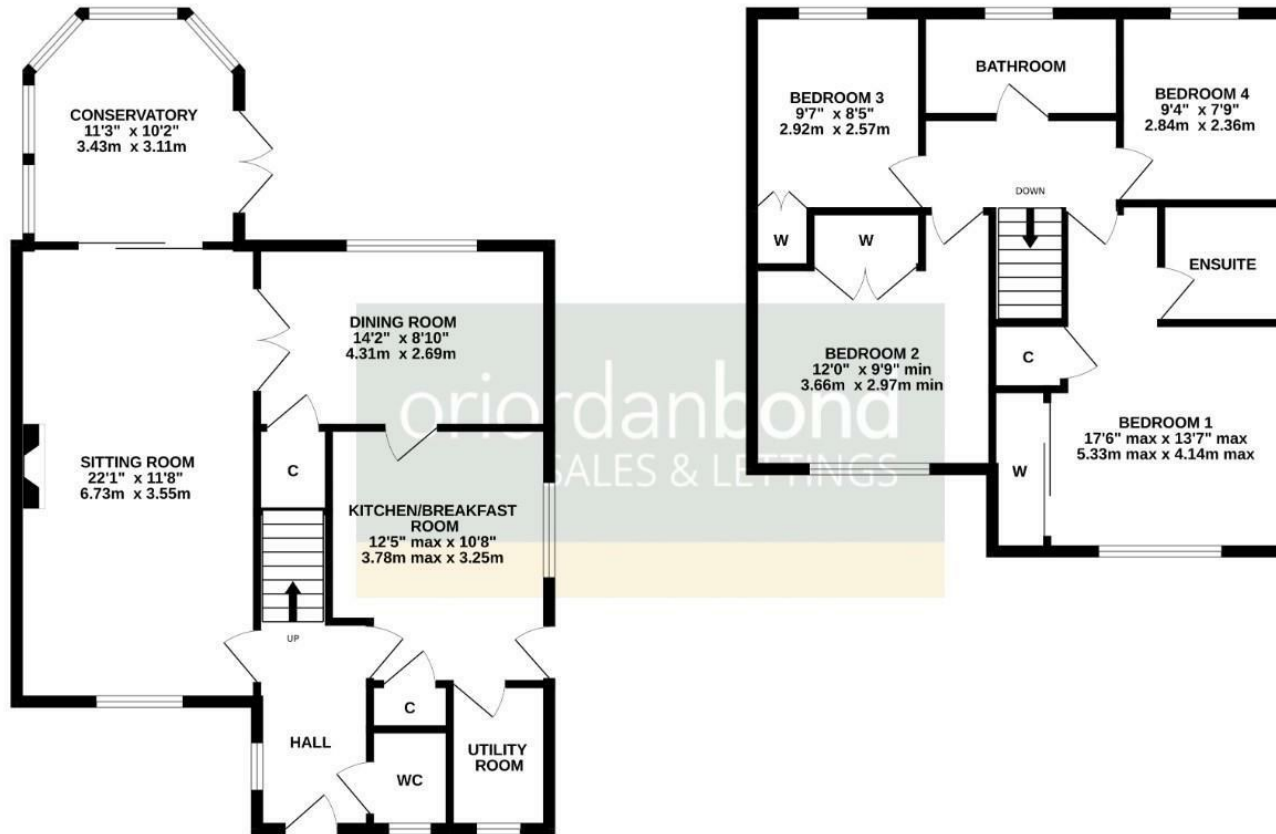

TOTAL FLOOR AREA : 1386 sq.ft. (128.8 sq.m.) approx.

Whilst every attempt has been made to ensure the accuracy of the floorplan contained here, measurements of doors, windows, rooms and any other items are approximate and no responsibility is taken for any error, omission or mis-statement. This plan is for illustrative purposes only and should be used as such by any prospective purchaser. The services, systems and appliances shown have not been tested and no guarantee as to their operability or efficiency can be given.
Made with Metropix ©2024

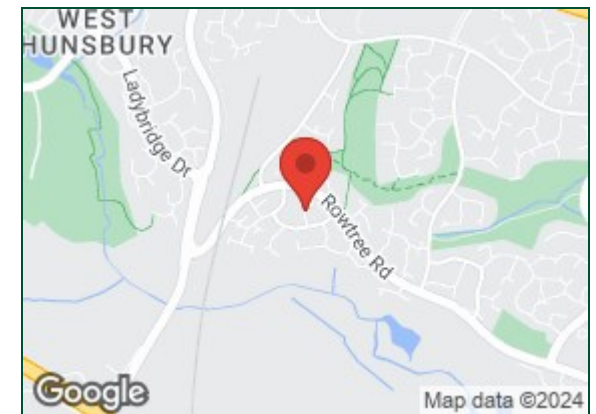

Additional information

- Council Tax Band: E
- Energy Efficiency Rating: C

Viewing

Viewing strictly by appointment – details below

Disclaimer

O'Riordan Bond Estate Agents Limited has not tested apparatus, equipment, fittings or services and so cannot verify they are in working order. The buyer is advised to obtain verification from their solicitor or surveyor.

O'Riordan Bond Hunsbury Sales

01604 706007

hunsbury@oriordanbond.co.uk

