



Penn Gardens

East Hunsbury, Northampton

oriordanbond
SALES & LETTINGS



Penn Gardens

East Hunsbury
NN4 0QX

Guide Price
£330,000

Offered to the market with no onward chain is this well presented three bedroom detached family home, nestled in a cul-de-sac, within the desirable area of East Hunsbury.

Accommodation comprises entrance hall, re-fitted cloakroom/WC, a generous sitting/dining room with dual aspect windows and patio doors to the rear garden, separate kitchen adjacent fitted with a range of base and well mounted units, work surfaces and spaces for white goods, three good size bedrooms and a re-fitted family bathroom. The master bedroom also provides fitted wardrobes and a re-fitted en-suite with a remote controlled Aqualisa shower. Outside, to the front is a driveway for two cars leading to a single garage with up and over door and a window and courtesy rear door. The rear garden is extremely private and backs onto woodland, has a patio seating area, lawn and timber fencing to enclose with gated side access. Further benefits include uPVC double glazing and gas radiator heating. (B/808/M)

- Three bedroom detached family home
- Re-fitted en-suite to master bedroom
- Re-fitted family bathroom
- Private rear garden backing onto woodland
- Driveway and garage
- No onward chain

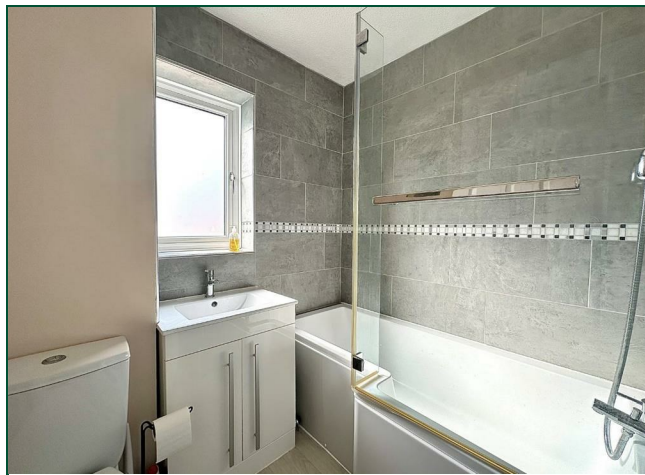



GROUND FLOOR
548 sq.ft. (50.9 sq.m.) approx.



1ST FLOOR
398 sq.ft. (37.0 sq.m.) approx.

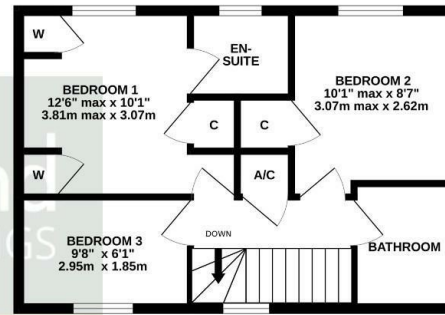

TOTAL FLOOR AREA : 946 sq.ft. (87.9 sq.m.) approx.

Whilst every attempt has been made to ensure the accuracy of the floorplan contained here, measurements of doors, windows, rooms and any other items are approximate and no responsibility is taken for any error, omission or mis-statement. This plan is for illustrative purposes only and should be used as such by any prospective purchaser. The services, systems and appliances shown have not been tested and no guarantee as to their operability or efficiency can be given.
Made with Metropix ©2024

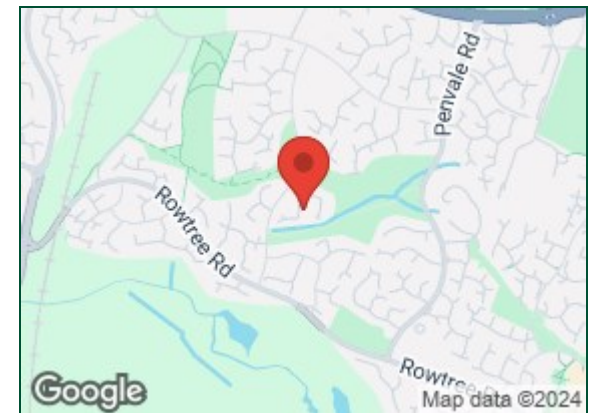

Additional information

- Council Tax Band: C
- Energy Efficiency Rating: D

Viewing

Viewing strictly by appointment – details below

Disclaimer

O'Riordan Bond Estate Agents Limited has not tested apparatus, equipment, fittings or services and so cannot verify they are in working order. The buyer is advised to obtain verification from their solicitor or surveyor.

O'Riordan Bond Hunsbury Sales

01604 706007

hunsbury@oriordanbond.co.uk

