



Claregate
East Hunsbury, Northampton

oriordanbond
SALES & LETTINGS



GROUND FLOOR
309 sq.ft. (28.7 sq.m.) approx.

1ST FLOOR
309 sq.ft. (28.7 sq.m.) approx.

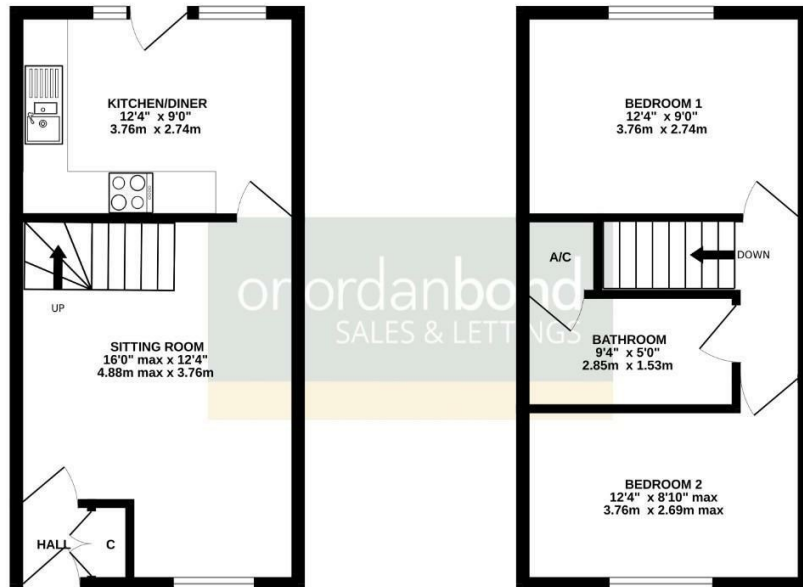

TOTAL FLOOR AREA : 618 sq.ft. (57.4 sq.m.) approx.

Whilst every attempt has been made to ensure the accuracy of the floorplan contained here, measurements of doors, windows, rooms and any other items are approximate and no responsibility is taken for any error, omission or mis-statement. This plan is for illustrative purposes only and should be used as such by any prospective purchaser. The services, systems and appliances shown have not been tested and no guarantee as to their operability or efficiency can be given.
Made with Metrepack (2024)

Claregate

East Hunsbury
NN4 0QZ

GUIDE PRICE £220,000

A well presented two double bedroom terraced home, situated in a cul-de-sac, within the popular area of East Hunsbury, benefitting from no onward chain. This property offers accommodation over two floors.

Entrance hall with cloaks cupboard and a further door to a good size sitting room with ample space for furniture, stairs to the first floor and a door to a modern fitted kitchen/dining room with integrated appliances and access to the rear garden. To the first floor is access to the loft space, two double bedrooms and a modern bathroom with a shower over the bath. Outside, to the front is a lawned garden with a pathway and a gravelled driveway for two to three cars. The rear garden is westerly facing, has a paved patio leading to a lawn with timber fencing to enclose. (B/618/S)

Additional information

- Council Tax Band: B
- Energy Efficiency Rating: D

Viewing

Viewing strictly by appointment – details below

Disclaimer

O’Riordan Bond Estate Agents Limited has not tested apparatus, equipment, fittings or services and so cannot verify they are in working order. The buyer is advised to obtain verification from their solicitor or surveyor.

O’Riordan Bond Hunsbury Sales
01604 706007

hunsbury@oriordanbond.co.uk

