



Riverstone Way

Hunsbury Meadows, Northampton

oriordanbond
SALES & LETTINGS



Riverstone Way

Hunsbury Meadows
NN4 9QH

Price
£429,995

A beautifully presented four bedroom detached family home, situated on a private driveway with three similar properties, in the desirable area of Hunsbury Meadows. This property has been extended and maintained to a high standard and offers generous accommodation over two floors.

Entrance hall with storage cupboards, re-fitted cloakroom/WC, a light and airy sitting room, separate dining room and an amazing, re-fitted kitchen/breakfast room with integrated appliances, patio doors to the garden and a utility room off. To the first floor are four good size bedrooms all with fitted wardrobes, a contemporary, re-fitted family bathroom with 'rain head' shower over the bath and a re-fitted en-suite to the main bedroom. Outside, to the front is a driveway for three cars leading to an integral garage, To the rear is a landscaped garden with patio, lawn, timber decking, a summerhouse and timber fencing to enclose. Further benefits include uPVC double glazing and gas radiator heating. (A/1454/M)

- Beautifully presented four bedroom detached home
- Re-fitted en-suite to master bedroom
- Two reception rooms
- Re-fitted kitchen/breakfast room with utility room
- Landscaped rear garden
- Driveway and integral garage





GROUND FLOOR
813 sq.ft. (75.5 sq.m.) approx.

1ST FLOOR
642 sq.ft. (59.6 sq.m.) approx.

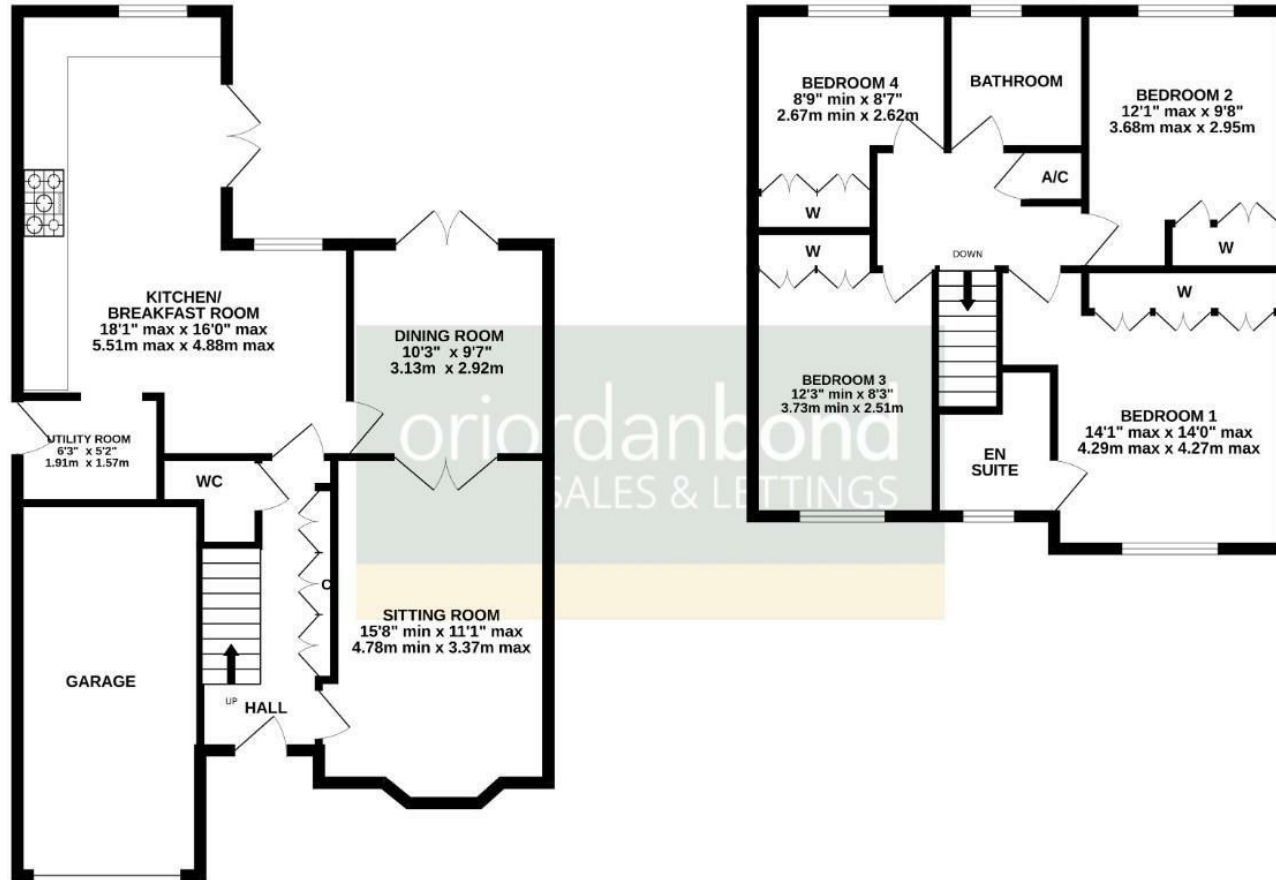

TOTAL FLOOR AREA : 1454 sq.ft. (135.1 sq.m.) approx.

Whilst every attempt has been made to ensure the accuracy of the floorplan contained here, measurements of doors, windows, rooms and any other items are approximate and no responsibility is taken for any error, omission or mis-statement. This plan is for illustrative purposes only and should be used as such by any prospective purchaser. The services, systems and appliances shown have not been tested and no guarantee as to their operability or efficiency can be given.
Made with Metropix ©2024



Additional information

- Council Tax Band: E
- Energy Efficiency Rating: C

Viewing

Viewing strictly by appointment – details below

Disclaimer

O’Riordan Bond Estate Agents Limited has not tested apparatus, equipment, fittings or services and so cannot verify they are in working order. The buyer is advised to obtain verification from their solicitor or surveyor.

O’Riordan Bond Hunsbury Sales

01604 706007

hunsbury@oriordanbond.co.uk

