



Mayfly Road
Pineham Village, Northampton

oriordanbond
SALES & LETTINGS



Mayfly Road

Pineham Village

NN4 9EQ

PRICE £313,995

A well presented three storey three bedroom semi-detached home, situated in the popular area of Pineham Village, offered for sale with no onward chain. This property offers generous accommodation over three floors of over 1,100 square feet.

Entrance hall, kitchen/dining room with integrated appliances and sitting room with patio doors to the rear garden. To the first floor you will find stairs to the second floor, two bedrooms and a family bathroom. The master bedroom spans the top floor of the property and offers dual aspect windows and an en-suite. Outside, to the front is a block paved forecourt and brick wall with part block paved driveway leading to a single garage. The rear garden is mainly laid to lawn, has a patio area and timber fencing to enclose. Further benefits include uPVC double glazing and gas radiator heating. (A/1142/S)

Additional information

- Council Tax Band: D
- Energy Efficiency Rating: B

Viewing

Viewing strictly by appointment – details below

Disclaimer

O’Riordan Bond Estate Agents Limited has not tested apparatus, equipment, fittings or services and so cannot verify they are in working order. The buyer is advised to obtain verification from their solicitor or surveyor.

O’Riordan Bond Hunsbury Sales

01604 706007

hunsbury@oriordanbond.co.uk



GROUND FLOOR
413 sq.ft. (38.4 sq.m.) approx.

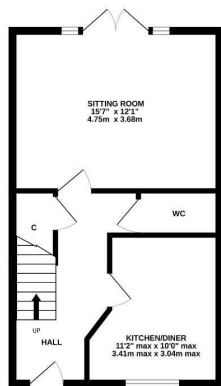

1ST FLOOR
413 sq.ft. (38.4 sq.m.) approx.



2ND FLOOR
315 sq.ft. (29.3 sq.m.) approx.

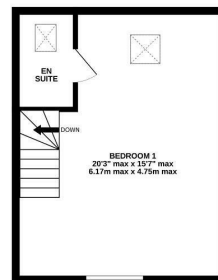

TOTAL FLOOR AREA : 1142 sq.ft. (106.1 sq.m.) approx.

Whilst every attempt has been made to ensure the accuracy of the floorplan contained here, measurements of doors, windows, rooms and any other items are approximate and no responsibility is taken for any error, omission or mis-statement. This plan is for illustrative purposes only and should be used as such by any prospective purchaser. The services, systems and appliances shown have not been tested and no guarantee as to their operability or efficiency can be given.
Made with Metropix i3024