



St. Lukes Court, Hatfield

£1,450 pcm

FIRST FLOOR APARTMENT • TWO DOUBLE BEDROOMS • SPACIOUS LIVING ROOM • KITCHEN WITH APPLIANCES • MODERN BATHROOM • ALLOCATED PARKING BAY • CLOSE TO STATION • UNFURNISHED • AVAILABLE JANUARY • EPC RATING - C

KINGS

Sales Lettings Management

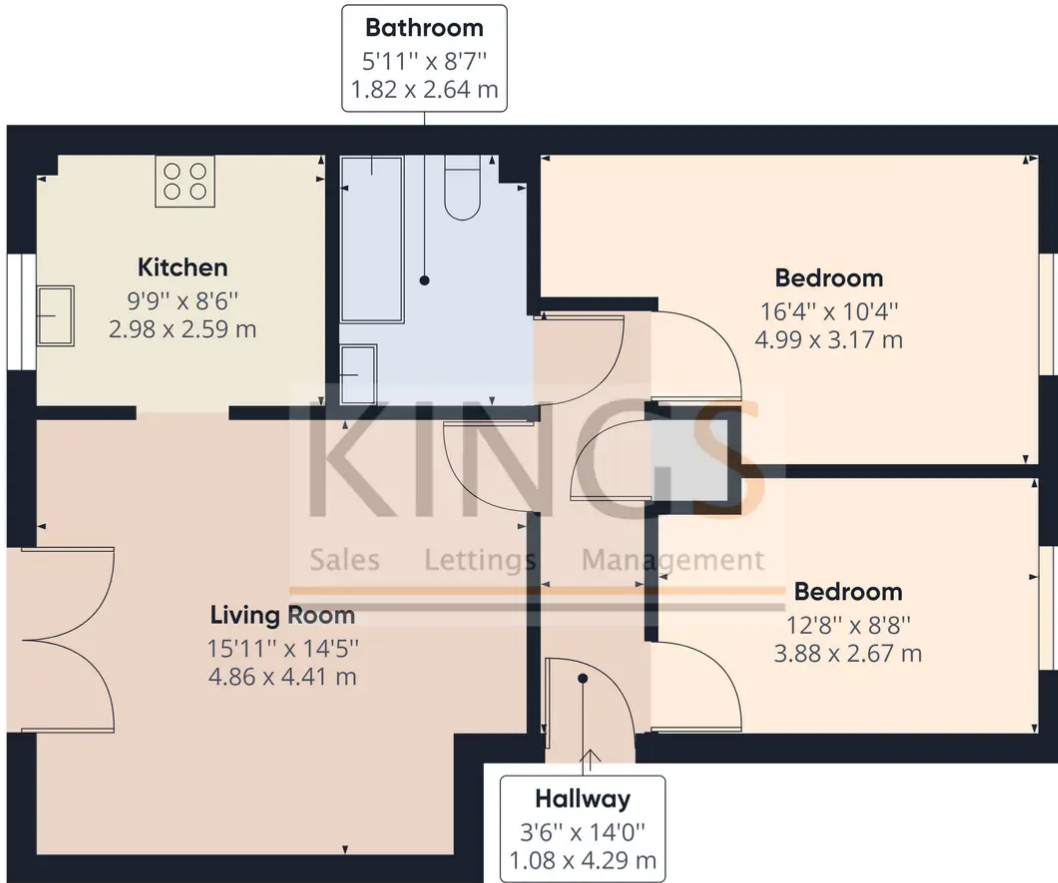

Approximate total area⁽¹⁾
683.83 ft²
63.53 m²

(1) Excluding balconies and terraces

While every attempt has been made to ensure accuracy, all measurements are approximate, not to scale. This floor plan is for illustrative purposes only.

GIRAFFE360