

Tattershall Drive

The Park
Nottingham
NG7 1AD

Guide Price £529,000



Click for further information:-



Location



Gallery



Video



Contact



0115 841 1155



- Delightful semi-detached home in the iconic Park Estate
- Front Terrace with a partial side view towards Nottingham Castle
- Bright open-plan lounge/dining room with French style doors to the rear terrace garden
- Three first-floor bedrooms, perfect for families or professionals
- Modern bathroom with separate bath & shower
- Low-maintenance Garden with terrace & rockery landscaping
- Double garage with electronic up-and-over door
- Within easy reach of tennis courts, city centre & train station
- EPC Band C / Council Tax Band E
- Freehold - Over 1,700 sq ft including the double garage



0115 841 1155



Location



Gallery



Video



Contact

Tattershall Drive, [The Park, Nottingham, NG7 1AD](#)

Key Features

Nestled on an elevated plot within the prestigious Park Estate, one of Nottingham's most exclusive residential locations lies this elegant semi-detached home, offering refined city living with a touch of heritage charm.

Just a short stroll from both the LTA and Park tennis courts, the home enjoys summer leafy surroundings and a partial view of Nottingham Castle from the front terrace.

Behind its private entrance, the layout unfolds over two floors with thoughtfully arranged, light-filled living spaces.

The open-plan lounge and dining room is ideal for both relaxed evenings and entertaining, featuring an ornamental fireplace, beautiful flooring, and French style doors that open onto a tranquil rear garden terrace.

The modern fitted kitchen includes integrated appliances and offers direct outdoor access.

Upstairs, three comfortable bedrooms are served by a modern bathroom with both bath and a separate shower-perfect for family or guests.

Outside, the property features a rear courtyard garden with a terrace and a well-established rockery bed.

In addition, there is double garage with an electric door providing secure off-road parking or additional storage.

With Nottingham's city centre, iconic Castle and train station all within easy reach, this property offers the rare chance to enjoy the privacy and prestige of The Park Estate without compromising on connectivity or convenience.





0115 841 1155



Location



Gallery



Video



Contact

Tattershall Drive, [The Park, Nottingham, NG7 1AD](#)



Lower Ground Floor

Approx. 37.8 sq. metres (406.4 sq. feet)



Ground Floor

Approx. 63.1 sq. metres (679.3 sq. feet)



First Floor

Approx. 59.7 sq. metres (643.1 sq. feet)

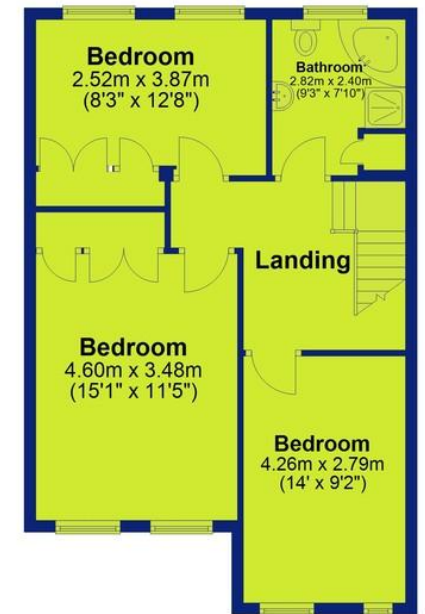

Total area: approx. 160.6 sq. metres (1728.8 sq. feet)



0115 841 1155



Location



Gallery



Video



Contact

Tattershall Drive, [The Park, Nottingham, NG7 1AD](#)



Interested in this home?

Contact the FHP Living Team on 0115 841 1155

23 Bridgford Road
West Bridgford
Nottingham
NG2 6AU

1 Weekday Cross
The Lace Market
Nottingham
NG1 2GB

Score	Energy rating	Current	Potential
92+	A		
81-91	B		81 B
69-80	C	69 C	
55-68	D		
39-54	E		
21-38	F		
1-20	G		

These sales particulars have been prepared by FHP Living on the instruction of the vendor. Services, equipment and fittings mentioned in these particulars have NOT been tested, and as such, no warranties can be given. Prospective purchasers are advised to make their own enquiries regarding such matters. These sales particulars are produced in good faith and are not intended to form part of a contract. Whilst FHP Living have taken care in obtaining internal measurements, they should only be regarded as approximate.

Purchaser information - Under the Protecting Against Money Laundering and the Proceeds of Crime Act 2002, FHP Living require any successful purchasers proceeding with a purchase to provide two forms of identification i.e. passport or photocard driving license and a recent utility bill. This evidence will be required prior to FHP Living instructing solicitors in the purchase or the sale of a property.