

Western Terrace

The Park
Nottingham
NG7 1AF

Guide Price £365,000



Click for further information:-



Location



Gallery



Video



Contact



0115 841 1155



- Stylish and spacious three-bedroom apartment within the prestigious Park Estate
- Generous open plan living and dining area with a large bay window
- Contemporary kitchen with granite worktops, integrated appliances, and casual dining space
- Three well-proportioned bedrooms arranged over two floors
- Principal bedroom with en-suite bathroom and separate walk-in shower
- Additional modern bathroom off the hallway with bath and separate shower
- Just a short walk from Nottingham city centre's shops, restaurants, and cultural venues
- Located in one of Nottingham's most desirable residential areas
- EPC Band E / Council Tax Band F
- Leasehold



0115 841 1155



Location



Gallery



Video



Contact

Western Terrace, [The Park, Nottingham, NG7 1AF](#)

Key Features

FHP Living is delighted to present this stylish and spacious three-bedroom apartment for sale, situated within the prestigious Park Estate-one of Nottingham's most sought-after residential locations.

Steeped in history and character, The Park offers an exclusive and tranquil setting, just a short stroll from Nottingham city centre with its vibrant mix of shops, restaurants, cafes, bars, and cultural attractions.

Accessed via a communal entrance hall, the apartment is located on the first floor and opens into a welcoming, light-filled private hallway, complemented by elegant cornicing and period charm.

The heart of the home is a generous open-plan living space, where a beautifully bright lounge and dining area is enhanced by a stunning bay window that floods the room with natural light-perfect for both relaxation and entertaining. The contemporary kitchen is thoughtfully designed with a modern aesthetic, offering a range of sleek fitted units, granite worktops, integrated appliances, and a casual dining area ideal for everyday living.

The apartment features three well-proportioned bedrooms arranged over two floors, providing both comfort and flexibility. The principal bedroom benefits from a stylish en-suite bathroom complete with a separate walk-in shower. An additional modern bathroom, also featuring a separate shower and bathtub, is conveniently located off the main hallway.





0115 841 1155



Location



Gallery



Video



Contact

Western Terrace, [The Park](#), Nottingham, NG7 1AF



First Floor
Approx. 12.9 sq. metres (139.1 sq. feet)

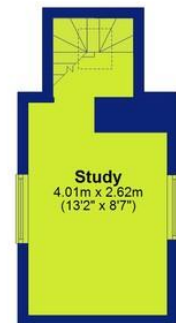

Total area: approx. 140.7 sq. metres (1514.0 sq. feet)



0115 841 1155



Location



Gallery



Video



Contact



Western Terrace, [The Park](#), Nottingham, NG7 1AF



Interested in this home?

Contact the FHP Living Team on 0115 841 1155

23 Bridgford Road
West Bridgford
Nottingham
NG2 6AU

1 Weekday Cross
The Lace Market
Nottingham
NG1 2GB

Score	Energy rating	Current	Potential
92+	A		
81-91	B		
69-80	C		
55-68	D		65 D
39-54	E	52 E	
21-38	F		
1-20	G		

These sales particulars have been prepared by FHP Living on the instruction of the vendor. Services, equipment and fittings mentioned in these particulars have NOT been tested, and as such, no warranties can be given. Prospective purchasers are advised to make their own enquiries regarding such matters. These sales particulars are produced in good faith and are not intended to form part of a contract. Whilst FHP Living have taken care in obtaining internal measurements, they should only be regarded as approximate.

Purchaser information - Under the Protecting Against Money Laundering and the Proceeds of Crime Act 2002, FHP Living require any successful purchasers proceeding with a purchase to provide two forms of identification i.e. passport or photocard driving license and a recent utility bill. This evidence will be required prior to FHP Living instructing solicitors in the purchase or the sale of a property.