

Gladstone Court
Cavendish Crescent South

The Park
Nottingham
NG7 1EN

Guide Price £179,950



Click for further information:-



Location



Gallery



Video



Contact



0115 841 1155



- Beautifully presented one-bedroom apartment in the prestigious Park Estate
- Located on the first floor of an impressive period conversion
- Bright and spacious open-plan living area with a large bay window
- Modern fitted kitchen with integrated appliances and a stylish shower room
- Combines classic architectural features with modern finishes
- Private entrance hallway with built-in storage
- Secure gated parking included for added convenience
- Easy access to bars, restaurants, shops, entertainment venues, and the main train station
- EPC Band E / Council Tax Band A
- Leasehold



0115 841 1155



Location



Gallery



Video



Contact

Cavendish Crescent South, The Park, Nottingham, NG7 1EN

Key Features

FHP Living is pleased to present this beautifully appointed one-bedroom apartment, ideally positioned on the first floor of an impressive period conversion within the prestigious Park Estate.

Combining timeless character with contemporary comfort, this elegant residence benefits from secure gated parking and enjoys an enviable location just moments from Nottingham's vibrant city centre. Residents will appreciate the easy access to a wide selection of bars, restaurants, boutique shops, cultural attractions, and the main train station.

The property is accessed via a grand communal entrance hall, featuring a stunning stained-glass window that sets a refined tone. Inside, a private entrance hallway includes a built-in storage cupboard for added convenience. The spacious, light-filled open-plan living area boasts a charming bay window and flows seamlessly into a modern fitted kitchen, complete with sleek units and integrated appliances. A stylish shower room and a well-proportioned double bedroom complete the accommodation.

Blending period charm with modern convenience in one of Nottingham's most sought-after neighbourhoods, this property offers an exceptional lifestyle opportunity. Early viewing is highly recommended.





0115 841 1155



Location



Gallery



Video



Contact

Cavendish Crescent South, The Park, [Nottingham, NG7 1EN](#)



Total area: approx. 39.4 sq. metres (424.6 sq. feet)

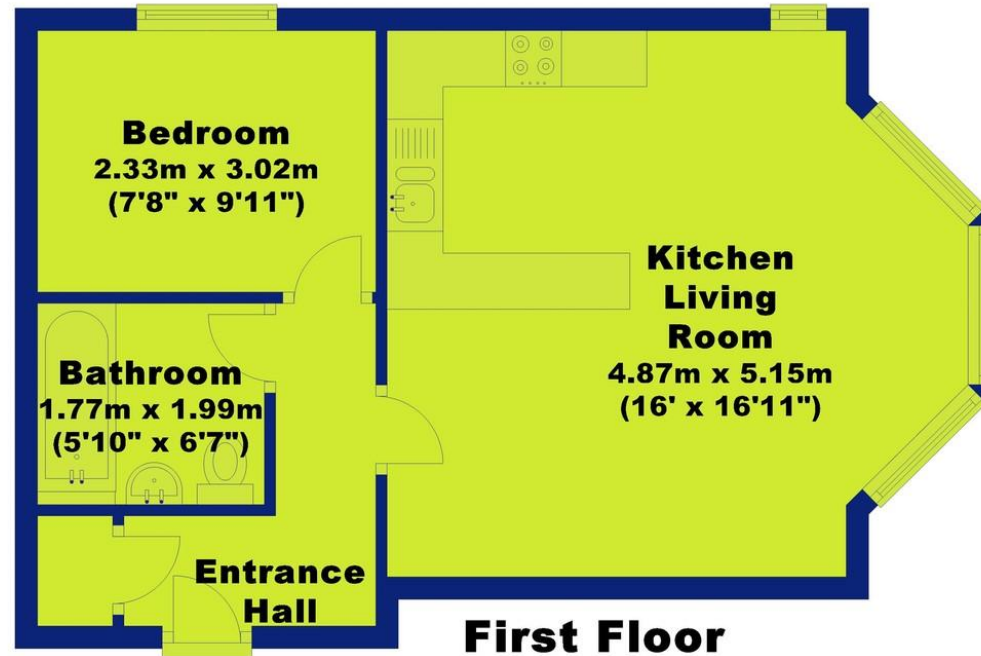



0115 841 1155



Location



Gallery



Video



Contact

Cavendish Crescent South, The Park, Nottingham, NG7 1EN



Interested in this home?

Contact the FHP Living Team on 0115 841 1155

23 Bridgford Road
West Bridgford
Nottingham
NG2 6AU

1 Weekday Cross
The Lace Market
Nottingham
NG1 2GB

Score	Energy rating	Current	Potential
92+	A		
81-91	B		
69-80	C		
55-68	D		68 D
39-54	E	48 E	
21-38	F		
1-20	G		

These sales particulars have been prepared by FHP Living on the instruction of the vendor. Services, equipment and fittings mentioned in these particulars have NOT been tested, and as such, no warranties can be given. Prospective purchasers are advised to make their own enquiries regarding such matters. These sales particulars are produced in good faith and are not intended to form part of a contract. Whilst FHP Living have taken care in obtaining internal measurements, they should only be regarded as approximate.

Purchaser information - Under the Protecting Against Money Laundering and the Proceeds of Crime Act 2002, FHP Living require any successful purchasers proceeding with a purchase to provide two forms of identification i.e. passport or photocard driving license and a recent utility bill. This evidence will be required prior to FHP Living instructing solicitors in the purchase or the sale of a property.