

1203 Litmus Building

Nottingham
NG1 3NZ

Asking Price Of £185,000



Click for further information:-



Location



Gallery



Video



Contact



0115 841 1155



- 2 Bedroom Apartment
- Popular Development
- Central Locations
- Shared Facilities
- Gym & Swimming Pool
- 12th Floor
- Allocated Parking
- Central Location
- Roof Terrace
- Contact FHP Living



0115 841 1155



Location



Gallery



Video



Contact

1203 Litmus Building, [The City, Huntingdon Street, NG1 3NZ](#)



Key Features

Situated in the sought-after Litmus Building, this stylish two-bedroom, two-bathroom apartment offers exceptional city living with unrivalled amenities, including a gym, swimming pool, and concierge service. Perfectly positioned, the property is just a short walk from Nottingham's vibrant city centre, providing easy access to shops, restaurants, and transport links.

The apartment features a spacious open-plan living and dining area, complemented by a modern fitted kitchen with integrated appliances. Both large double bedrooms come with built-in wardrobes, offering plenty of storage, while the sleek bathroom includes both a bath and shower.

One of the standout features of this apartment is the expansive private roof terrace, providing stunning panoramic views across Nottingham-an ideal space for entertaining or unwinding after a long day. The property also benefits from secure allocated parking within the development.

Lease & Financials:

Lease Length: 978 years remaining

Service Charge: £3,286 per annum

Ground Rent: £250 per annum

Huntingdon Street, Nottingham, NG1 3NZ
APPROX. TOTAL GROSS INTERNAL FLOOR AREA 785 SQ FT 86.5 SQ METRES

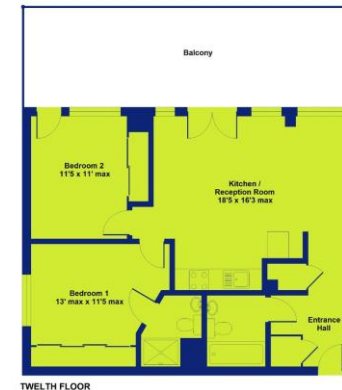

These sales particulars have been prepared by FHP Living on the instruction of the vendor. Services, equipment and fittings mentioned in these particulars have NOT been tested, and as such, no warranties can be given. Prospective purchasers are advised to make their own enquiries regarding such matters. These sales particulars are produced in good faith and are not intended to form part of a contract. Whilst FHP Living have taken care in obtaining internal measurements, they should only be regarded as approximate. Purchaser information - Under the Protecting Against Money Laundering and the Proceeds of Crime Act 2002, FHP Living require any successful purchasers proceeding with a purchase to provide two forms of identification i.e. passport or photocard driving license and a recent utility bill. This evidence will be required prior to FHP Living instructing solicitors in the purchase or the sale of a property. Specifically no guarantee is given as to the accuracy of the information contained in this plan. Any information is for initial guidance only and should not be relied on as a basis of decision.

Copyright fhp.living.co.uk 2012. Produced for FHP - REF: 270002

Interested in this home? Contact the FHP Living Team on 0115 841 1155

23 Bridgford Road
West Bridgford
Nottingham
NG2 6AU

1 Weekday Cross
The Lace Market
Nottingham
NG1 2GB

These sales particulars have been prepared by FHP Living on the instruction of the vendor. Services, equipment and fittings mentioned in these particulars have NOT been tested, and as such, no warranties can be given. Prospective purchasers are advised to make their own enquiries regarding such matters. These sales particulars are produced in good faith and are not intended to form part of a contract. Whilst FHP Living have taken care in obtaining internal measurements, they should only be regarded as approximate. Purchaser information - Under the Protecting Against Money Laundering and the Proceeds of Crime Act 2002, FHP Living require any successful purchasers proceeding with a purchase to provide two forms of identification i.e. passport or photocard driving license and a recent utility bill. This evidence will be required prior to FHP Living instructing solicitors in the purchase or the sale of a property.

Score	Energy rating	Current	Potential
92+	A		
81-91	B		84 B
69-80	C	80 C	
55-68	D		
39-54	E		
21-38	F		
1-20	G		