



## London Road, SE23

### £300,000

This charming one-bedroom flat is located on the second floor of Hamlet House, a modern and well-maintained purpose-built block within a secure, gated development with allocated off-street parking in the heart of Forest Hill.

London Road is situated within walking distance of Forest Hill Station with easy access to frequent London Overground, National Rail, and bus services into Central London and beyond. The property is in a prime location, surrounded by a number of diverse range of local amenities, popular shops, supermarkets, and an endless array of exciting places to eat and drink.

### Features

- One Double Bedroom
- Gated Development
- Allocated Parking
- Long Lease
- Prime Location
- Excellent Transport Links

# London Road, London, SE23

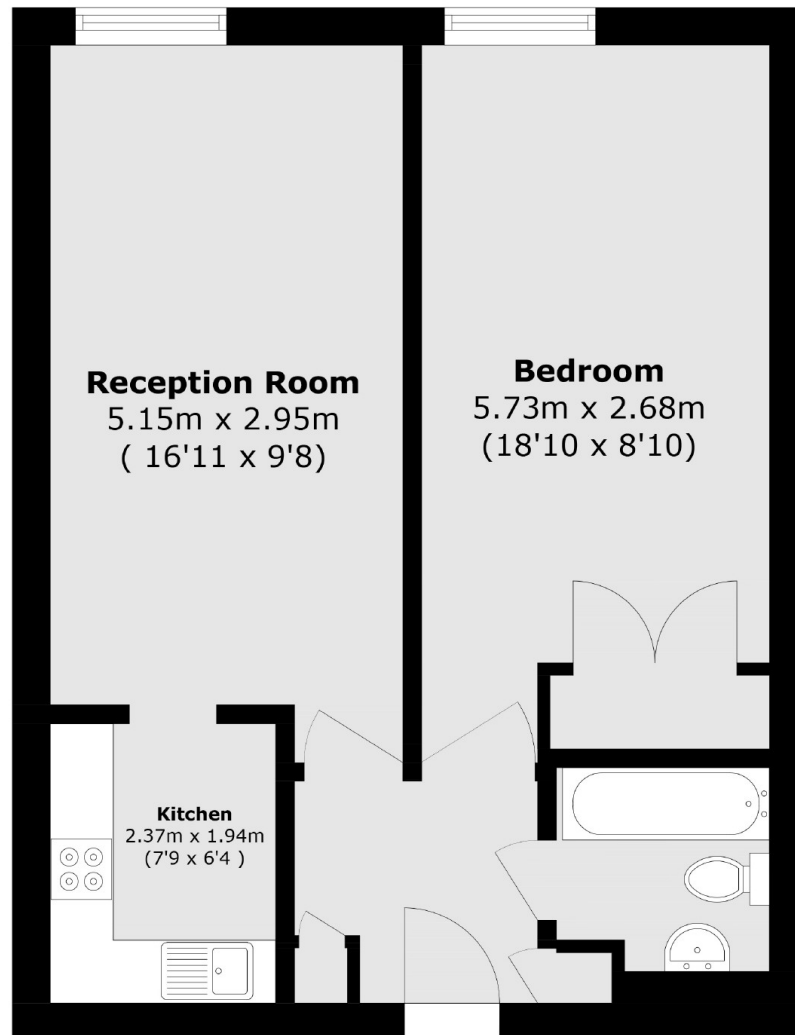

Total area (approx.): 43.4 sq. m (467.15 sq. ft)