



## Maclean Road, SE23

£875,000

Located in the heart of Honor Oak Park, this five bedroom family home offers lots of light, well-proportioned rooms and a beautiful rear garden.

Maclean Road is a sought after residential road. Honor Oak Park station provides direct mainline service to London Bridge and Victoria. In addition, there are Overground services northwards to Shoreditch and Highbury & Islington. You can change at Canada Water for easy access to Canary Wharf. Crofton Park station is also within easy reach for services into Blackfriars and Paddington.

### Features

- Five Bedrooms
- Terraced House
- Two Receptions
- Two Bathrooms
- Beautiful Rear Garden
- Close To Station



## Maclean Road, SE23

You enter the property through a wide and welcoming hallway with black and white chequerboard-tiled flooring. There are two good-sized reception rooms both with solid wood flooring. There's a separate kitchen that leads through to a small utility area. The garden is a particular highlight with two decked areas for entertaining and relaxing, and a lawn framed by mature planting. On the first floor, there are three double bedrooms and a family bathroom with a separate WC. On the top floor are two further bedrooms along with a bright and stylish shower room.



# Maclean Road, London, SE23

## Maclean Road

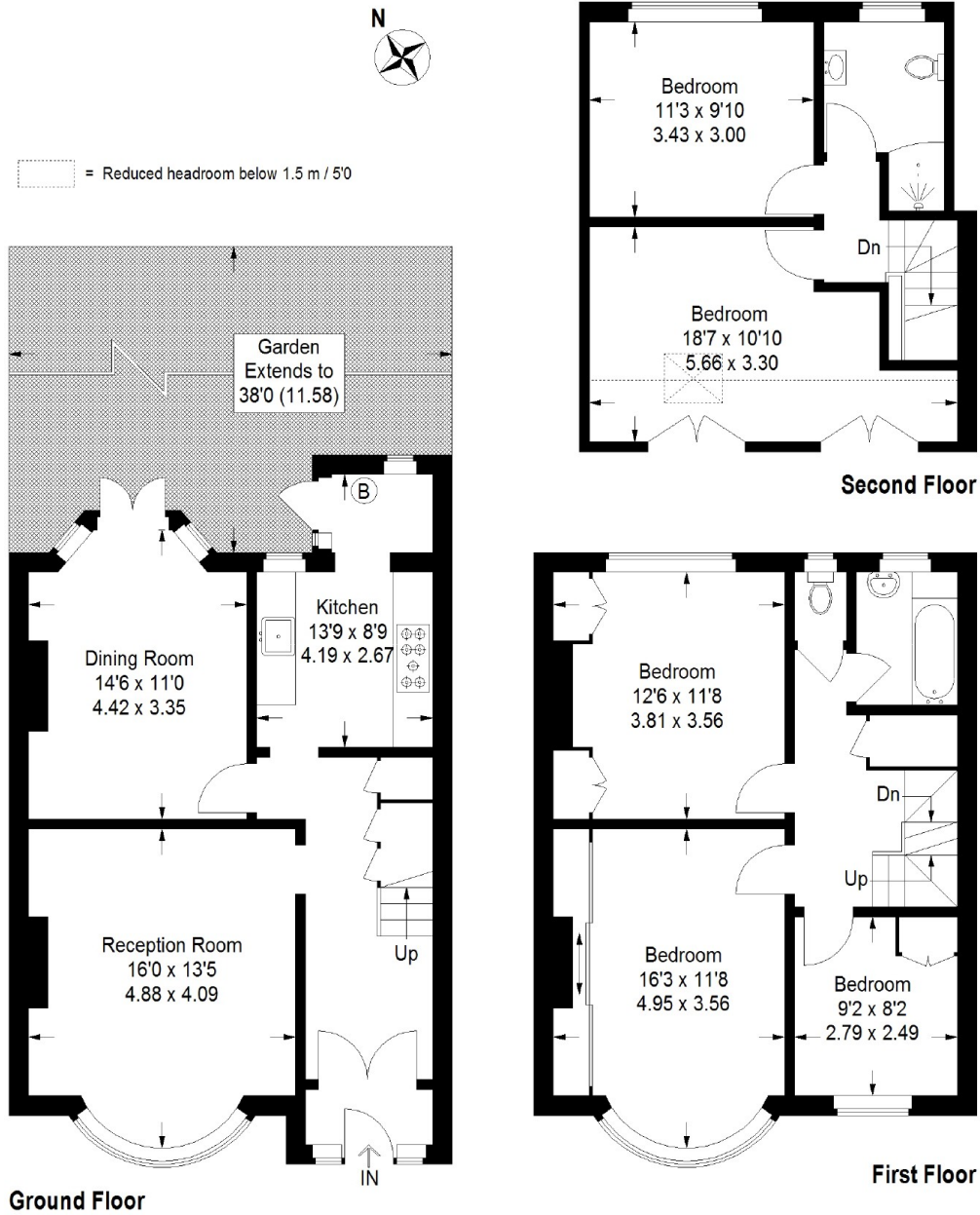

Approximate Gross Internal Area = 1550 sq ft / 144.0 sq m

Illustration for identification purposes only,  
measurements are approximate. Drawn for Sebastian Roche