



Stanstead Road, SE23

£4,000 Per calendar month

Ideal for sharers and close to Forest Hill station is this four double bedroom house.

Stanstead Road is located close to Forest Hill which has National Rail and Overground services. The local bars and restaurants of Forest Hill are also within close walking distance.

Features

- Terraced House
- Four Bedrooms
- Four Piece Bathroom
- Private Garden
- Close To Station
- Sharers Welcome

Stanstead Road, London, SE23

Ground Floor

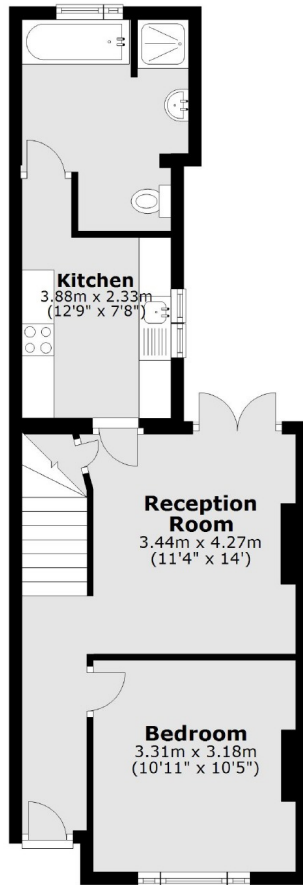

First Floor

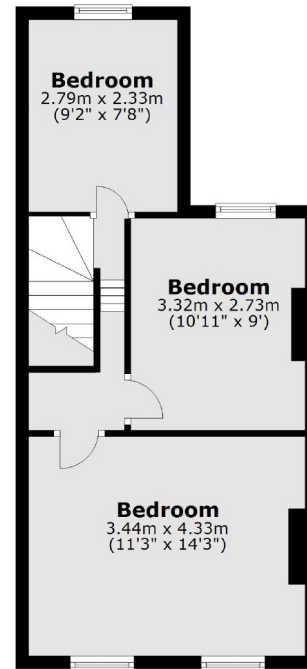

Total area: approx. 81.5 sq. metres (877.1 sq. feet)