



## Stanstead Road, SE23

£675,000

Measuring over 76 sq m this three bedroom split level maisonette which has been recently renovated to a high standard, offers ample living accommodation, off-street parking with electric car charging point and access to a large private landscaped south facing garden.

Stanstead Road is located midway between Honor Oak Park and Forest Hill stations both of which are on the same line. They provide mainline services into London Bridge as well as Overground services towards Shoreditch and Highbury and Islington. In addition, Catford and Catford Bridge stations are within easy reach for easy access into Charing Cross and the City.

### Features

- Three Bedrooms
- Split Level Maisonette
- Period Conversion
- Landscaped Garden
- Share of Freehold
- Close to Station

Stanstead Road,  
London, SE23

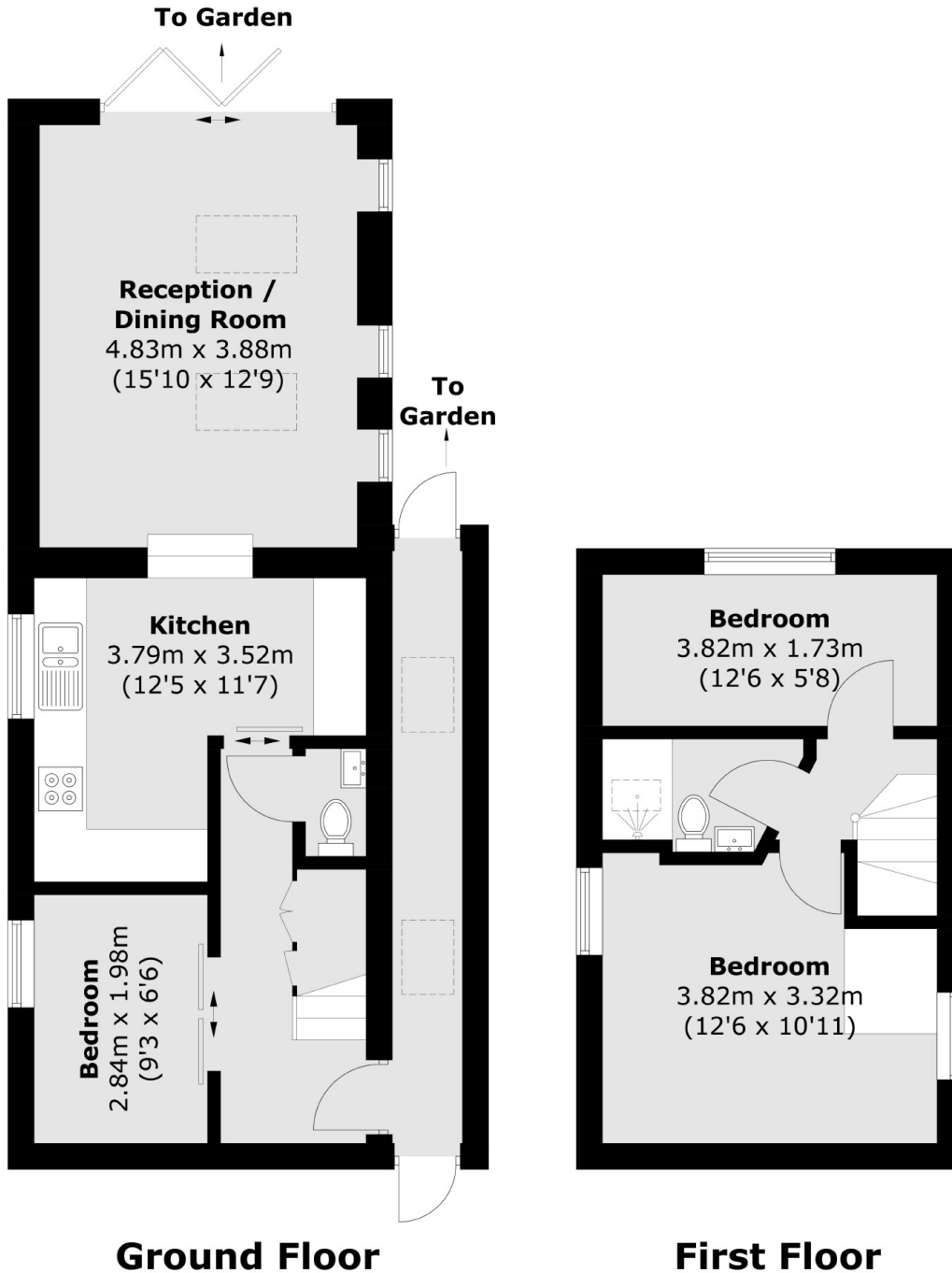

Total area (approx.): 76.6 sq. m (824.5 sq. ft)