



Garthorne Road, SE23

£2,850 Per calendar month

A light and airy, three bedroom period house, backing on to a nature reserve, a short walk from Honor Oak Park station.

Garthorne Road is a short walk away from Honor Oak Park station which provides excellent services to London Bridge as well as London Overground services northwards to Shoreditch and Highbury and Islington and southwards to Croydon

Features

- Three Bedrooms
- Mid Terrace House
- Period Features
- Modern Fitted Kitchen
- West Facing Garden
- Close to Station



Garthorne Road, SE23

The ground floor boasts a front room with a period fireplace and a sleek kitchen that opens up to a dining area with two sets of floor-to-ceiling patio doors allowing natural light to stream in. Upstairs are three double bedrooms and a stylish bathroom suite. At the rear is a lovely, west-facing garden which backs on to a nature reserve.



Garthorne Road,
London, SE23

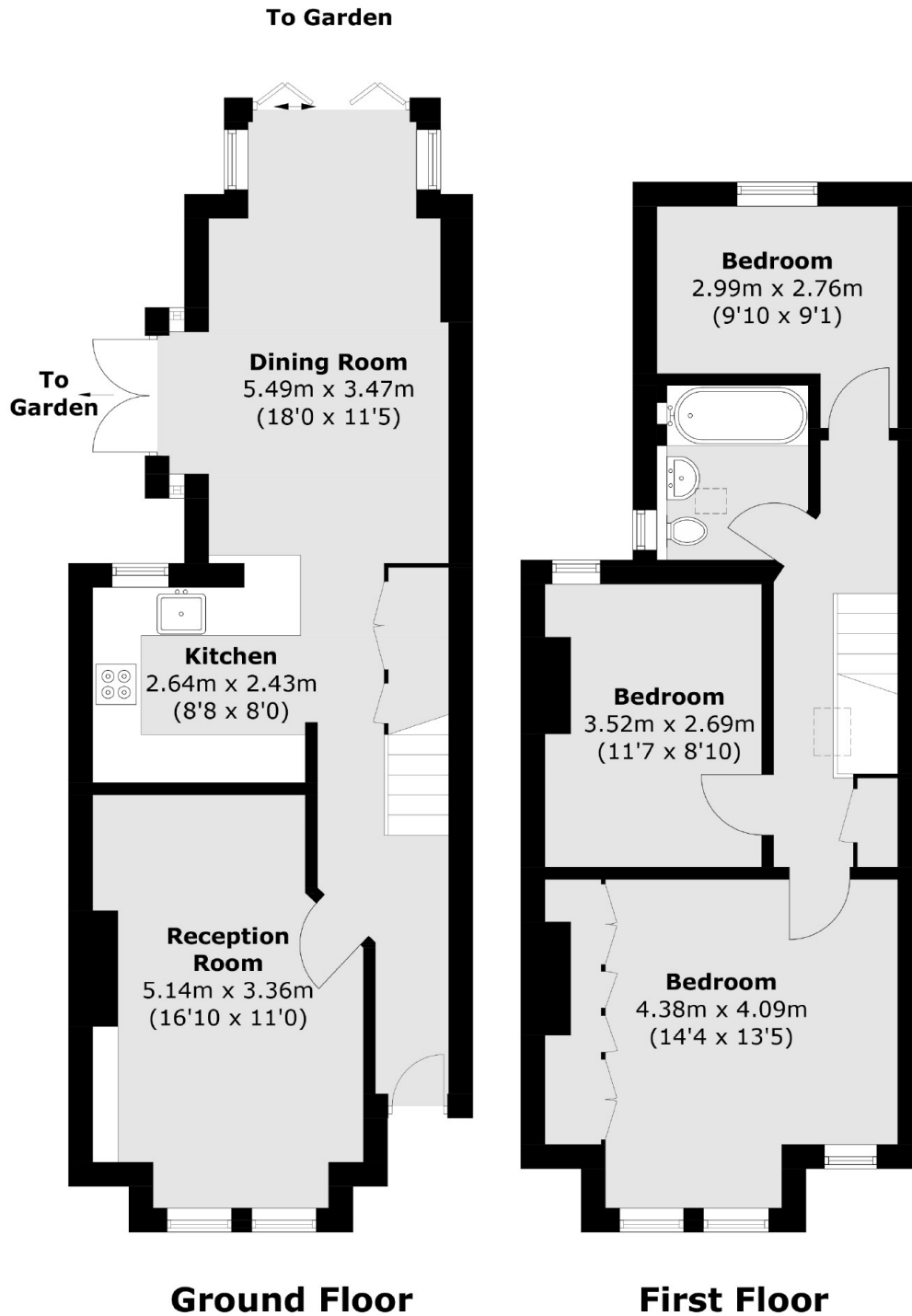

Total area (approx.): 95.9 sq. m (1,032.3 sq. ft)