



## Belvedere Road, SE19

£1,600 Per calendar month

A one bedroom flat with direct access to garden on the ground floor of a period conversion in the Belvedere Road Conservation Area,

A short walk from from Crystal Palace Station, Crystal Palace Park and the Triangle.

### Features

- One Bedroom Apartment
- Period Conversion
- Spacious Lounge
- Separate Fitted Kitchen
- Access to Garden
- Excellent Location

Belvedere Road,  
London, SE19

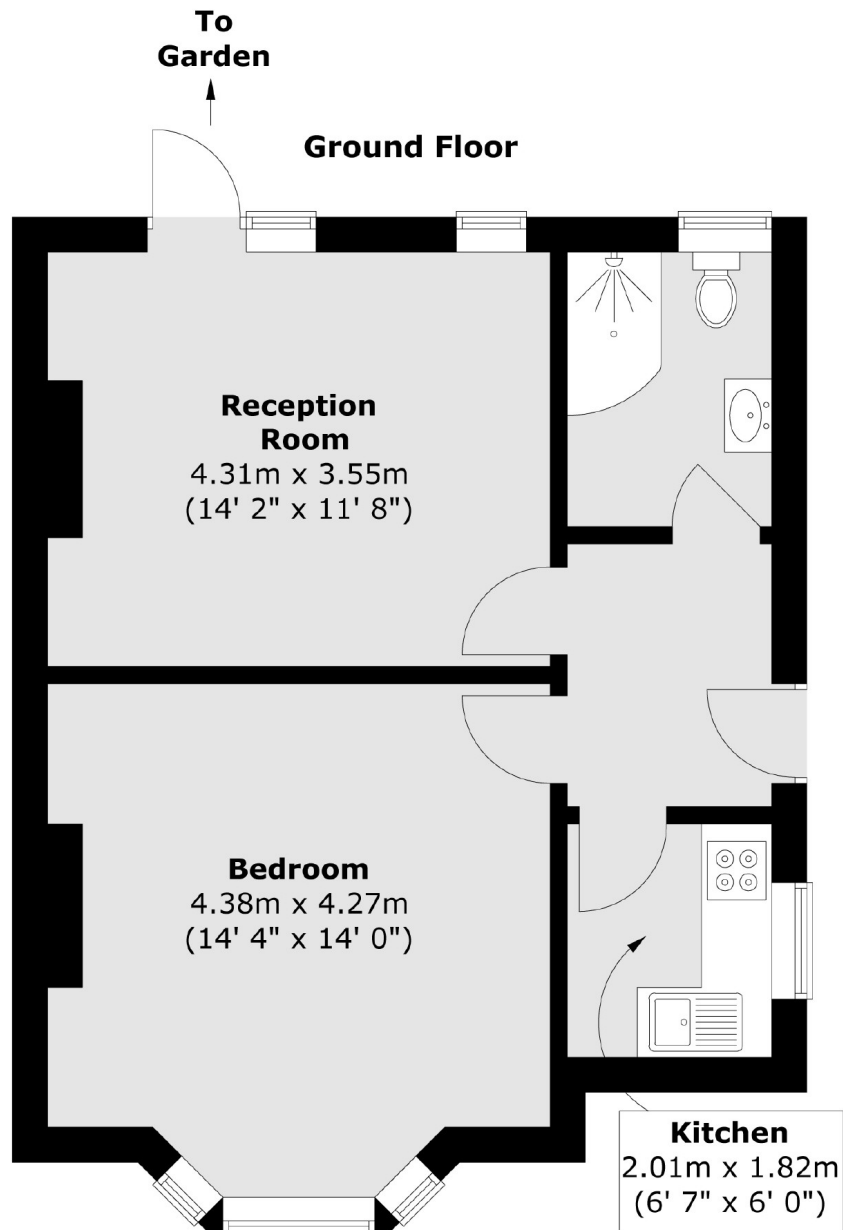

Total area (approx.) : 46.8 sq. m (504 sq. ft)

**Dexters**

Honor Oak  
61 Honor Oak Park  
London  
SE23 1EA  
Lettings  
020 8291 9441

Energy Rating: . We aim to make our particulars both accurate and reliable. However they are not guaranteed; nor do they form part of an offer or contract. If you require clarification on any points then please contact us, especially if you're traveling some distance to view. Please note that appliances and heating systems have not been tested and therefore no warranties can be given as to their good working order.

 **RICS** | Regulated  
Estate Agent  
and Letting Agent

dexters.co.uk