



Copeman Close, SE26

£525,000

A well proportioned three bedroom family house with a south-west facing garden. Over two floors it offers great living space with further potential to extend (STPP). The property further benefits from ample storage throughout and access to the community orchard with plenty of apple and pear trees.

Copeman Close is quiet cul-de-sac enjoying excellent transport links including Sydenham Overground with services to London Bridge, close proximity to green open spaces including Crystal Palace Park and Alexandra Recreation ground, as well as numerous coffee shops, restaurants and pubs and a wealth of shopping facilities nearby including Bell Green retail park.

Features

- Three Bedrooms
- Terraced House
- South West Facing Garden
- Cul-De-Sac
- Off Street Parking
- Close To Station

Copeman Close, London, SE26

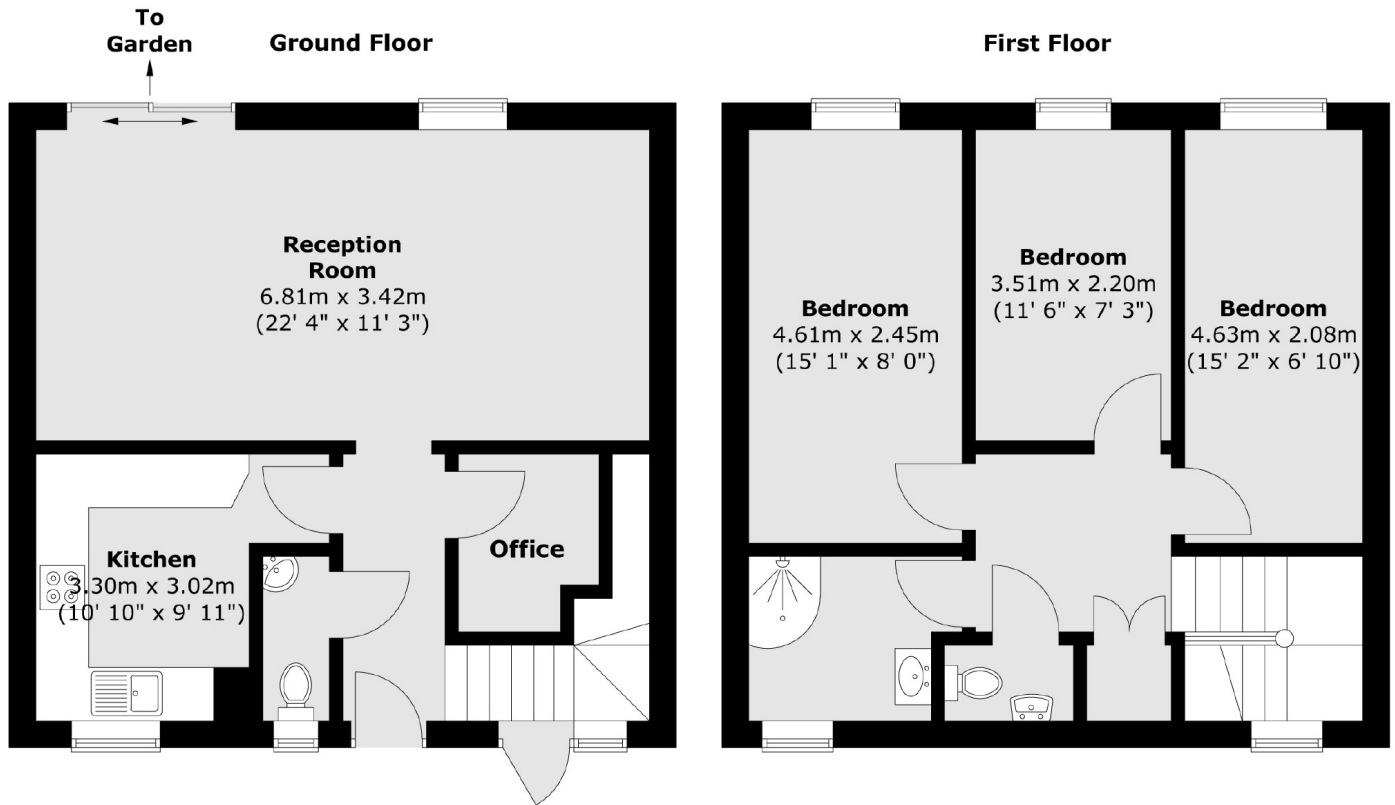

Total area (approx.) : 92.5 sq. m (996 sq. ft)