



## Rathfern Road, SE6

£375,000

A three-bedroom Victorian maisonette with a large fitted kitchen leading into the lounge with doors opening out to a private garden. The property is located between Catford and Forest Hill stations.

Rathfern Road is a popular tree lined residential street with convenient access to Catford and Catford Bridge train stations. The cafes, restaurants and shops of Catford, Honor Oak and Forest Hill are all within close proximity as well and it is located on the same road as the popular Rathfern Primary School.

### Features

- Victorian Maisonette
- Three Bedrooms
- Share Of Freehold
- Private Garden
- Close To Stations
- Chain Free

Rathfern Road,  
London, SE6

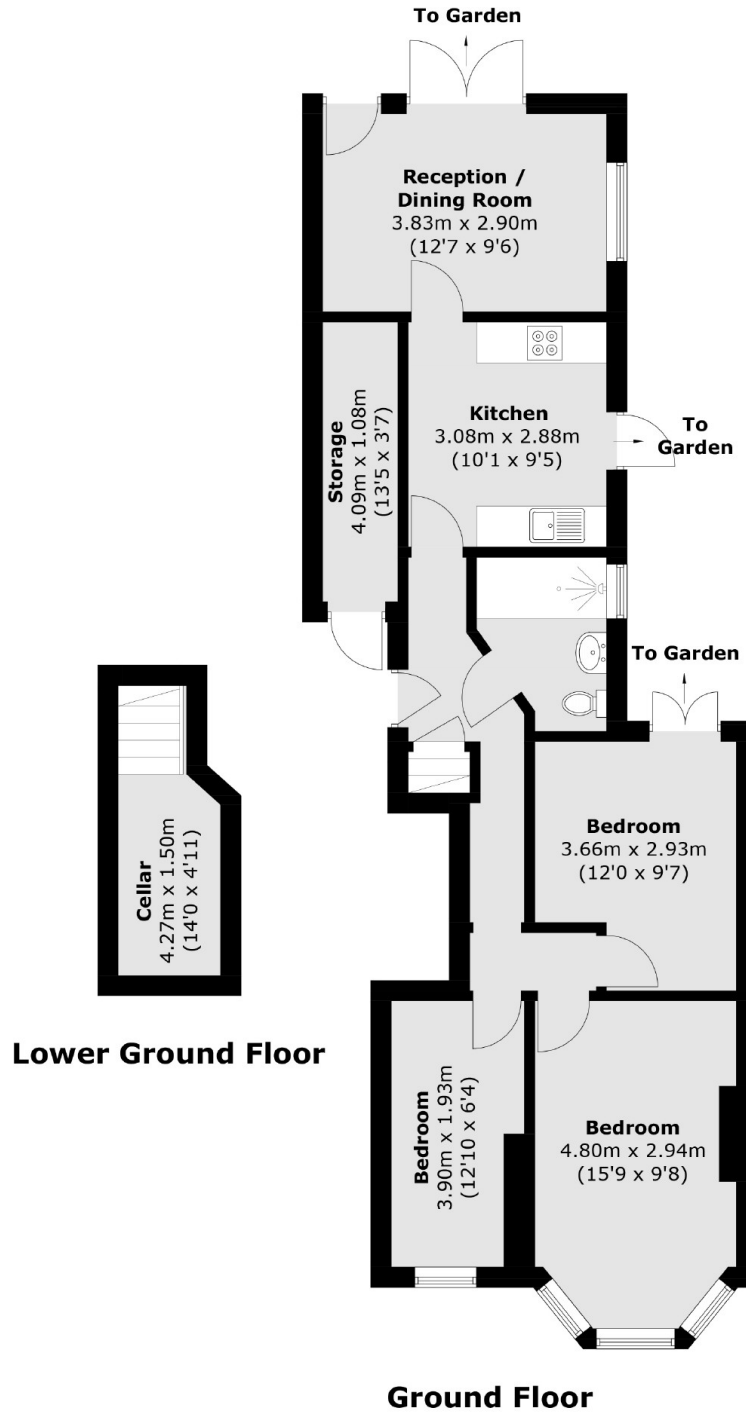

Total area (approx.): 73.9 sq. m (795.7 sq. ft)  
Storage (approx.): 4.6 sq. m (49.5 sq. ft)