



**2 Baileys Villas Pavenham Road, Felmersham,
Bedfordshire MK43 7EY**





A very well maintained and much improved two bedroom 1920's terraced house with a 59 ft rear garden and countryside views situated in the heart of this attractive and highly desirable North Bedfordshire village.

The accommodation features a stylish, refitted kitchen/diner, a separate sitting room, a refitted ground floor bathroom and two well proportioned first floor bedrooms. The property also benefits from replacement double glazing, electric heating and a low maintenance southwest facing rear garden which is 59 ft long with an artificial lawn, a summer house and a good sized covered patio area.

Felmersham is a picturesque riverside village approximately seven miles from Bedford town centre and mainline railway station and has a 13th century church, a village hall, a lower school, an excellent local pub and a nature reserve.

Early viewing of this delightful home is highly recommended.

- * **2 Good Sized Bedrooms**
- * **Refitted Kitchen/Diner**
- * **Sitting Room**
- * **Refitted Bathroom**
- * **Double Glazing**
- * **Electric Heating**
- * **59 Ft Southwest Facing Rear Garden**
- * **Sought After Village Location**
- * **Planning Consent for Rear Extension**

FREEHOLD



"Hassett House", Hassett Street, Bedford MK40 1HA

www.taylorbrightwell.co.uk property@taylorbrightwell.co.uk

01234 326444

Money Laundering Regulations: Intending purchasers will be asked to produce identification documentation and we would ask for co-operation in order that there is no delay in agreeing a sale. Agents Notes: The agent has not tested any apparatus, equipment, fixtures & fittings or services and so cannot verify that they are in working order or fit for the purpose. A buyer is advised to obtain verification from their solicitor or surveyor. All photographs shown are for illustration purposes only and may depict items that are not for sale or included in the sale of the property. Please note that we have not checked the situation with regards to planning consents, building regulation consents and any other relevant consents relating to this property and therefore, any interested purchaser should carry out their own enquiries with the appropriate authorities. All measurements are approximate and for guidance only. The particulars do not form part of any contract and all properties are offered subject to contract. Neither Taylor Brightwell nor any of its employees or agents has any authority to make or give any representation or warranty whatsoever in relation to this property.

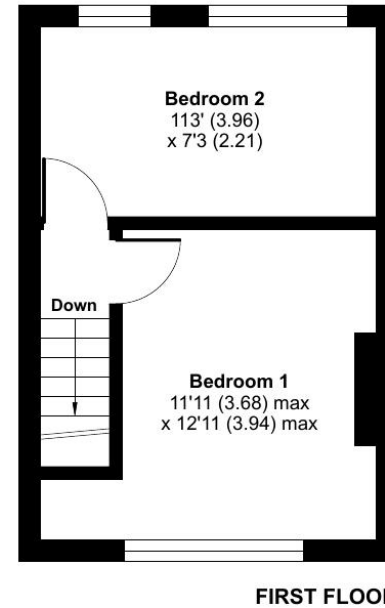
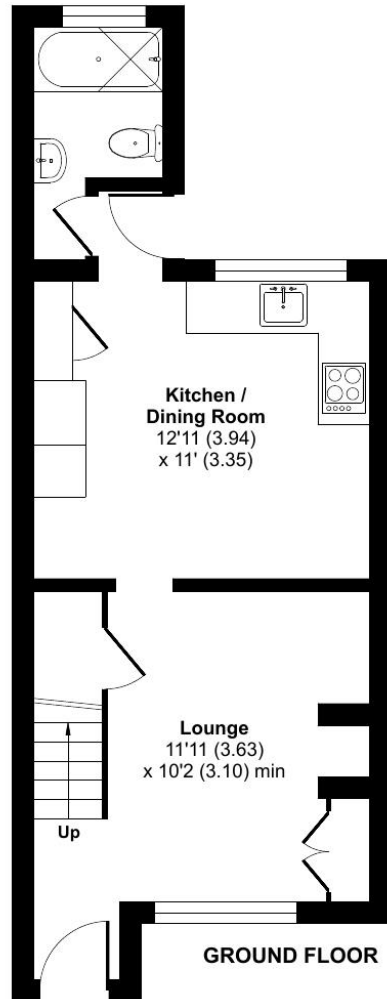

Approximate Area = 629 sq ft / 58.4 sq m

For identification only - Not to scale



Floor plan produced in accordance with RICS Property Measurement Standards incorporating International Property Measurement Standards (IPMS2 Residential). © n̄tchecom 2024. Produced for Taylor Brightwell. REF: 1192642