



7, Church Road, Stevington,  
Bedfordshire MK43 7QB

Taylor  
Brightwell



An extended two double bedroom stone cottage with a 62 ft long rear garden nicely positioned in the centre of this quiet and attractive north Bedfordshire village and offered for sale with no upward chain.

The property benefits from a spacious, dual aspect sitting/dining room with exposed brick fireplace, a galley style fitted kitchen, a ground floor bathroom and two spacious first floor bedrooms.

Externally a gated side passage leads to the secluded rear garden which is lawned with established borders.

A good sized and attractive cottage in the heart of this highly desirable village, viewing is highly recommended.

- \* **Attractive Stone Cottage**
- \* **2 Double Bedrooms**
- \* **Galley Style Kitchen**
- \* **Ground Floor Bathroom**
- \* **Gas Radiator Heating**
- \* **62 Ft Rear Garden**
- \* **Sought After Village Location**
- \* **No Upward Chain**

**Freehold**



"Hassett House", Hassett Street, Bedford MK40 1HA

[www.taylorbrightwell.co.uk](http://www.taylorbrightwell.co.uk)    [property@taylorbrightwell.co.uk](mailto:property@taylorbrightwell.co.uk)

**01234 326444**

Money Laundering Regulations: Intending purchasers will be asked to produce identification documentation and we would ask for co-operation in order that there is no delay in agreeing a sale. Agents Notes: The agent has not tested any apparatus, equipment, fixtures & fittings or services and so cannot verify that they are in working order or fit for the purpose. A buyer is advised to obtain verification from their solicitor or surveyor. All photographs shown are for illustration purposes only and may depict items that are not for sale or included in the sale of the property. Please note that we have not checked the situation with regards to planning consents, building regulation consents and any other relevant consents relating to this property and therefore, any interested purchaser should carry out their own enquiries with the appropriate authorities. All measurements are approximate and for guidance only. The particulars do not form part of any contract and all properties are offered subject to contract. Neither Taylor Brightwell nor any of its employees or agents has any authority to make or give any representation or warranty whatsoever in relation to this property.

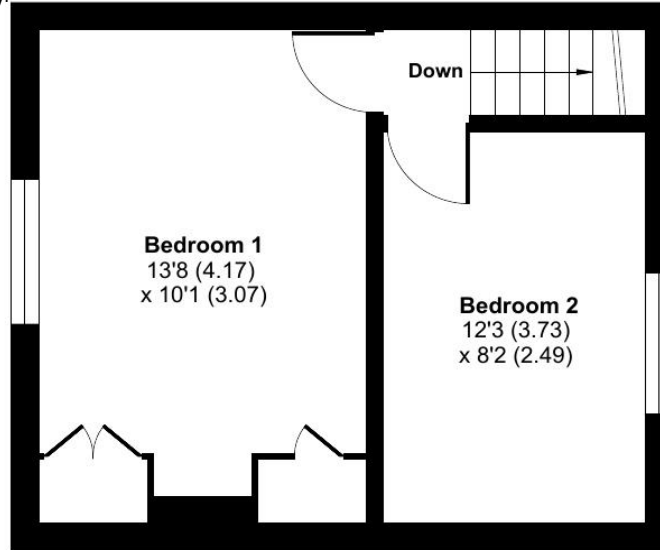

**FIRST FLOOR**

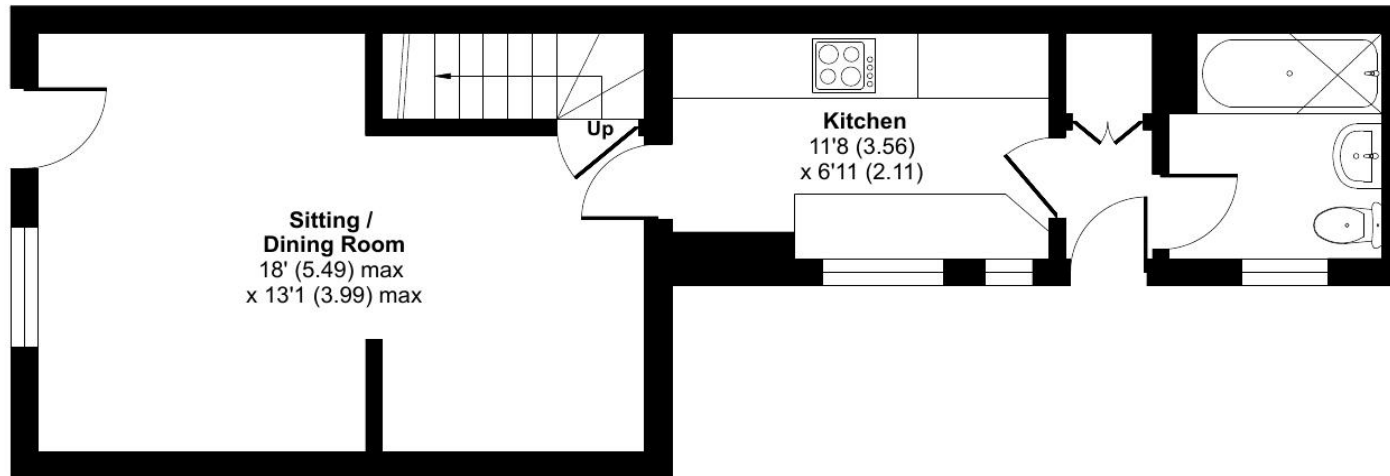

**GROUND FLOOR**

Approximate Area = 685 sq ft / 63.6 sq m

For identification only - Not to scale



Floor plan produced in accordance with RICS Property Measurement Standards incorporating International Property Measurement Standards (IPMS2 Residential). © nitchecom 2024. Produced for Taylor Brightwell. REF: 1167513