

**WILKES
GREEN
HILL**

Residential
Estate Agents
Letting Agents

The Cottage, Tirril,, Cumbria, CA10 2JE



- **Traditional Stone Built Cottage**
- **Popular Village Location with Easy Access to Penrith and Ullswater**
- **Living Room with Open Fire + Kitchen**
- **2 Bedrooms, Bathroom + Attic Room**
- **Double Glazing + Central Heating Via an in-line Electric Boiler**
- **Paved Forecourt + Private Enclosed Yard Area**
- **Tenure - Freehold. EPC Rate - G. Council Tax Band - B.**

Price £180,000

This charming cottage is located in the picturesque village of Tirril, with easy access to Penrith and just 2.5 miles from Ullswater with accommodation comprising Living Room with Open Fireplace, Kitchen, 2 bedrooms and a Bathroom. Outside there is a paved forecourt (over which the neighbouring property has a pedestrian right of way) and a private yard to the rear. The cottage also benefits from Double Glazing and Central Heating via an electric in-line boiler

This cottage is ideal for those seeking a retreat away from the hustle and bustle of city life., whether you're looking for a weekend getaway or a permanent residence.

Location

From Penrith, head south on the A6 and drive through Eamont Bridge. At the mini roundabout, in Eamont Bridge, turn right, signposted to Ullswater. Follow the road past Yanwath and on entering the village of Tirril The cottage is on the right hand side.

Amenities

Sockbridge, is located between Penrith and Lake Ullswater and is on the fringe of the Lake District National Park and is conveniently situated for access to Ullswater and the surrounding Fells In the adjoining village of Tirril there is a well patronised public house, a village hall supporting community events, a garage with filling station and a church nearby in Barton. A local bus service connects the village with Penrith, 3 miles and Pooley Bridge 2.5 miles. Penrith is a popular market town with a population of around 16,000 people and facilities include: infant, junior and secondary schools with a further/higher education facility at Newton Rigg College. There are 5 supermarkets and a good range of locally owned and national high street shops. Leisure facilities include: a leisure centre with; swimming pool, climbing wall, indoor bowling, badminton courts and a fitness centre as well as; golf, rugby and cricket clubs. There is also a 3 screen cinema and Penrith Playhouse. Penrith is known as the Gateway to the North Lakes and is conveniently situated for Ullswater and access to the fells, benefiting from the superb outdoor recreation opportunities.

Services

Mains water, drainage and electricity are connected to the property. Heating is via an electric in-line boiler.

Tenure

The property is freehold and the council tax is band B.

Viewing

STRICTLY BY APPOINTMENT WITH WILKES-GREEN + HILL

ACCOMMODATION

Entrance

Through a composite security door to the;

Hall

Having slate tiled flooring, a single radiator and stairs off with a walk in store below which also houses an electric "Heatrae Sadia2 in line boiler for the central heating. Planked doors lead off to the kitchen and;

Living Room 15'9 x 11'4 (4.80m x 3.45m)

An open dog grate fireplace is set in a stone inglenook with a rustic timber mantel. The flooring is stone flagged and there feature beams to the ceiling. A uPVC double glazed sash window faces to the front and a uPVC double glazed door opens to an enclosed yard. There is a double radiator and a TV point.



Kitchen 8'10 x 8'3 (2.69m x 2.51m)

Fitted with base cupboards and a tiled work surface with a wood section incorporating a ceramic Belfast sink with mixer tap. There is a space for an electric range cooker, space for a fridge and plumbing for a dishwasher and washing machine. The flooring is stone and there is an exposed beam to the ceiling. There is a small double radiator and uPVC double glazed window to the rear.



First Floor-Landing

A uPVC double glazed window gives natural light. There is a double radiator, a cabin ladder to the attic and planked door to the bedrooms and bathroom.

Bedroom One 9'1 x 9'10 (2.77m x 3.00m)

A uPVC double glazed sash window faces to the rear and there is a single radiator.



Bedroom Two 9'1 x 10'1 (2.77m x 3.07m)

A uPVC double glazed sash window faces to the rear and there is a single radiator.



Bathroom 6'4 x 6'9 (1.93m x 2.06m)

Fitted with a toilet, a wash basin and a short roll top claw foot bath with handset mixer shower taps. The walls are part tiled, there is underfloor heating, a built in linen cupboard and uPVC double glazed sash window to the front.



Attic Room

Having a double glazed Velux roof window and two double radiators.



Outside

To the front of the cottage is a cobbled yard allowing space for a table and chairs and there is a well stocked flowering and shrub bed by the cottage.

The neighbouring cottage do have a right of way across the forecourt.



To the rear of the cottage is a small enclosed cobbled yard ideally situated for the afternoon and evening sun.



GROUND FLOOR
310 sq.ft. (28.8 sq.m.) approx.



1ST FLOOR
308 sq.ft. (28.6 sq.m.) approx.

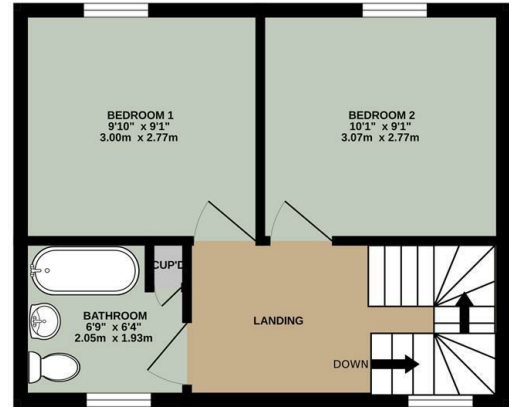

TOTAL FLOOR AREA : 618 sq.ft. (57.4 sq.m.) approx.

Whilst every attempt has been made to ensure the accuracy of the floorplan contained here, measurements of doors, windows, rooms and any other items are approximate and no responsibility is taken for any error, omission or mis-statement. This plan is for illustrative purposes only and should be used as such by any prospective purchaser. The services, systems and appliances shown have not been tested and no guarantee as to their operability or efficiency can be given.
Made with Metropix ©2024

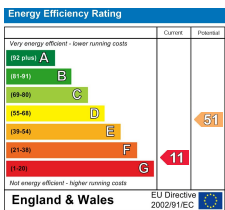

Email - welcome@wilkesgreenhill.co.uk

Visit our Website - www.wilkesgreenhill.co.uk

Disclaimer

These particulars are set out as a general outline in accordance with the Property Misdescriptions Act (1991) only for the guidance of intending purchasers or lessees, and do not constitute any part of an offer or contract. Details are given without any responsibility, and any intending purchasers, lessees or third parties should not rely on them as statements or representations of fact, but must satisfy themselves by inspection or otherwise as to the correctness of each of them. We have not carried out a structural survey and the services, appliances and specific fittings have not been tested. All photographs, measurements, floor plans and distances referred to are given as a guide only and should not be relied upon for the purchase of carpets or any other fixtures or fittings. Gardens, roof terraces, balconies and communal gardens as well as tenure and lease details cannot have their accuracy guaranteed for intending purchasers. Lease details, service ground rent (where applicable) are given as a guide only and should be checked and confirmed by your solicitor prior to exchange of contracts. No person in the employment of Wilkes-Green + Hill Ltd has any authority to make any representation or warranty whatever in relation to this property. Purchase prices, rents or other prices quoted are correct at the date of publication and, unless otherwise stated, exclusive of VAT. Intending purchasers and lessees must satisfy themselves independently as to the incidence of VAT in respect of any transaction relating to this property.

Data Protection

We retain the copyright in all advertising material used to market this Property.

9 + 10 Angel Lane
Penrith
Cumbria
CA11 7BP

T: 01768 867999
F: 01768 895033
info@wilkesgreenhill.co.uk
www.wilkesgreenhill.co.uk

Registered in England and Wales No. 3210913
Registered Office: 9 + 10 Angel Lane, Penrith

