

Plumpton Head Farm, Plumpton, CA11 9NP



- **Large Traditional Sandstone Barn with Full Planning Permission to Create 2 Spacious Homes**
- **Rural Location 3 Miles to the North of Penrith Town Centre**
- **Unit 2 - 163 Sq M - 1756 Sq Ft. Unit 3 169 Sq M - 1821 Sq Ft**
- **Potential to Create a Single Large Dwelling Subject to a Change of Planning Permission**
- **Gardens to the Rear with a Lovely Open View**
- **Parking to the Front for Several Vehicles**
- **Tenure - Freehold. Council Tax - To Be Assessed Upon Completion**

Price £250,000

Forming the larger part of this sandstone barn just over 3 miles from the centre of Penrith and with excellent open views to the rear across the surrounding countryside, this is an increasingly rare opportunity to re-develop a traditional farm building to create 2 large homes, Unit 2 giving approximately 1756 sq ft - 163 sq m and unit 3 being approximately 1821 sq ft - 169 sq m.

Alternatively, there is excellent potential to alter the planning permission to create a large single dwelling in the region of 3,500 sq ft - 325 sq m.

Unit 2 will have accommodation comprising: Entrance Hall, Dining Kitchen, Living Room being open to the ceiling, Rear Hall, a Double Bedroom/Study, a Double Bedroom with En-Suite Shower Room and a Bathroom to the ground floor and a Landing and 2 Double Bedrooms to the first floor.

Unit 3 comprises: Entrance Hall, Dining Kitchen, Living Room, a Double Bedroom with En-Suite, a WC and a Utility Room all to the ground floor and a Landing, 3 Bedrooms and a Bathroom to the first floor.

To the front of each unit is a hardstanding area allowing Off Road Parking for several vehicles and to the rear is a Garden with a westerly aspect and an open view across the surrounding countryside.

Full drawings and planning permission can be viewed on the Westmorland and Council for Eden website, application number 16/0055

Location

From Penrith, head North on the A6, Scotland Road. At Stoneybeck roundabout take the 3rd exit and continue for approximately 0.8 mile and turn right. The property is on the right.

Amenities

Plumpton Head Farm is just over 3 miles from Penrith town centre, 15 miles from Carlisle city centre and 1.8 miles from Junction 41 of the M6 and offers excellent access to the Lake District and the Eden Valley.

Penrith is a popular market town, having excellent transport links through the M6, A66, A6 and the main West coast railway line. There is a population of around 17,000 people and facilities include: infant, junior and secondary schools. There are 5 supermarkets and a good range of locally owned and national high street shops. Leisure facilities include: a leisure centre with; swimming pool, climbing wall, indoor bowling, badminton courts and a fitness centre as well as; golf, rugby and cricket clubs. There is also a 3 screen cinema and Penrith Playhouse. Penrith is known as the Gateway to the North Lakes and is conveniently situated for Ullswater and access to the fells, benefiting from the superb outdoor recreation opportunities.

Services

Mains water and electricity are to neighbouring property, it is the buyer/developers responsibility to arrange for connection.

The buyer/developer will need to install a treatment plant within the curtilage of the barn and arrange for surface water drainage.

Viewing

STRICTLY BY APPOINTMENT WITH WILKES-GREEN + HILL

Referral Fees

WGH work with the following provider for arrangement of mortgage & other products/insurances, however you are under no obligation to use their services and may wish to compare them against other providers. Should you choose to utilise them WGH will receive a referral fee :

The Right Advice (Bulman Pollard) Carlisle

Average referral fee earned in 2024 was £253.00

This map is for identification purposes only and does not form part of the contract of sale.



GROUND FLOOR



1ST FLOOR

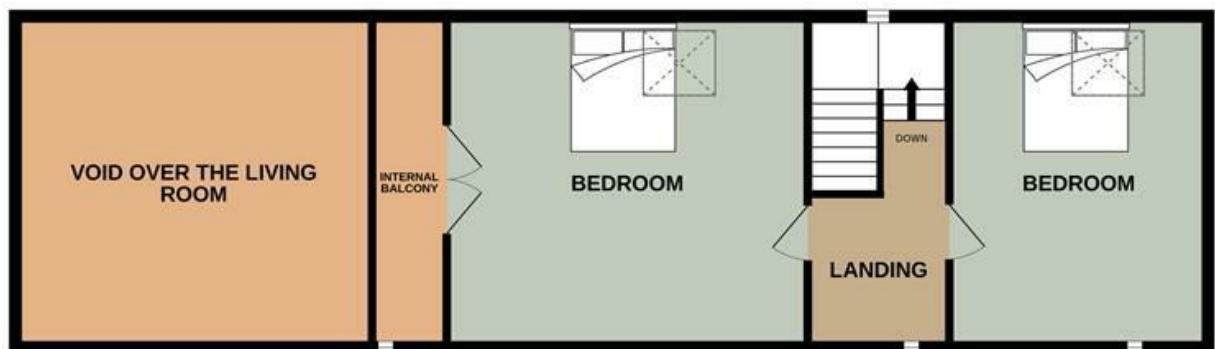

Whilst every attempt has been made to ensure the accuracy of the floorplan contained here, measurements of doors, windows, rooms and any other items are approximate and no responsibility is taken for any error, omission or mis-statement. This plan is for illustrative purposes only and should be used as such by any prospective purchaser. The services, systems and appliances shown have not been tested and no guarantee as to their operability or efficiency can be given.
Made with Metropix ©2023

GROUND FLOOR
1377 sq.ft. (128.0 sq.m.) approx.



1ST FLOOR
553 sq.ft. (51.4 sq.m.) approx.



TOTAL FLOOR AREA : 1930 sq.ft. (179.3 sq.m.) approx.
Whilst every attempt has been made to ensure the accuracy of the floorplans contained here, measurements of doors, windows, stairs and any other items are approximate and no responsibility is taken for any error, omission or mis-statement. This plan is for illustrative purposes only and should be used as such by any prospective purchaser. The services, systems and appliances shown have not been tested and no guarantee as to their operability or efficiency can be given.
Made with Metaplan 12/23

Email - welcome@wilkesgreenhill.co.uk
Visit our Website - www.wilkesgreenhill.co.uk

9 + 10 Angel Lane
Penrith
Cumbria
CA11 7BP

T: 01768 867999
F: 01768 895033
info@wilkesgreenhill.co.uk
www.wilkesgreenhill.co.uk

Registered in England and Wales No. 3210913
Registered Office: 9 + 10 Angel Lane, Penrith

Disclaimer

These particulars are set out as a general outline in accordance with the Property Misdescriptions Act (1991) only for the guidance of intending purchasers or lessees, and do not constitute any part of an offer or contract. Details are given without any responsibility, and any intending purchasers, lessees or third parties should not rely on them as statements or representations of fact, but must satisfy themselves by inspection or otherwise as to the correctness of each of them. We have not carried out a structural survey and the services, appliances and specific fittings have not been tested. All photographs, measurements, floor plans and distances referred to are given as a guide only and should not be relied upon for the purchase of carpets or any other fixtures or fittings. Gardens, roof terraces, balconies and communal gardens as well as tenure and lease details cannot have their accuracy guaranteed for intending purchasers. Lease details, service ground rent (where applicable) are given as a guide only and should be checked and confirmed by your solicitor prior to exchange of contracts. No person in the employment of Wilkes-Green + Hill Ltd has any authority to make any representation or warranty whatever in relation to this property. Purchase prices, rents or other prices quoted are correct at the date of publication and, unless otherwise stated, exclusive of VAT. Intending purchasers and lessees must satisfy themselves independently as to the incidence of VAT in respect of any transaction relating to this property.

Data Protection

We retain the copyright in all advertising material used to market this Property.

