

est 1979

Jeremy
Leaf & Co.

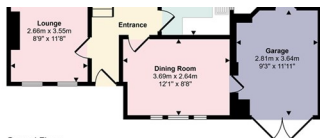

Ground Floor
Approx 44 sq m / 477 sq ft



10 Green Road, Whetstone, N20 0QT

£450,000

- Kitchen
- Separate Dining Area
- Three bedrooms
- FGCH
- Family Bathroom
- Garage
- Council Tax Band D
- Reception Room

863 High Road, London, N12 8PT
020 8446 4295

property@jeremyleaf.co.uk
<https://www.jeremyleaf.co.uk/>

10 Green Road, Whetstone N20 0QT

Three bedroom end of terrace house requiring modernisation throughout.

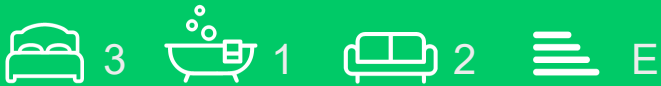

Council Tax Band: D

Full Description

Three bedroom end of terrace house requiring modernisation throughout.

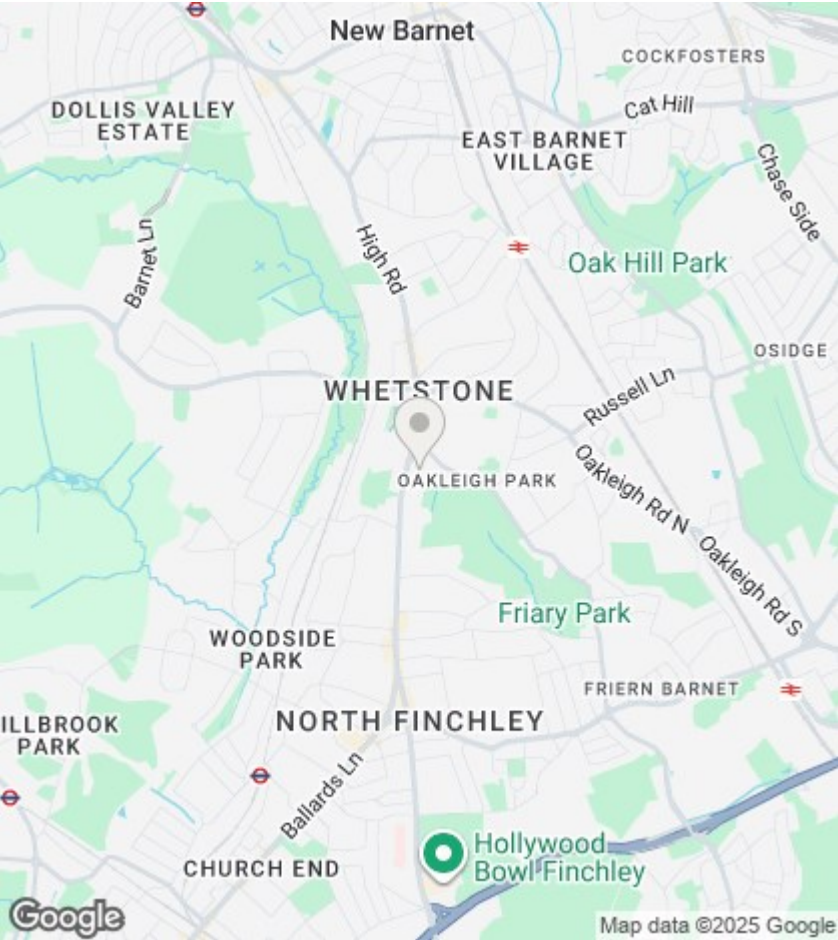

Directions

Viewings

Viewings by arrangement only. Call 020 8446 4295 to make an appointment.

EPC Rating:
E

Energy Efficiency Rating		
	Current	Potential
Very energy efficient - lower running costs		
(92 plus) A		
(81-91) B		
(69-80) C		74
(55-68) D		
(39-54) E	40	
(21-38) F		
(1-20) G		
Not energy efficient - higher running costs		
England & Wales		EU Directive 2002/91/EC