



Goldstone Villas, Hove, BN3 3RS
£375,000 - £400,000 Guide



**GOLDIN
LEMCKE**

01273 777123
GOLDINLEMCKE.COM

SELLING HOMES
IN BRIGHTON
& HOVE
SINCE 2002

Goldstone Villas, Hove, BN3 3RS

£375,000 - £400,000 Guide

A superb split-level two-bedroom flat occupying the entire second (top) floor of this attractive period property, ideally located in central Hove just moments from Hove Station. The property offers bright and spacious accommodation throughout, and early internal viewing is highly recommended.





Further Information

The accommodation includes a generous split-level hallway, currently arranged with a small study area, a spacious living room, modern fitted kitchen, bathroom, and two double bedrooms. The principal bedroom is particularly impressive, featuring two sash windows and a bright south-easterly aspect. The property is well presented throughout and benefits from attractive leafy views from both aspects.

Goldstone Villas is situated in this highly sought-after and central Hove location, just a short walk from Hove Station. The area has a friendly, residential feel while still being close to everything - Church Road, George Street and Blatchington Road are nearby, offering plenty of cafés, restaurants and local shops. The seafront is also within easy reach, making this a convenient spot for both commuters and anyone who enjoys having the best of Hove on their doorstep.



GOLDINLEMCKE

01273 777123
GOLDINLEMCKE.COM

Goldstone Villas

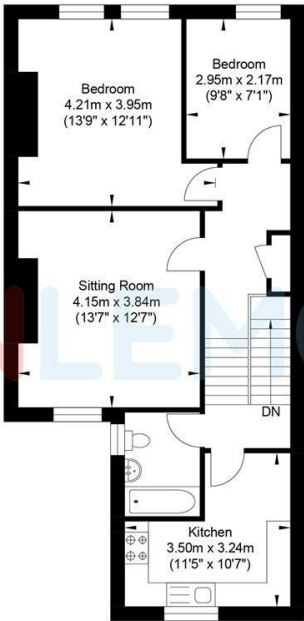
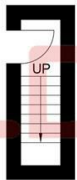

First Floor
Approximate Floor Area
27.87 sq ft
(2.59 sq m)

Second Floor
Approximate Floor Area
665.74 sq ft
(61.85 sq m)

Approximate Gross Internal Area = 64.44 sq m / 683.61 sq ft
Illustration for identification purposes only, measurements are approximate, not to scale.

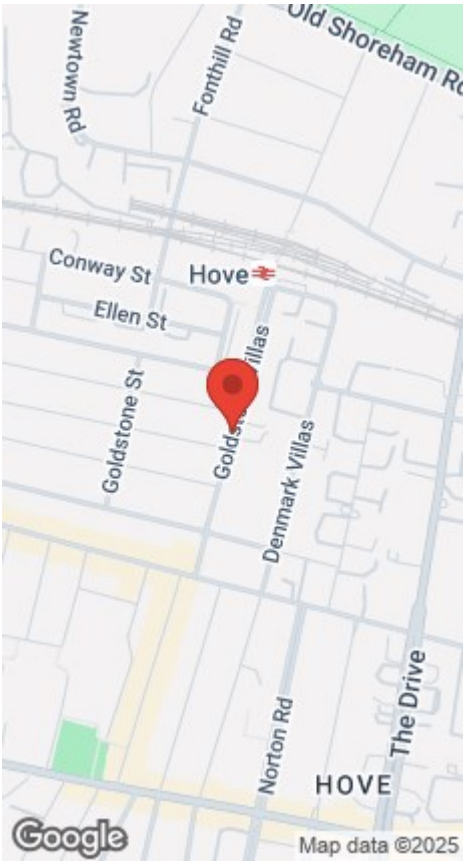

GOLDIN LEMCKE
01273 777123
GOLDINLEMCKE.COM

SELLING SOMETHING SIMILAR?

Get in touch for a free, no obligation valuation.
Call 01273 777123 or email property@goldinlemcke.com

The above information has been provided by the vendor in good faith, but will need verification by the purchaser's solicitor. Any areas, measurements or distances referred to are given as a guide only and are not precise. Floor plans are not drawn to scale and are provided only to help illustrate the general layout of the property. The mention of any appliances and/or services in this description does not imply that they are in full and efficient working order and prospective purchasers should make their own investigations before finalising any agreement to purchase. It should not be assumed that any contents, furnishings or other items shown in photographs (which may have been taken with a wide angle lens) are included in the sale. Any reference to alterations to, or use of, any part of the property is not a statement that the necessary planning, building regulations, listed buildings or other consents have been obtained. We endeavour to make our details accurate and reliable, but they should not be relied on as statements or representations of fact and they do not constitute any part of an offer or contract. The seller does not give any warranty in relation to the property and we have no authority to do so on their behalf.

Energy Efficiency Rating		
	Current	Potential
Very energy efficient - lower running costs		
(92 plus) A		
(81-91) B		
(69-80) C		
(55-68) D		
(39-54) E		
(21-38) F		
(1-20) G		
Not energy efficient - higher running costs		
	74	79
England & Wales	EU Directive 2002/91/EC	

SELLING HOMES
IN BRIGHTON
& HOVE
SINCE 2002