



**GOLDIN
LEMCKE**

01273 777123
GOLDINLEMCKE.COM

SELLING HOMES
IN BRIGHTON
& HOVE
SINCE 2002

Medina Villas, Hove, BN3 2RN

£250,000



Medina Villas, Hove, BN3 2RN

£250,000

A well-presented one-bedroom flat occupying part of the ground floor of this attractive semi-detached building, conveniently located between Church Road and Hove seafront. Early and internal inspection is highly recommended.

Medina Villas

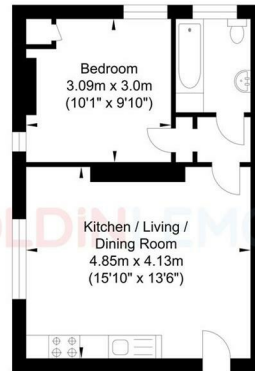

Approximate Floor Area
382.11 sq ft
(35.50 sq m)

Approximate Gross Internal Area = 35.50 sq m / 382.11 sq ft
Illustration for identification purposes only, measurements are approximate, not to scale.

Internally, the accommodation comprises a spacious kitchen/living/dining room with modern fitted kitchen and feature fireplace, bathroom, and double bedroom. The property is bright and spacious throughout and is offered for sale in good decorative order.

Medina Villas is situated in this sought-after residential location adjacent to Church Road and Hove seafront. There are a wide range of nearby shopping facilities, bars and restaurants, as well as excellent bus services providing access to Brighton city centre. Hove seafront is within easy walking distance, as is Hove mainline railway station, providing excellent commuter links to London and beyond.

Energy Efficiency Rating		
	Current	Potential
Very energy efficient - lower running costs		
(92 plus) A		
(81-91) B		
(69-80) C		
(55-68) D		
(39-54) E		
(21-38) F		
(1-20) G		
Not energy efficient - higher running costs		
England & Wales	EU Directive 2002/91/EC	

SELLING SOMETHING SIMILAR?

Get in touch for a free,
no obligation valuation.
Call 01273 777123
or **email**
property@goldinlemcke.com

The above information has been provided by the vendor in good faith, but will need verification by the purchaser's solicitor. Any areas, measurements or distances referred to are given as a guide only and are not precise. Floor plans are not drawn to scale and are provided only to help illustrate the general layout of the property. The mention of any appliances and/or services in this description does not imply that they are in full and efficient working order and prospective purchasers should make their own investigations before finalising any agreement to purchase. It should not be assumed that any contents, furnishings or other items shown in photographs (which may have been taken with a wide angle lens) are included in the sale. Any reference to alterations to, or use of, any part of the property is not a statement that the necessary planning, building regulations, listed buildings or other consents have been obtained. We endeavour to make our details accurate and reliable, but they should not be relied on as statements or representations of fact and they do not constitute any part of an offer or contract. The seller does not give any warranty in relation to the property and we have no authority to do so on their behalf.