



Furze Croft, Furze Hill, Hove, BN3 1PB  
**£300,000 - £325,000 Guide**



**GOLDIN  
LEMCKE**

01273 777123  
GOLDINLEMCKE.COM

SELLING HOMES  
IN BRIGHTON  
& HOVE  
SINCE 2002



# Furze Croft, Furze Hill, Hove, BN3 1PB

**£300,000 - £325,000 Guide**

A delightful two-bedroom ground floor flat, located in the extremely sought-after Art Deco Furze Croft building in central Hove. Overlooking well-maintained communal gardens and situated in this popular location, early and internal inspection is highly recommended.







## Further Information

**\*\*£300,000 - £325,000 GUIDE PRICE\*\*** A delightful two-bedroom ground floor flat, located in the extremely sought-after Art Deco Furze Croft building in central Hove. Overlooking well-maintained communal gardens and situated in this popular location, early and internal inspection is highly recommended.

This wonderful ground floor flat is accessed through an impressive communal entrance with original period details. Internally, the accommodation comprises a spacious hallway with built-in storage, bright and spacious living room with feature fireplace, kitchen with integrated appliances, bathroom, and two double bedrooms complete with built-in storage. The communal gardens at the front and back of the building are a standout feature, offering a peaceful setting with mature trees and plants.

Furze Croft is ideally situated on Furze Hill, close to St Ann's Well Gardens with its café and tennis courts. The property is within easy reach of Western Road's shops, the seafront, and Churchill Square shopping centre. Brighton railway station is also nearby, offering excellent links to London and beyond.

**GOLDINLEMCKE**

**01273 777123**  
GOLDINLEMCKE.COM

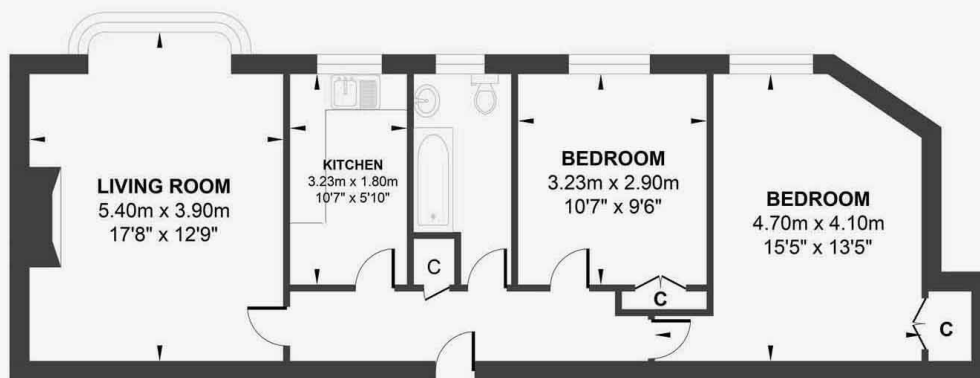

GROUND FLOOR

**Approximate Floor Area**  
664.99 sq ft  
(61.78 sq m)



**GOLDIN  
LEMCKE**

01273 777123  
GOLDINLEMCKE.COM

## SELLING SOMETHING SIMILAR?

Get in touch for a free, no obligation valuation.

Call 01273 777123 or email [property@goldinlemcke.com](mailto:property@goldinlemcke.com)

The above information has been provided by the vendor in good faith, but will need verification by the purchaser's solicitor. Any areas, measurements or distances referred to are given as a guide only and are not precise. Floor plans are not drawn to scale and are provided only to help illustrate the general layout of the property. The mention of any appliances and/or services in this description does not imply that they are in full and efficient working order and prospective purchasers should make their own investigations before finalising any agreement to purchase. It should not be assumed that any contents, furnishings or other items shown in photographs (which may have been taken with a wide angle lens) are included in the sale. Any reference to alterations to, or use of, any part of the property is not a statement that the necessary planning, building regulations, listed buildings or other consents have been obtained. We endeavour to make our details accurate and reliable, but they should not be relied on as statements or representations of fact and they do not constitute any part of an offer or contract. The seller does not give any warranty in relation to the property and we have no authority to do so on their behalf.

Energy Efficiency Rating		
	Current	Potential
Very energy efficient - lower running costs		
(92 plus) <b>A</b>		
(81-91) <b>B</b>		
(69-80) <b>C</b>		
(55-68) <b>D</b>		
(39-54) <b>E</b>		
(21-38) <b>F</b>		
(1-20) <b>G</b>		
Not energy efficient - higher running costs		
<b>England &amp; Wales</b>	EU Directive 2002/91/EC	

SELLING HOMES  
IN BRIGHTON  
& HOVE  
SINCE 2002