



sparks ellison

Church View, 41 Hursley Road, Chandler's Ford, SO53 2FS

£700,000

A magnificent double fronted character residence affording spacious well proportioned rooms with high ceilings which still retain much of their original charm and character. The property commences with an impressive 20'1" reception hall leading to three reception rooms and a re-fitted 19' x 13' kitchen/breakfast room. On the first floor are four double bedrooms, re-fitted en-suite and family bathroom. The property also benefits from a 27'8" garage and rear garden measuring approximately 70' in length. Church View is conveniently situated within walking distance to a range of local shops on Hursley Road, Chandlers Ford railway station, local schooling, with the centre of Chandlers Ford a short distance away. The property is also offered for sale with no forward chain.

ACCOMMODATION

Ground Floor

Entrance Porch:

Tiled floor, stained glass front door.

Reception Hall:

20'1" x 6'8" (6.12m x 2.03m) Stairs to first floor.

Cloakroom:

White suite comprising wash basin, wc.

Sitting Room:

17'8" x 12'2" (5.38m x 3.71m) Bay window, fireplace.

Dining Room:

16'8" x 12'3" (5.08m x 3.73m) Bay window, fireplace.

Family Room:

13'2" x 12'3" (4.01m x 3.73m) Stained glass double doors to conservatory.

Kitchen/Breakfast Room:

19'3 x 13' (5.79m x 3.96m) Re-fitted range of modern cream shaker style units with granite worksurfaces over, island unit incorporating breakfast bar and four stools, electric double oven, gas hob with extractor hood over, integrated wine cooler and washing machine, free standing fridge/freezer and dishwasher to remain, boiler, tiled floor, double doors to rear garden.

Conservatory:

20'10" x 12'10" x 9'3" (6.35m x 3.91m x 2.82m) Tiled floor, radiator, double doors to outside.

First Floor

Landing:

21'11" x 6'8" (6.68m x 2.03m) Stained glass window to front, hatch to loft space.

Bedroom 1:

15'5" x 12'4" (4.70m x 3.76m) Bay window.

En-Suite Shower Room:

Brand new white suite comprising double width walk in shower cubicle with glazed screen, wash basin with cupboard under, wc, tiled walls and floor.

Bedroom 2:

16'3" x 12'2" (4.95m x 3.71m) Two double wardrobes, bay window, stripped wooden floor.

Bedroom 3:

13'2" x 12'3" (4.01m x 3.73m) Stripped wooden floor.

Bedroom 4:

13' x 9'11" (3.96m x 3.02m) Cast iron fireplace, airing cupboard.

Bathroom:

9' x 5'8" (2.74m x 1.73m) White suite comprising bath with mixer tap and shower attachment, separate shower unit over, wash basin, wc, tiled floor.

Loft Room:

20' x 15'6" (6.10m x 4.72m) Access via loft ladder with Velux windows in the roof.

OUTSIDE

Front:

To the front of the property is a lawned area with flower and shrub borders enclosed by low level retaining wall, pathway to front door, brick paved driveway affording off street parking, side access to rear garden, electric vehicle charging point.

Rear Garden:

Approximately 70' in length with a good sized lawn and patio surrounded by mature flower and shrub borders, enclosed by hedging and fencing affording a private environment.

Garage:

27'8" x 8'9" (8.43m x 2.67m) Light and power, electric remote retractable parking ramp.

OTHER INFORMATION

Tenure:

Freehold

Approximate Age:

1896

Approximate Area:

228sqm/2455sqft (including garage)

Sellers Position:

No forward chain

Heating:

Gas central heating

Windows:

Sash windows with majority being secondary glazed

Loft Space:

Partially boarded with ladder and light connected, radiator

Infant/Junior School:

Chandlers Ford Infant School / Merdon Junior School

Secondary School:

Toynbee Secondary School



Ground Floor = 1285 sq ft / 119.3 sq m
 First Floor = 928 sq ft / 86.2 sq m
 Garage = 242 sq ft / 22.5 sq m
 Total = 2455 sq ft / 228 sq m
 For identification only - Not to scale

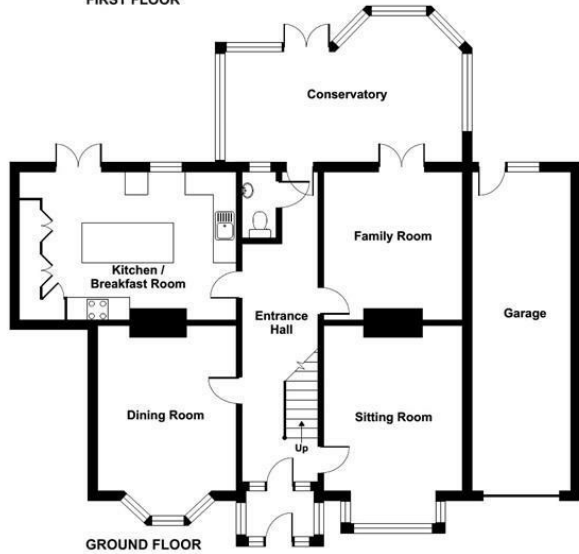
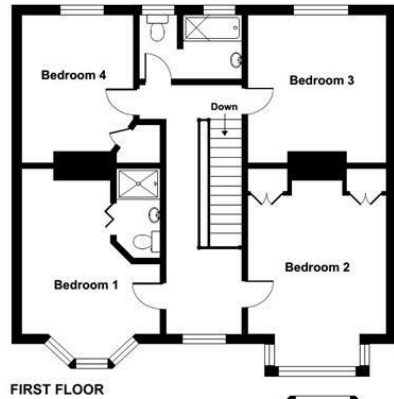

Energy Efficiency Rating		
	Current	Potential
Very energy efficient - lower running costs		
(92 plus) A		
(81-91) B		
(69-80) C		
(55-68) D		
(39-54) E		
(21-38) F		
(1-20) G		
Not energy efficient - higher running costs		
England & Wales	60	74
	EU Directive 2002/91/EC	

Floor plan produced in accordance with RICS Property Measurement Standards incorporating International Property Measurement Standards (IPMS2 Residential). © nichecom 2023. Produced for Sparks Ellison. REF: 1001881

94 Winchester Road, Chandler's Ford, Hampshire, SO53 2GJ

Sales: t: 02380 255333 e: property@sparksellison.co.uk
 Lettings: t: 02380 018518 e: lettings@sparksellison.co.uk



While we endeavour to make our sales particulars fair, accurate and reliable, they are only a general guide to the property and, accordingly, if there is any point which is of particular importance to you please contact the office and we will be pleased to check it for you, especially if you are contemplating travelling some distance to view the property. These approximate room sizes are only intended as general guidance. You must verify the dimensions carefully before ordering carpets or any built in furniture. Please note we have not tested the services or any of the equipment or appliances in this property, accordingly we strongly advise prospective buyers to commission their own survey or service report before finalising their offer to purchase. These particulars are issued in good faith but do not constitute representations of fact or form part of any offer or contract. The matters referred to in these particulars should be independently verified by prospective buyers or tenants. Neither Sparks Ellison nor any of its employees or agents has any authority to make or give any representation or warranty whatever in relation to this property. Your home is at risk if you do not keep up repayments on a mortgage or other loan secured on it. Written quotations available on request. All loans secured on property. Life assurance usually required.

