



Adstone Road | Caddington  
£449,950

Town & Country

- Detached Bungalow
- Two Double Bedrooms with options of a Third
- Large Lounge with Feature Fireplace
- Fitted Kitchen
- Utility Space
- Four Piece Bathroom
- Double Glazed and Central Heating
- South Facing Rear Garden
- Parking For Numerous Vehicles
- Must be Viewed

This fantastic Two Bedroom Extended Detached Bungalow is situated within Caddington village, near Luton and Harpenden. The property has been greatly extended to the rear and side and offers several fantastic features. It has a large 4-piece Bathroom with a bath and large shower cubicle, an extended Fitted Kitchen and the Lounge is 20ft with a tasteful Feature Fireplace. There are Two Double Bedrooms and the Entrance Way could be easily converted to 3rd bedroom if required. Externally there is a South Facing Rear Garden with Workspace and a large Driveway to the front with parking for numerous vehicles. Located within walking distance to local shops and bus routes (via Elm Avenue).

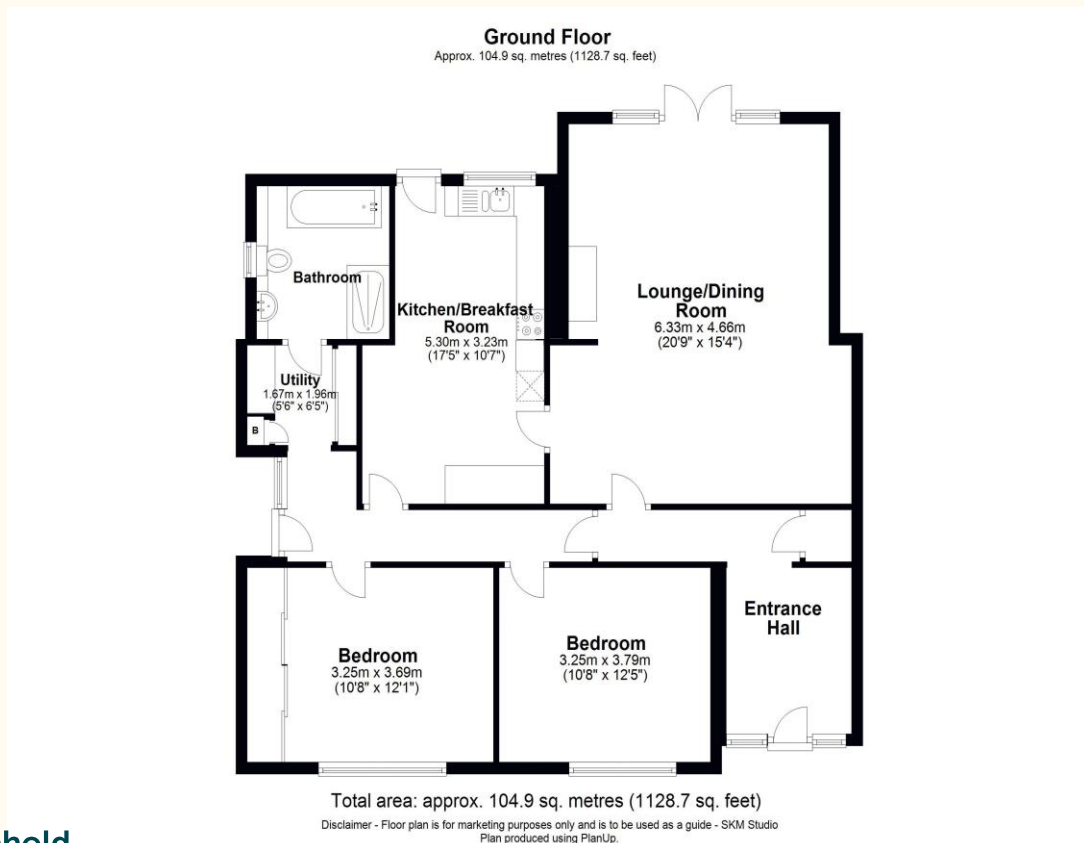

**Tenure: Freehold**

**EPC Rating: C**

**Council Tax Band: E**

**Local Authority:**

IMPORTANT: we would like to inform prospective purchasers that these sales particulars have been prepared as a general guide only. A detailed survey has not been carried out, nor the services, appliances and fittings tested. Room sizes should not be relied upon for furnishing purposes and are approximate. If floor plans are included, they are for guidance only and illustration purposes only and may not be to scale. If there are any important matters likely to affect your decision to buy, please contact us before viewing the property.

1 Manor Road, Caddington, Bedfordshire, LU1 4EE  
T: 01582 841 200  
E: sales@towncountry.uk.net  
W: www.towncountry.uk.net

**Town &  
Country**