



176 Beaconsfield Road, London, SE9 4DX

£465,000

- 15'2 Reception Room
- Two Double Bedrooms
- Summer House
- 13'1 Modern Kitchen
- Stunning Outside Space
- Off Street Parking

176 Beaconsfield Road, London SE9 4DX

Simply stunning two bedroom extended end of terrace family home. Situated on a corner plot with further scope to extend (STPP). Boasts a 15'2 reception room, 13'1 modern kitchen breakfast bar, two double bedrooms (main bedroom has walk in wardrobe) and a modern family bathroom. Externally the benefits keep on coming with a summer house (previously a garage) with power and light, lovely seating area with outside kitchen and a barbecue area. This beautiful home has been meticulously updated and maintained and should be top of your viewing list!



Council Tax Band: C



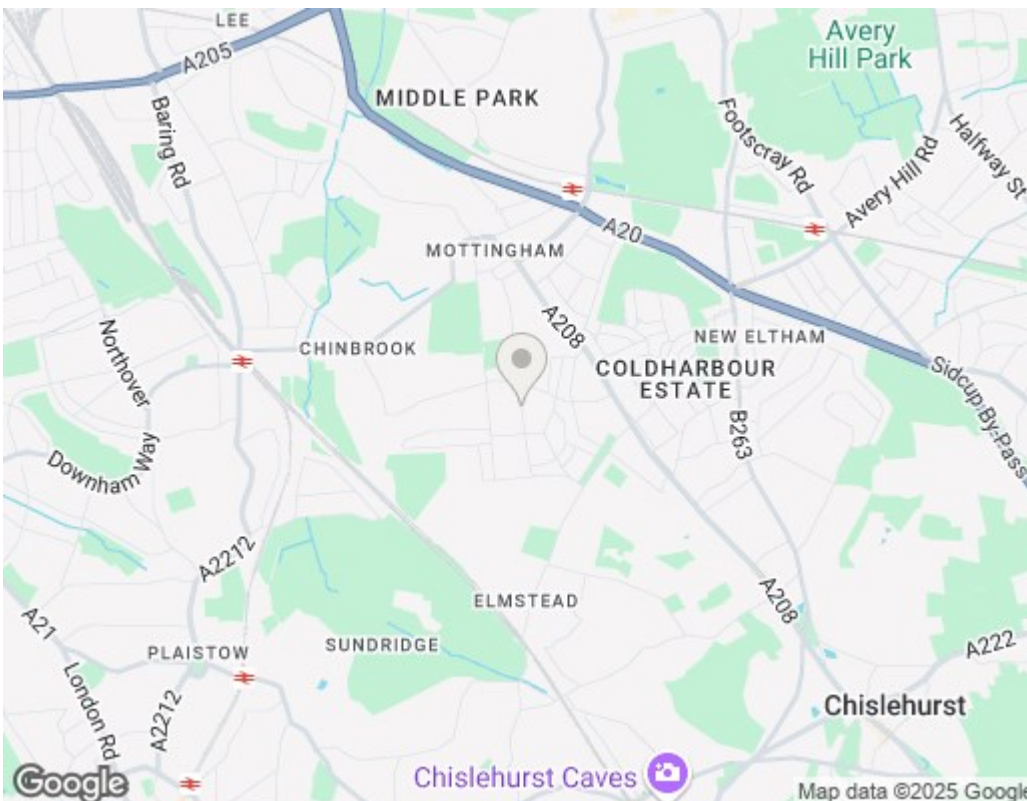
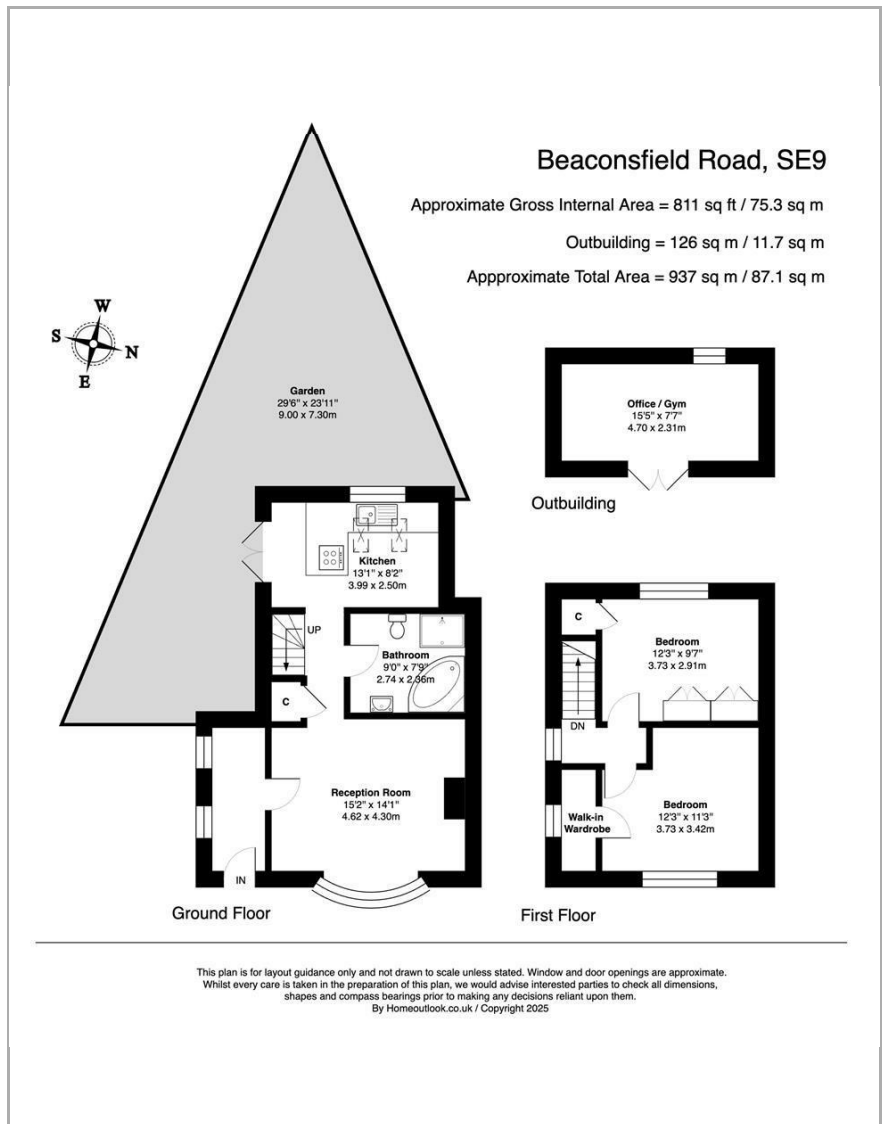

Viewings

Viewings by arrangement only.
Call 0208 859 1100 to make an appointment.

EPC Rating:

D

Energy Efficiency Rating		Current	Potential
Very energy efficient - lower running costs			
(92 plus) A			
(81-91) B			
(69-80) C			
(55-68) D			
(39-54) E			
(21-38) F			
(1-20) G			
Not energy efficient - higher running costs			
England & Wales		62	80
		EU Directive 2002/91/EC	