



181 White Horse Hill, Chislehurst, BR7 6DH

£300,000

- Two Bedrooms
- Off Street Parking
- Own Rear Garden
- 125 Year Lease
- Ground Floor Maisonette
- EPC Rating = D

181 White Horse Hill, Chislehurst BR7 6DH

A delightful TWO BEDROOM GROUND FLOOR MAISONETTE offered onto the market with no onward chain. The property does require some updating but does offer lots of tempting features including two well proportioned bedrooms, a 16'4 reception room, off street parking, lawned front garden and a generous lawned rear garden and patio. The property will be sold with a new lease with circa 125 years. We hold keys.

Tenure - Leasehold - New Lease of 125 years to be granted on completion

Service Charge - As and when work required

Ground Rent - £100.00 PA

Council Tax - Bromley Band C



Council Tax Band:



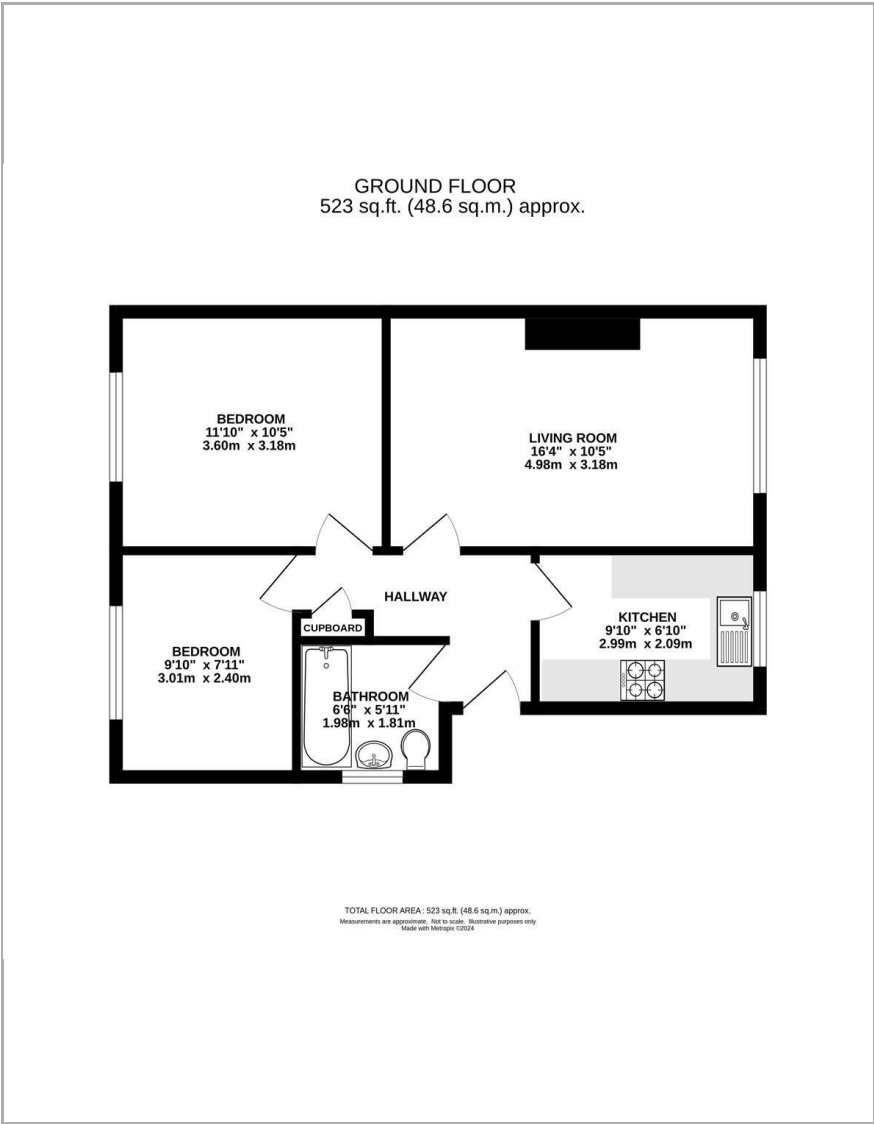
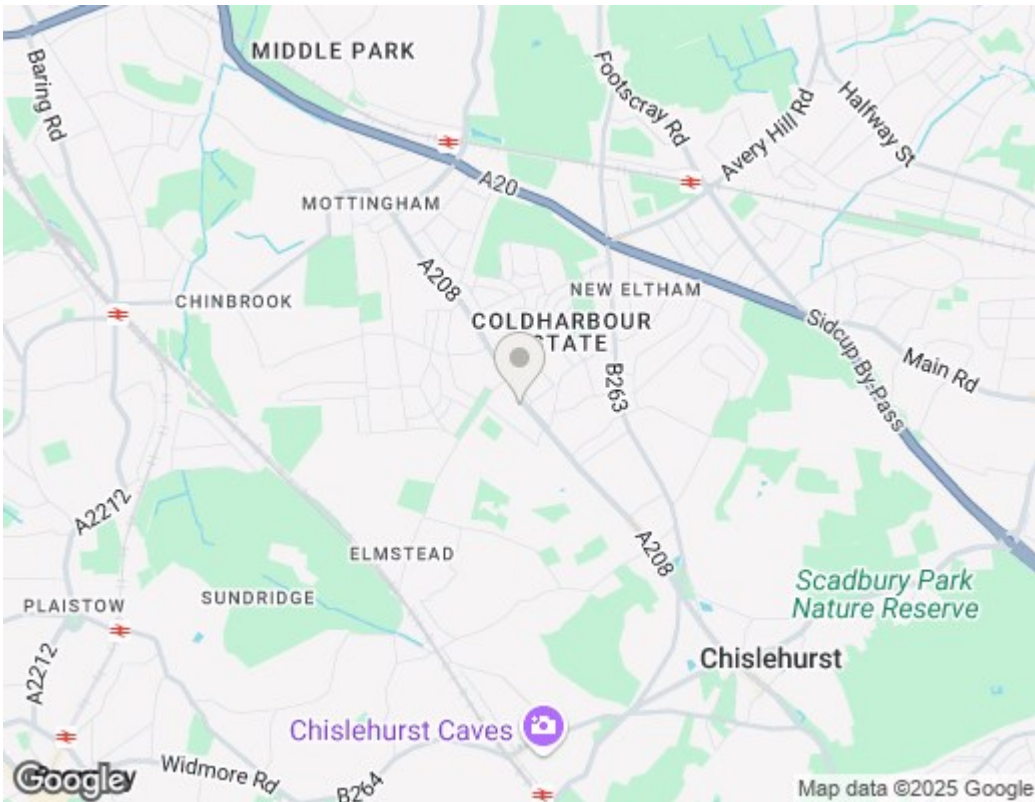

Viewings

Viewings by arrangement only.
Call 0208 859 1100 to make an appointment.

EPC Rating:

D

Energy Efficiency Rating		
	Current	Potential
Very energy efficient - lower running costs		
(92 plus) A		
(81-91) B		
(69-80) C		
(55-68) D		
(39-54) E		
(21-38) F		
(1-20) G		
Not energy efficient - higher running costs		
England & Wales	60	76
		EU Directive 2002/91/EC