

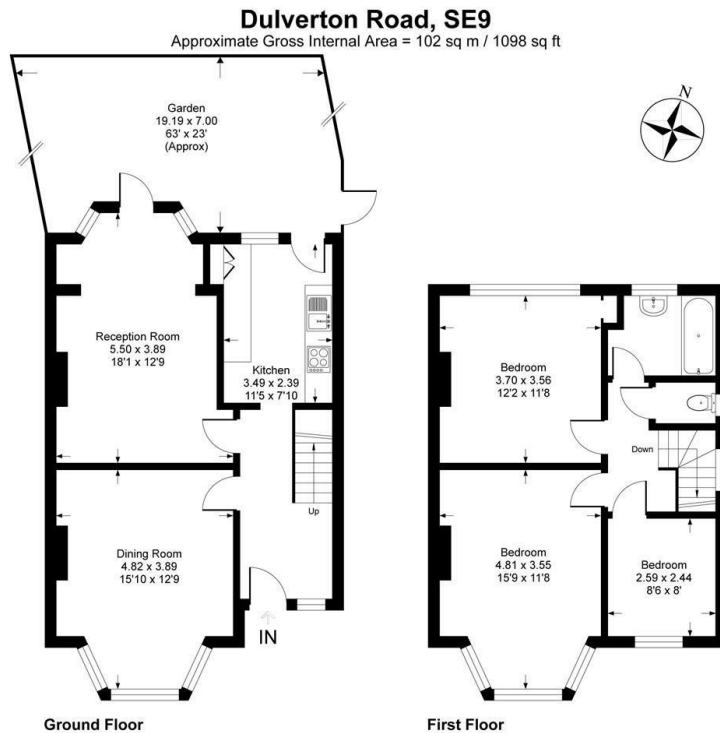

118 Dulverton Road, London, SE9 3RL

Offers Over £600,000

- Bexley Borough
- Double Glazed
- Popular Location
- Freehold
- Three Good Size Bedrooms
- Gas Fired Central Heating
- Walking Distance To New Eltham Station
- Two Reception Rooms
- Off Street Parking For Two Cars
- Council Tax Band E



This plan is for layout guidance only. Not drawn to scale unless stated. Windows and door openings are approximate. Whilst every care is taken in the preparation of this plan, please check all dimensions, shapes and compass bearings before making any decisions reliant upon them.
Produced by Planpix

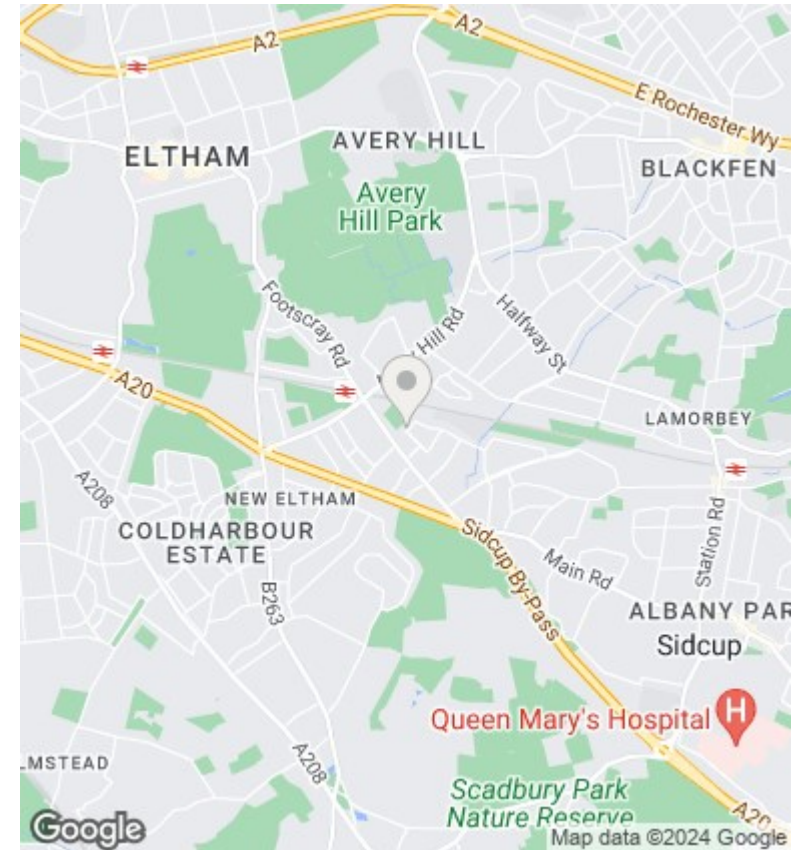

Directions

Viewings

Viewings by arrangement only. Call 0208 859 1100 to make an appointment.

Council Tax Band

E

EPC Rating:

E

Energy Efficiency Rating		Current	Potential
<i>Very energy efficient - lower running costs</i>			
(92 plus)	A		87
(81-91)	B		
(69-80)	C		
(55-68)	D	53	
(39-54)	E		
(21-38)	F		
(1-20)	G		
<i>Not energy efficient - higher running costs</i>			
England & Wales		EU Directive 2002/91/EC	