



97 Parkview Road, New Eltham, London, SE9 3QR

Offers Over £350,000

- STUNNING 1ST FLOOR MAISONETTE
- OWN REAR GARDEN
- SPACIOUS LOUNGE
- TWO BEDROOMS
- SHARE OF FREEHOLD
- MINUTES WALK TO STATION
- MODERN FITTED KITCHEN
- TASTEFULLY DECORATED THROUGHOUT
- NOT TOO BE MISSED

Park View Road, SE9

Approximate Gross Internal Area
61.4 sq m / 661 sq ft

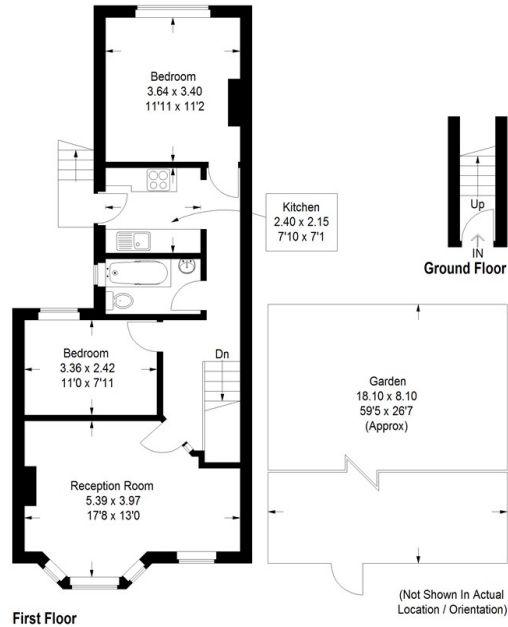
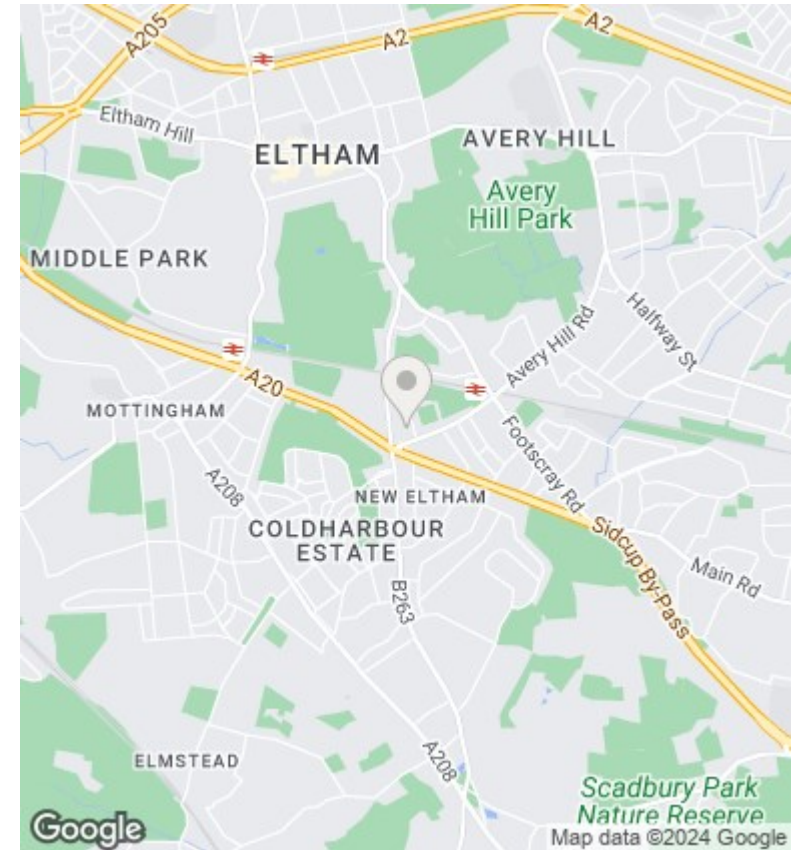

Illustration for identification purposes only, measurements are approximate, not to scale. (ID546600)



Directions

Viewings

Viewings by arrangement only. Call 0208 859 1100 to make an appointment.

Council Tax Band

C

EPC Rating:

D

Energy Efficiency Rating		Current	Potential
<i>Very energy efficient - lower running costs</i>			
(92 plus)	A		
(81-91)	B		77
(69-80)	C		
(55-68)	D	64	
(39-54)	E		
(21-38)	F		
(1-20)	G		
<i>Not energy efficient - higher running costs</i>			
England & Wales		EU Directive 2002/91/EC	