

Loulé · Algarve

APPROVED PROJECT IN THE HILLS



Mapro Sociedade Mediação Imobiliária Lda.

Edifício Mapro · Av. Alm. Mendes Cabeçadas · 8135-106 Almancil · Algarve, Portugal
Tel. (+351) 289 390 880 · info@maprorealestate.com
AMI License 317
www.maprorealestate.com

MAPRO | **Knight Frank**
REAL ESTATE · IMOBILIÁRIA



APPROVED PROJECT IN THE HILLS

An elevated plot with an approved project, situated in the Loulé hills features breathtaking 360° views to the ocean and surrounding countryside.

The project is for a three bedroom villa ensuite with a traditional style. The ground floor comprises a bright and spacious kitchen and dining area, a large living room, a separate laundry room, an office and WC. The lower level incorporates natural light allowing for the possibility of having a fourth bedroom. This level also includes the double garage and there is plenty of parking area.

The terraces are covered with a BBQ area and the swimming pool is south facing. The roof terrace boasting the beautiful country and sea views is accessed off the pool terrace.

The plot is located only 10min away from all the main amenities, and has great accessibility by road.

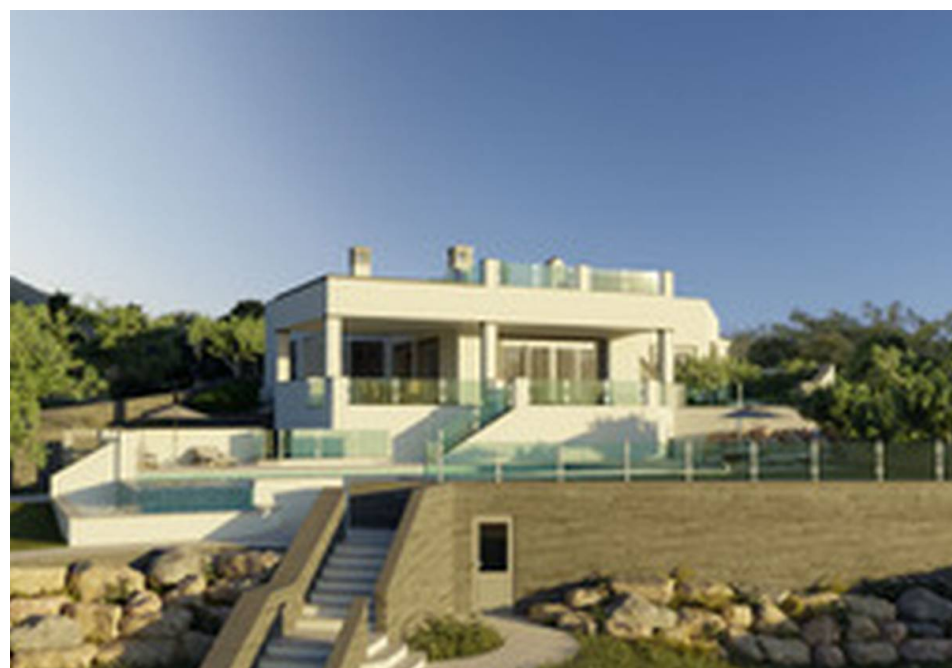



€ 400.000

PRICE

REF 3334

FACTS & FEATURES



352m²



1687m²



N/A



N/A

Ownership: Private

Garden Project

Swimming Pool Project

Views Countryside, Sea

Beach 16Km

Golf 10Km

Airport 24Km



IMPORTANT NOTICE: These details are guidelines only. They do not form part of any contact and may change at any time without prior notice.

