



Abercorn Place, St John`s Wood, NW8 £1,850 Per Month Furnished

Only Moments from the famous Abbey Road, we are delighted to offer this well-designed apartment arranged on the 4th floor (with lift) in this noted and extremely popular purpose-built block in St Johns Wood.

The apartment comprises a bright reception, fully fitted kitchen, double bedroom, and tiled bathroom. Further benefits include a porter, communal garden, cycle store, and communal heating and hot water, which are included in the rent.

Abercorn Place is ideally located between both St John`s Wood (Jubilee Line) and Maida Vale (Bakerloo Line) as well as a great selection of shops and bus links on your doorstep.



Fourth Floor

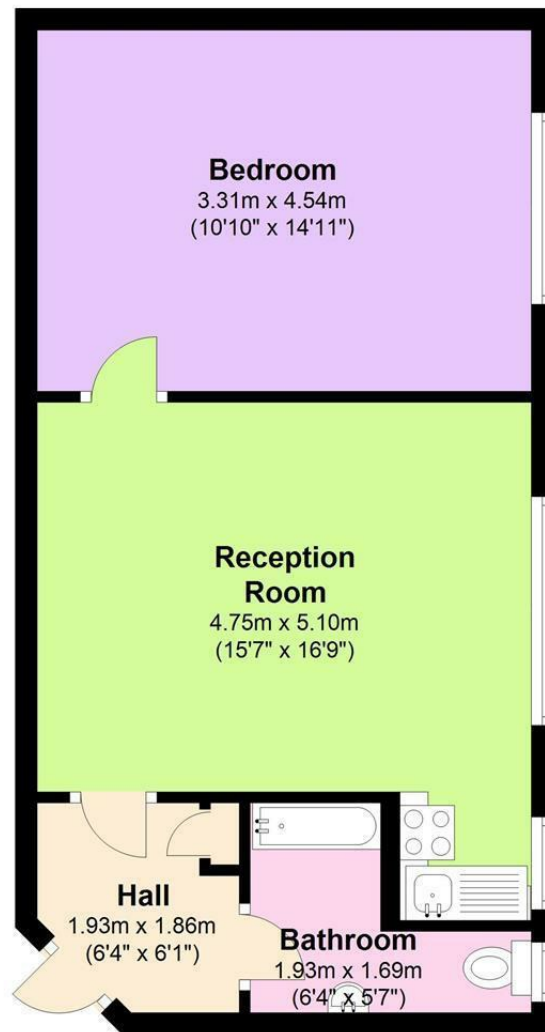

Property Overview

| | |
|------------|---------------------|
| Location | St John`s Wood, NW8 |
| Price | £1,850 Per Month |
| Bedrooms | 1 |
| Bathrooms | 1 |
| Receptions | 1 |
| Council | Westminster |
| Tax Band | D |
| Furnishing | Furnished |

Key Features

- Double Bedroom
- Bright & Spacious
- Rent includes Heating & Hot Water
- Communal Garden
- Passenger Lift
- Cycle Store
- Porter & Lift
- Furnished

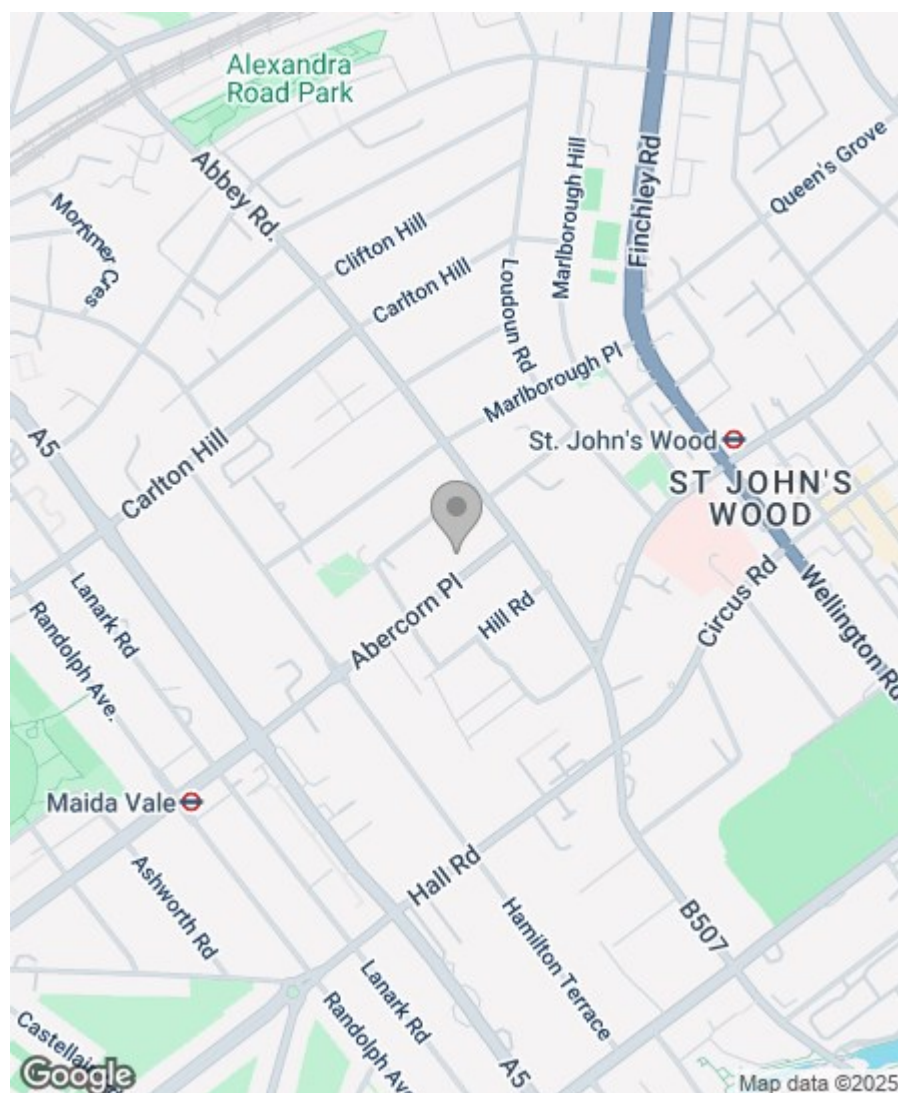

Energy Efficiency Rating

| | Current | Potential |
|---------------------------------------------|---------------------------------------------------------------------------------------------------------------|-----------|
| Very energy efficient - lower running costs | | |
| (92 plus) A | | |
| (81-91) B | | |
| (69-80) C | | |
| (55-68) D | | |
| (39-54) E | | |
| (21-38) F | | |
| (1-20) G | | |
| Not energy efficient - higher running costs | | |
| | 66 | 72 |
| England & Wales | EU Directive 2002/91/EC  | |

Greenstones Estates Ltd
Registered in England & Wales
Registered Office:
5 West Court, Enterprise Road,
Maidstone, Kent ME15 6JD

Company Registered number
03513585

Trading address
83 Boundary Road, St John's Wood,
London NW8 0RG

We are members of



IMPORTANT NOTICE: All of the information is intended only as a guide to a prospective purchaser and does not constitute any part of an offer or contract. Any measurements or distances referred to herein are approximate only. Any information contained herein (whether in the text, plans or photographs) is given in good faith and cannot be relied upon as being a statement or representation of fact. Should you proceed with the purchase of the property, your solicitor must verify these details. We have not carried out a detailed survey nor tested the services, appliances and specific fittings. In accordance with current legislation we would advise you that the measurements on these particulars are imperial. The formula for conversion to metric is as follows:- 1' (one foot) = 30.4cm (centimetres), 1m (one metre) = 3'29 (feet).