

Approx Gross Floor Area = 872 Sq. Feet

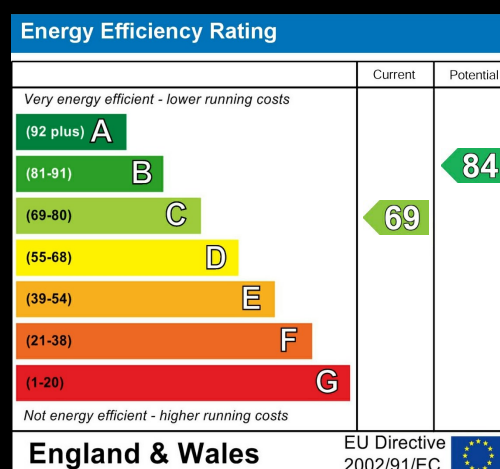

Newton Road |
Asking Price £425,000

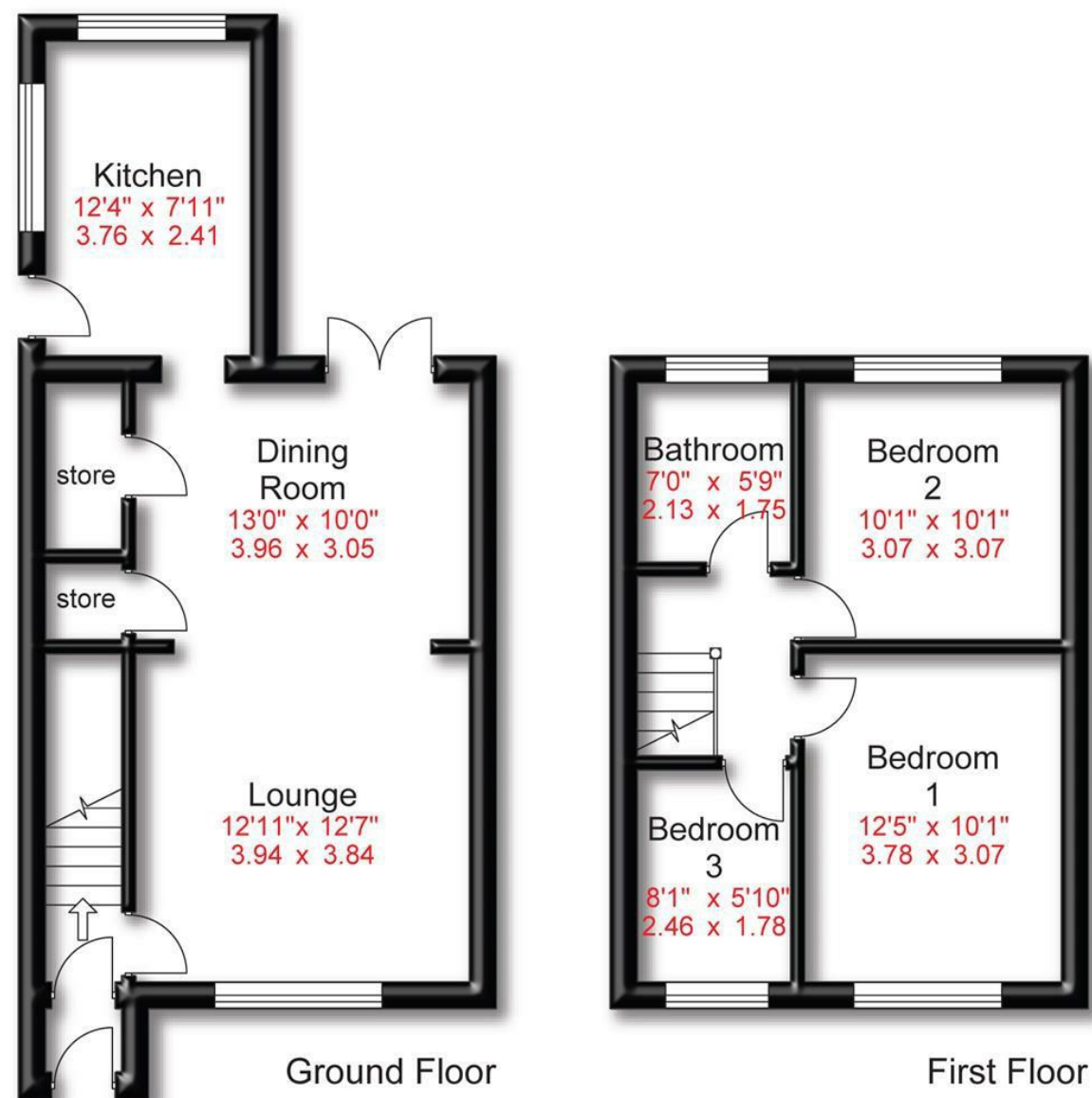

SALES & LETTINGS

175 Ashley Road | Hale | WA15 9SD
t: 0161 928 9355
e: info@hibberthomes.com
www.hibberthomes.com

Bedrooms 3



Bath 1



Reception 2



Driveway



Area
872.00 sq ft



- Three Bedrooms
- Five Minutes Walk to Metrolink Station
- Driveway Parking
- Potential to Add Value / Extend
- Private Rear Garden
- Short Walk to Altrincham Town Centre
- In Catchment for Trafford's Outstanding Schools
- Cul-De-Sac Location Next to Park

A well presented Three Bedroom End Terrace Home, located within five minutes walk to Navigation Road Metrolink Station, Navigation Road School and just ten minutes walk into Altrincham town centre.

The property comprises, entrance porch and hallway, large open plan lounge / dining room with two storage cupboards and French doors leading into the private rear garden and a good size fully fitted kitchen. To the first floor, there are three bedrooms, the main two benefit from fitted wardrobes and a family bathroom.

To the front of the property there is drive allowing parking for two vehicles off-road. The drive is open to the front aspect and enclosed by timber panelled fencing on either side. To the rear there is a good size private garden, mainly laid to lawn with decked and gravelled areas.

A great family home that must be viewed situated right next to the park!

