

Approx Gross Floor Area = 790 Sq. Feet  
= 73.5 Sq. Metres

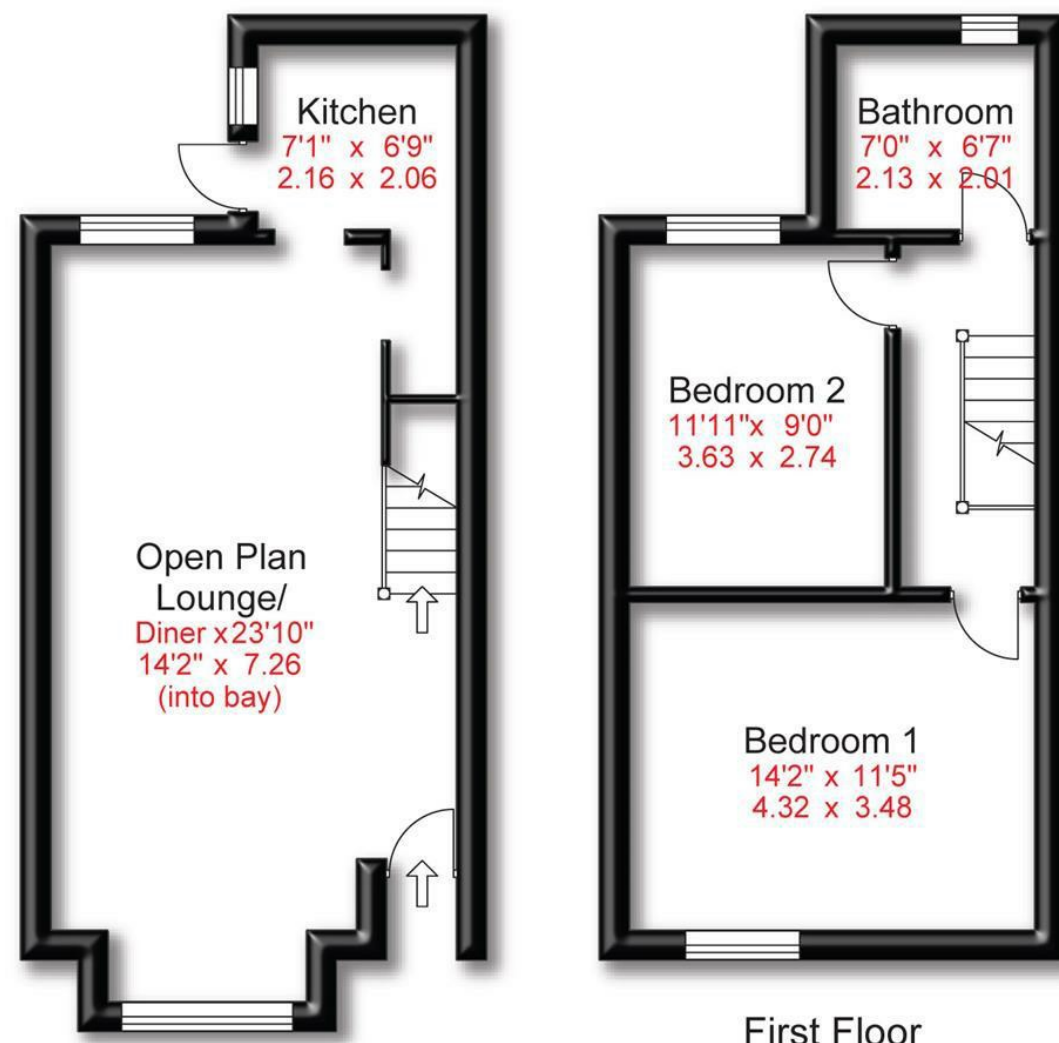

First Floor

Ground Floor

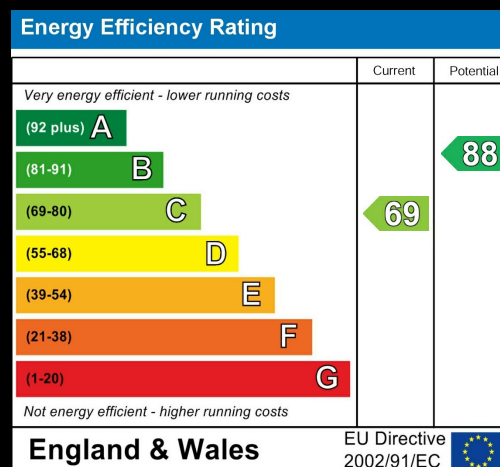

Bold Street |

Asking Price £375,000



SALES & LETTINGS

175 Ashley Road | Hale | WA15 9SD  
t: 0161 928 9355  
e: info@hibberthomes.com  
www.hibberthomes.com

Bedrooms 2

Bath 1

Reception 2

Permit Parking

Area  
790.00 sq ft

No Chain

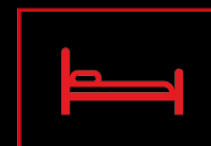



- Period Property
- Two Bedrooms
- Great Location
- No Chain

- Open Plan Lounge/Diner
- Permit Parking
- One Bathroom

A well presented bay fronted Victorian terraced property on the ever so popular "B-streets" within walking distance to Hale village, Altrincham town centre and various transport links. The property is nicely presented throughout comprising; open plan lounge & dining room and kitchen to the ground floor. Two double bedrooms and a modern bathroom to the first floor. Externally to the rear is a low maintenance courtyard. Permit Parking. No Chain.

