

Approx Gross Floor Area = 1204 Sq. Feet

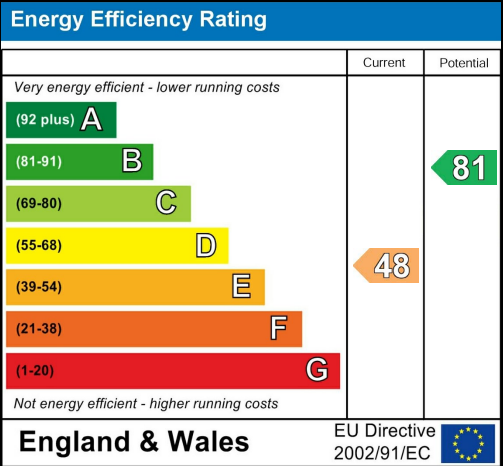

Moss Lane | Hale

Asking Price £415,000

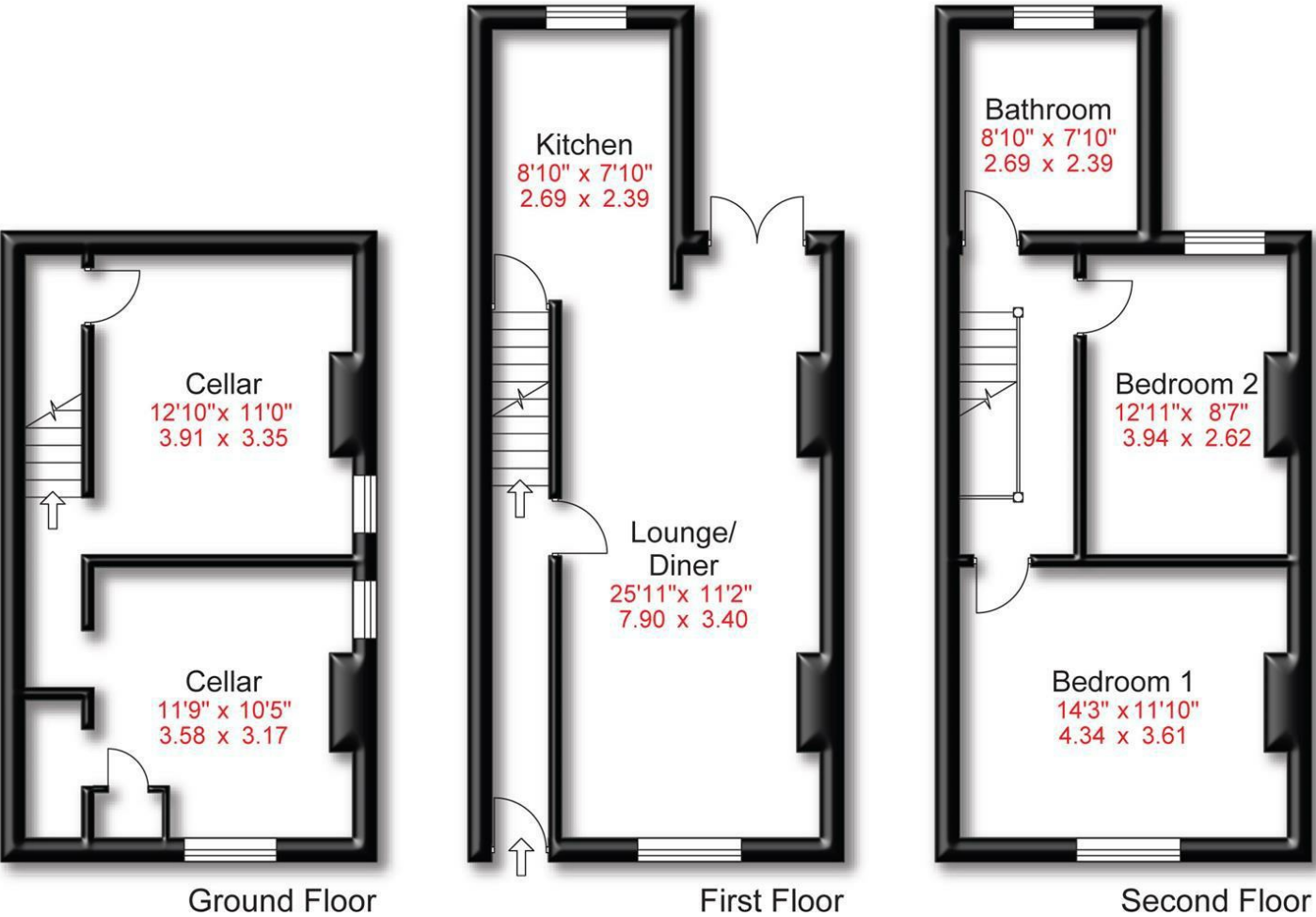

175 Ashley Road | Hale | WA15 9SD
t: 0161 928 9355
e: info@hibberthomes.com
www.hibberthomes.com



- End Terrace
- Large Open Plan Lounge/Diner
- Private Garden
- Close to Stamford Park and local schools
- Two Bedrooms
- Fantastic Location
- Converted Cellars
- Local Shops

Situated a stones throw from the beautiful Stamford Park and within walking distance of both Hale and Altrincham centres, this attractive two bedroom end terrace home benefits from spacious and ready to move into accommodation with partially converted cellars and a rear garden.

With popular local schools in abundance along with transport links to Manchester and Chester, this end terrace would be ideal for a wide range of buyers looking for a property which they can move straight into yet offering further potential to fully convert the two large cellar chambers. The accommodation on offer in brief comprises entrance hallway with stairs rising to the first floor, a large through lounge and dining room with attractive fireplace and double patio doors to the garden. The lounge/diner opens into a fully fitted modern kitchen with a range of integrated appliances and high gloss units. To the first floor there are two good size bedrooms and an attractive four piece bathroom. Externally the property benefits from an enclosed, lawned and decked rear garden to the rear whilst to the front is a wrought iron gate and low brick wall giving access to the front door. A viewing is highly recommended to appreciate both the amazing location and the space offered throughout.

