

Approx Gross Floor Area = 510 Sq. Feet

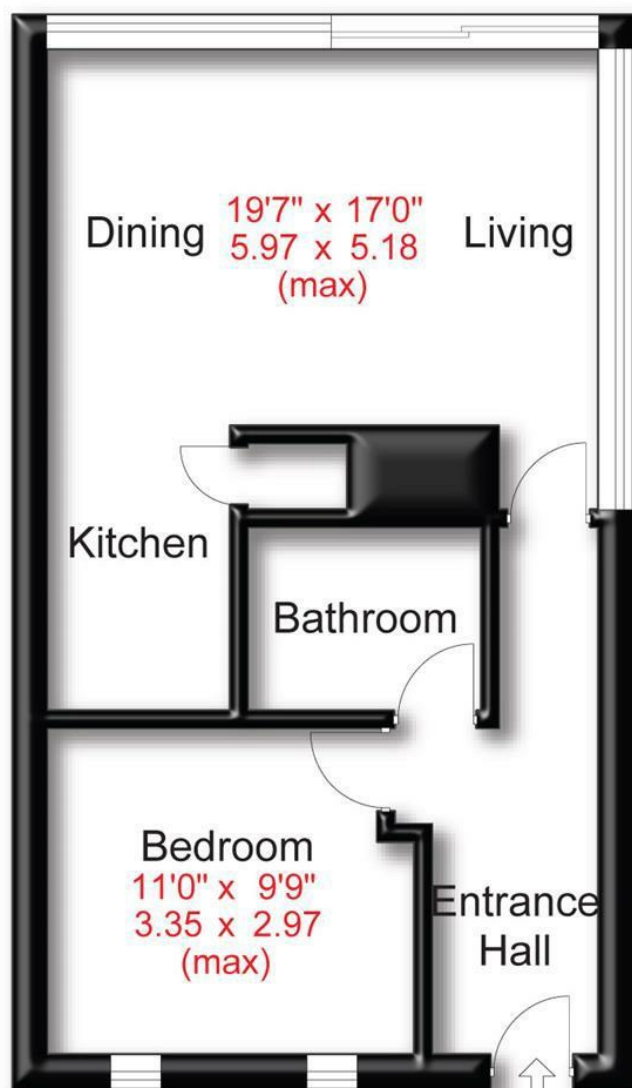

Ground Floor



Energy Efficiency Rating		
	Current	Potential
Very energy efficient - lower running costs		
(92 plus) A		
(81-91) B	78	78
(69-80) C		
(55-68) D		
(39-54) E		
(21-38) F		
(1-20) G		
Not energy efficient - higher running costs		
England & Wales	EU Directive 2002/91/EC	



Woodfield Road |
50% Shared Ownership
£90,000



175 Ashley Road | Hale | WA15 9SD
t: 0161 928 9355
e: info@hibberthomes.com
www.hibberthomes.com

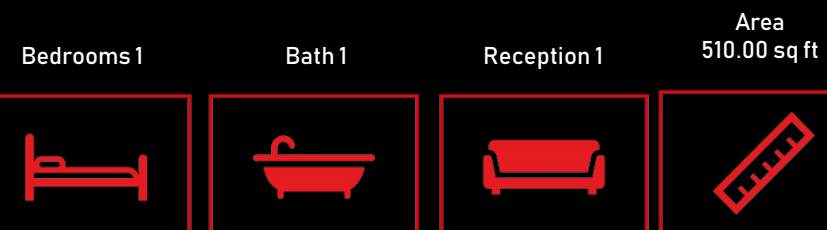

SALES & LETTINGS

- Ground Floor Apartment 50% Shared Ownership
- Large Outside Terrace
- Close to Altrincham Town Centre & Transport Links
- Leasehold 999 years from 1 January 2003, Council Tax Band D
- Gated Development
- One Bedroom
- Monthly Rent - £229.56 / Monthly Service Charge - £188.57
- Open-Plan Living/Dining Area And Fitted Kitchen
- 510 sqft
- Underground Parking £60 per month

50% Shared Ownership A one bedroom ground floor apartment located on Woodfield Road in the Budenberg development. This purpose-built property boasts a cosy dining/living room and kitchen, spacious bedroom and fully fitted bathroom. Outside there is a large private terrace area.

Situated in a sought-after area, this apartment is perfect for those looking for a convenient and comfortable living space. Whether you're a first-time buyer, a young professional, or someone looking to downsize, this property offers a great opportunity to own a piece of Altrincham.

Don't miss the chance to make this apartment your own and enjoy the convenience of living in this lovely town. Contact us today to arrange a viewing!

All potential purchasers must be approved via application to Riverside Home Ownership.

