

Approx Gross Floor Area = 722 Sq. Feet

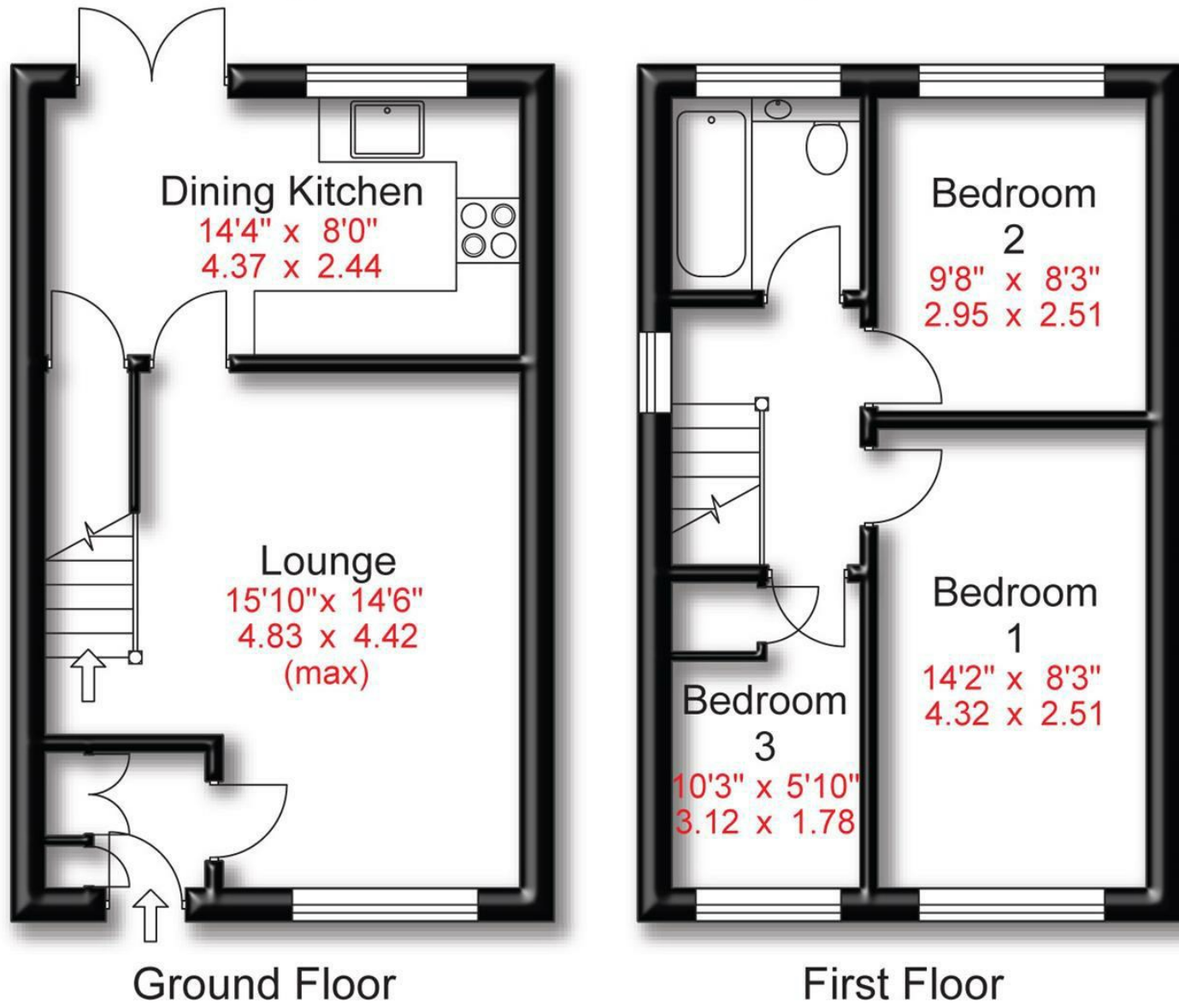

| Energy Efficiency Rating | | Current | Potential |
|---|--|-------------------------|-----------|
| Very energy efficient - lower running costs | | | |
| (92 plus) A | | | |
| (81-91) B | | | |
| (69-80) C | | | 73 |
| (55-68) D | | | |
| (39-54) E | | 31 | |
| (21-38) F | | | |
| (1-20) G | | | |
| Not energy efficient - higher running costs | | | |
| England & Wales | | EU Directive 2002/91/EC | |



Prestbury Avenue |
Asking Price £425,000



175 Ashley Road | Hale | WA15 9SD
t: 0161 928 9355
e: info@hibberthomes.com
www.hibberthomes.com

Bedrooms 3

Bath 1

Reception 1

Driveway

Area
722.00 sq ft

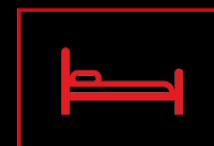

SALES & LETTINGS

- Newly Renovated Throughout Semi-Detached Home
- Semi-Detached Home
- Bathroom
- Great Location

- Open Plan Dining Kitchen
- Three Bedrooms
- 722 sqft
- Outstanding Local Schools and Local Amenities

A newly renovated throughout three bedroom modern semi-detached family home located within a popular neighbourhood, walking distance of excellent schools, transport links & Altrincham town centre. The property is arranged over two floors with the accommodation comprising of entrance porch, lounge, dining kitchen to the ground floor and three bedrooms and a fully fitted bathroom to the first floor. Externally, there is a driveway providing ample off road parking and good sized lawned gardens to the front and rear.

