

Approx Gross Internal Area
80 sq m / 856 sq ft

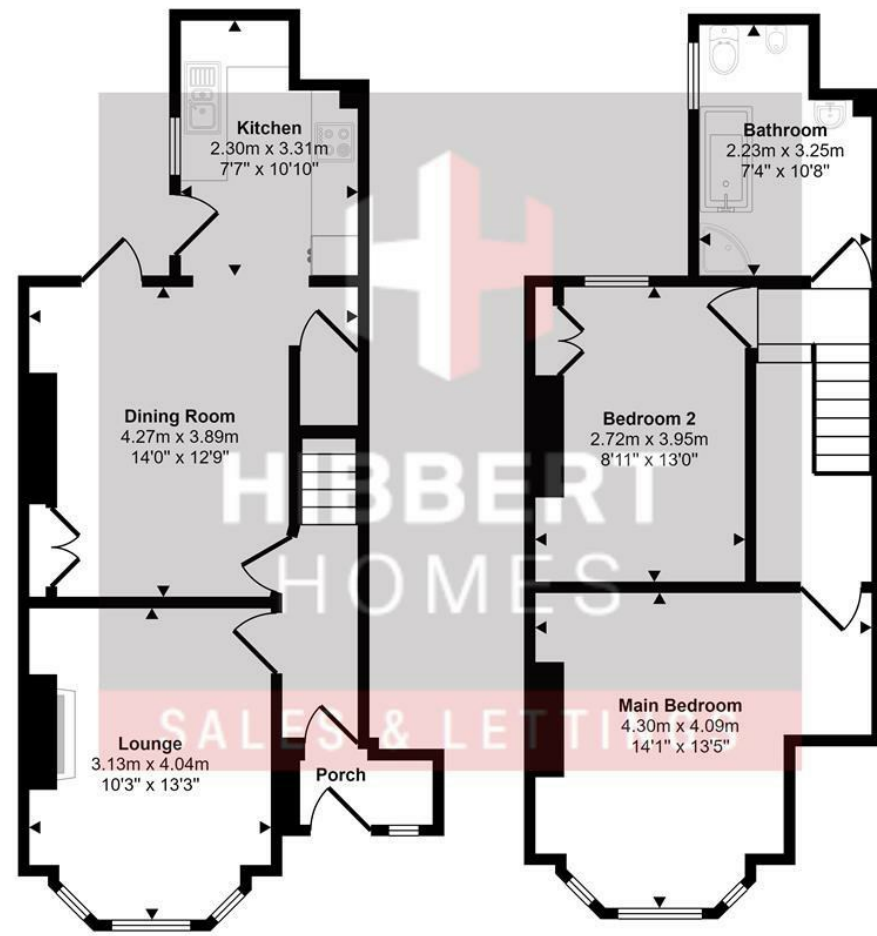

Ground Floor
Approx 41 sq m / 440 sq ft

First Floor
Approx 39 sq m / 415 sq ft

This floorplan is only for illustrative purposes and is not to scale. Measurements of rooms, doors, windows, and any items are approximate and no responsibility is taken for any error, omission or mis-statement. Icons of items such as bathroom suites are representations only and may not look like the real items. Made with Made Snappy 360.

Energy Efficiency Rating		
	Current	Potential
Very energy efficient - lower running costs		
(92 plus) A		
(81-91) B		82
(69-80) C		
(55-68) D	64	
(39-54) E		
(21-38) F		
(1-20) G		
Not energy efficient - higher running costs		
England & Wales	EU Directive 2002/91/EC	



Victoria Road | Hale
£1,600 PCM



175 Ashley Road | Hale | WA15 9SD
t: 0161 928 9355
e: info@hibberthomes.com
www.hibberthomes.com

SALES & LETTINGS

Bedrooms 2

Bath 1

Reception 2

Parking here

Area
856.00 sq ft

Available Now



- Two Double Bedrooms
- Integrated Kitchen
- Off Street Parking
- Newly Decorated Throughout
- Convenient Transport Links

- End Of Terrace Property
- Two Reception Rooms
- Secluded Courtyard Garden
- Prime Hale Location
- Local Amenities

A NEWLY DECORATED, TWO DOUBLE BEDROOM END OF TERRACE WITH DRIVEWAY & COURTYARD GARDEN..... A premium location, only a stones throw from Hale Village high street and within walking distance of Altrincham. Briefly comprising: Entrance vestibule and hallway. Lounge benefiting from an abundance of natural light through the large bay window. Separate dining room, leading into a modernised kitchen with integrated appliances. Secluded rear patio garden. From the dining room; stairs leading down to an unconverted basement, best used as storage. Stairs leading up to the first floor; Two generous double bedrooms. Large family bathroom with separate bath and walk in shower. GCH. Unfurnished. EPC Band - C. Council tax band - C. Available Now.

