

Approx Gross Floor Area = 750 Sq. Feet

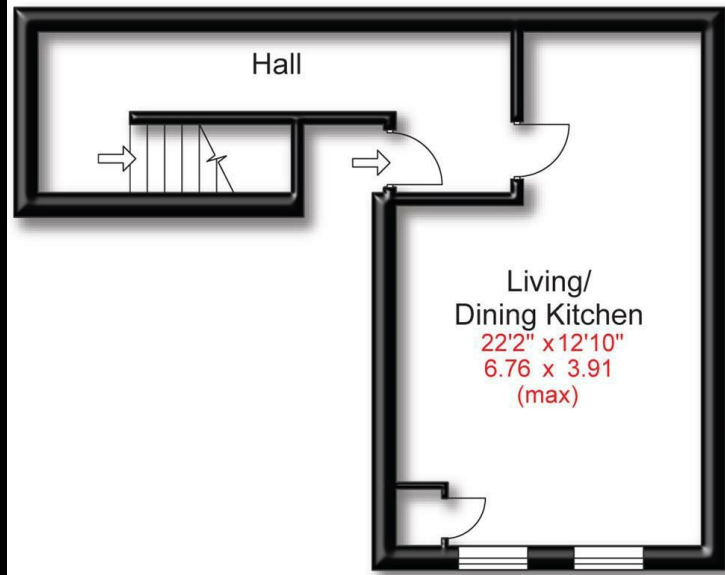

Ground Floor

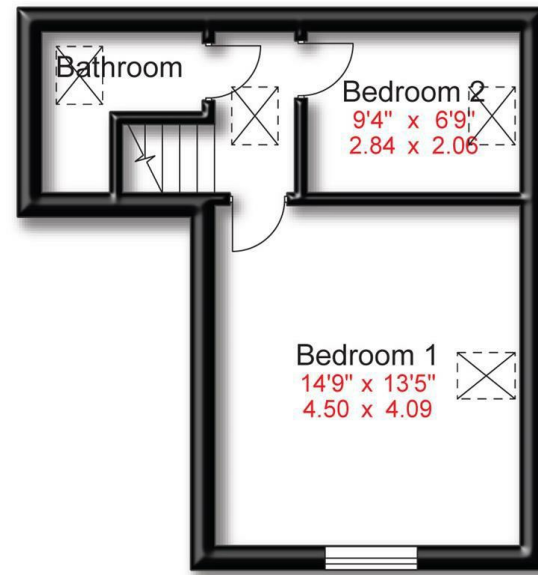

First Floor



Energy Efficiency Rating		
	Current	Potential
Very energy efficient - lower running costs		
(92 plus) A		
(81-91) B		
(69-80) C	71	79
(55-68) D		
(39-54) E		
(21-38) F		
(1-20) G		
Not energy efficient - higher running costs		
England & Wales	EU Directive 2002/91/EC	



St. Margarets Road  
Altrincham  
Asking Price £270,000



175 Ashley Road | Hale | WA15 9SD  
t: 0161 928 9355  
e: info@hibberthomes.com  
www.hibberthomes.com

SALES & LETTINGS

Bedrooms 2

Bath 1

Reception 1

Allocated Parking

750 Sq Ft

NO CHAIN

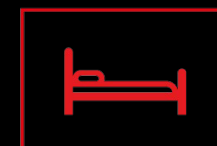

- 19th Century Mansion House
- Mature Communal Gardens
- Luxury Apartment
- Two Bedrooms
- Walking Distance To Hale And Altrincham
- Ground Rent £250 Annually
- Service Charge £282.62 pcm
- Allocated Parking Space
- NO CHAIN

A WELL PRESENTED TWO BEDROOM DUPLEX APARTMENT WITH ALLOCATED RESIDENTS' PARKING..... Positioned on the top floor of a beautifully converted 19th century mansion house with a stunning communal entrance hall that includes original wood panelling and stained glass windows. Briefly comprising: Open-plan lounge, dining area and fully fitted kitchen with integrated appliances. Stairs to top floor: Principle double bedroom with fitted wardrobes. Bathroom and a second bedroom. Council tax band - C. NO CHAIN.

