

Approx Gross Floor Area = 568.6 Sq. Feet
 = 52.8 Sq. Metres

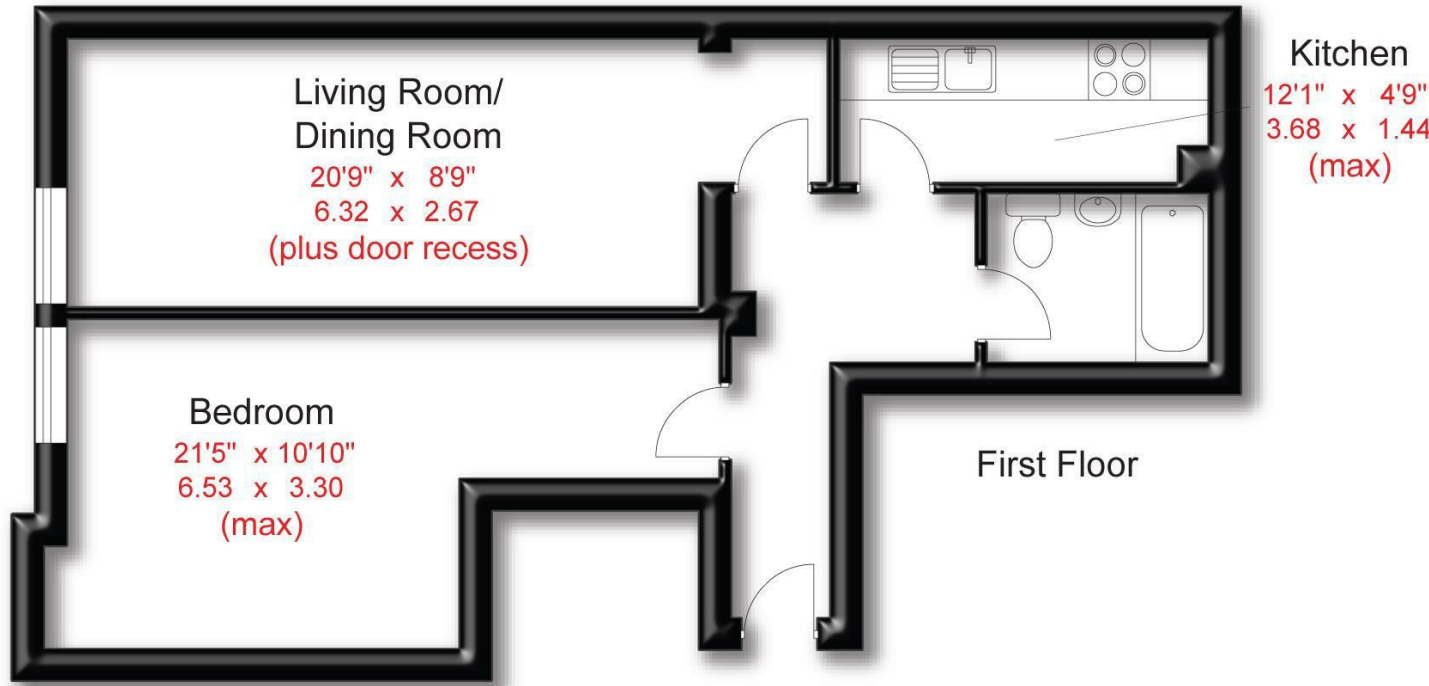

Energy Efficiency Rating		
	Current	Potential
Very energy efficient - lower running costs		
(92 plus) A		
(81-91) B		
(69-80) C		
(55-68) D	61	73
(39-54) E		
(21-38) F		
(1-20) G		
Not energy efficient - higher running costs		
England & Wales	EU Directive 2002/91/EC	



Ashley Road | Hale
Offers Over £200,000



175 Ashley Road | Hale | WA15 9SD
 t: 0161 928 9355
 e: info@hibberthomes.com
 www.hibberthomes.com

Bedrooms 1 Bath 1 Reception 1 Parking here 568 Sq Ft

- Central Hale location
- Ready to move into
- Close to all local amenities

- Immaculately presented
- Lift access

This immaculately presented apartment is located in the popular Spring House development literally in the very heart of Hale village . Close to all the local amenities and a stones throw from the train station with access into Manchester and beyond. This one bedroomed apartment briefly compromises of a entrance hall leading onto the large main bedroom a fully tiled and fitted bathroom in contemporary grey . A fitted kitchen and a lounge /dining room complete this fabulous one bedroomed apartment in the centre of Hale.

