

Approx Gross Floor Area = 713 Sq. Feet
= 66.10 Sq. Metres

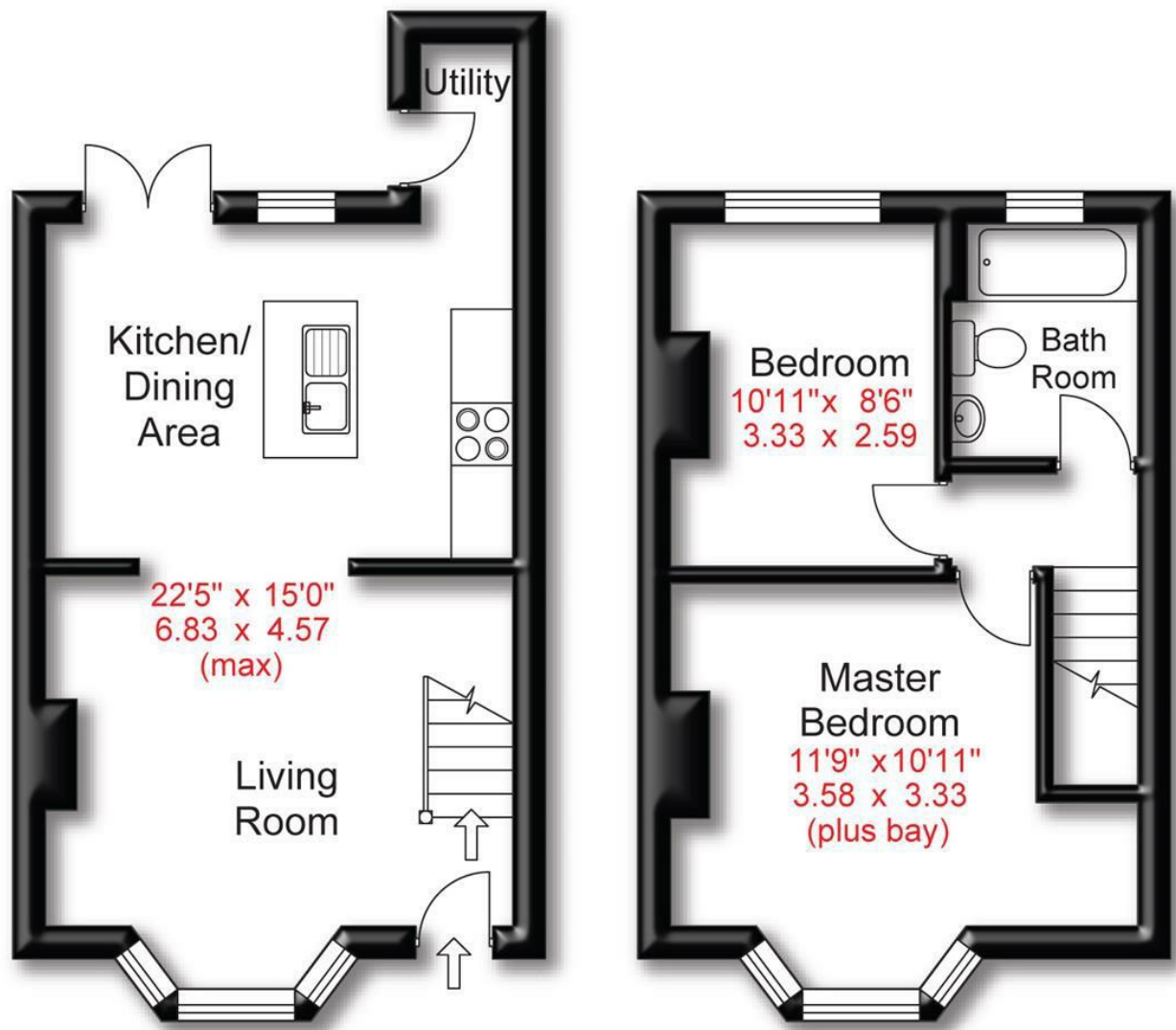

Ground Floor

First Floor



Energy Efficiency Rating		Current	Potential
Very energy efficient - lower running costs			
(92 plus) A			90
(81-91) B			
(69-80) C			
(55-68) D		58	
(39-54) E			
(21-38) F			
(1-20) G			
Not energy efficient - higher running costs			
England & Wales		EU Directive 2002/91/EC	



**HIBBERT
HOMES**

175 Ashley Road | Hale | WA15 9SD
t:0161 928 9355
e: info@hibberthomes.com
www.hibberthomes.com



**HIBBERT
HOMES**

Tolland Lane | Hale

Asking Price £410,000

Bedrooms 2

Bath 1

Reception 1

Street Parking

713 SQ FT

NO CHAIN



- Victorian Terrace
- High Standard Throughout
- 1 Bathroom
- 713 SQ FT
- Walking Distance To Hale Village

- Open Kitchen/Dining
- 2 Bedrooms
- Rear Courtyard
- Street Parking
- NO CHAIN

A CHARMING TWO DOUBLE BEDROOM PERIOD TERRACE.... Situated in a quiet corner of Hale village. Beautifully refurbished to a high standard throughout. Briefly comprising: Open plan living space with log burning stove and patio doors to an enclosed rear courtyard. Contemporary breakfast kitchen with island unit and integrated appliances. Stairs to first floor: Two double bedrooms. Bathroom with white suite and shower over the bath. Council tax band -D. EPC - D. NO CHAIN.

