

Parkgate Crescent

Hadley Wood



39 Parkgate Crescent, Hadley Wood, Herts, EN4 0NW



An extremely well presented five bedroom family residence which has been enhanced and extended to a high specification. The property is situated in a secluded position in this pleasant crescent benefitting from a south west facing rear garden backing directly onto Hadley Woods and is within easy access of Hadley Wood mainline station (Moorgate 27 minutes).

As you enter the property there is a large reception hallway with statement sweeping staircase that leads to a galleried landing. There are four reception rooms on the ground floor which include a TV room, family room, study and a dining room which opens on to the kitchen being 'Shaker' style designed with a large centre island with marble work tops and an AGA. Just off the kitchen is a utility room and a guest WC off the hallway. To complete the ground floor there is also a guest suite which also has its own en suite shower room.

To the first floor there are four double bedroom suites, three of which have either walk in wardrobes or fitted wardrobes. All three have modern fitted shower rooms which are individually designed.

The principal suite has the benefit of two dressing rooms and two en suites, one of which is a large shower room and the other comprises of a four piece suite and separate shower. The principal bedroom has double doors that lead to the roof terrace with views over the rear garden and Hadley Woods.

The mature rear garden offers a sensory experience with mature planted borders and designated eating areas across the rear terrace. There is also a covered summer kitchen and family dining area with electric heaters. A resin bonded pathway leads around the garden to a gym and a draw-bridge gate that leads you into Hadley Woods.

Approach:- The property stands behind a timber gated frontage leading to a driveway giving access to front door and providing ample guest parking. Extensive exterior lighting. Hedge borders. Covered veranda entrance. Oak double doors with wrought iron door furniture.

Location :- Situated within 0.5 miles of Hadley Wood mainline station and local conveniences. Hadley Wood golf course and tennis club are also within walking distance and educational facilities in the area include Stormont, Lochinver, St Johns, Haberdashers Askes for boys and Haberdashers Askes for girls, Mill Hill school, Belmont, Dame Alice Owen, Haileybury, Queenswood and Queen Elizabeths Girls and Boys schools.



























Parkgate Crescent, Barnet, EN4

Approximate Area = 4116 sq ft / 382.3 sq m

Outbuildings = 203 sq ft / 18.8 sq m

Total = 4319 sq ft / 401.2 sq m

For identification only - Not to scale

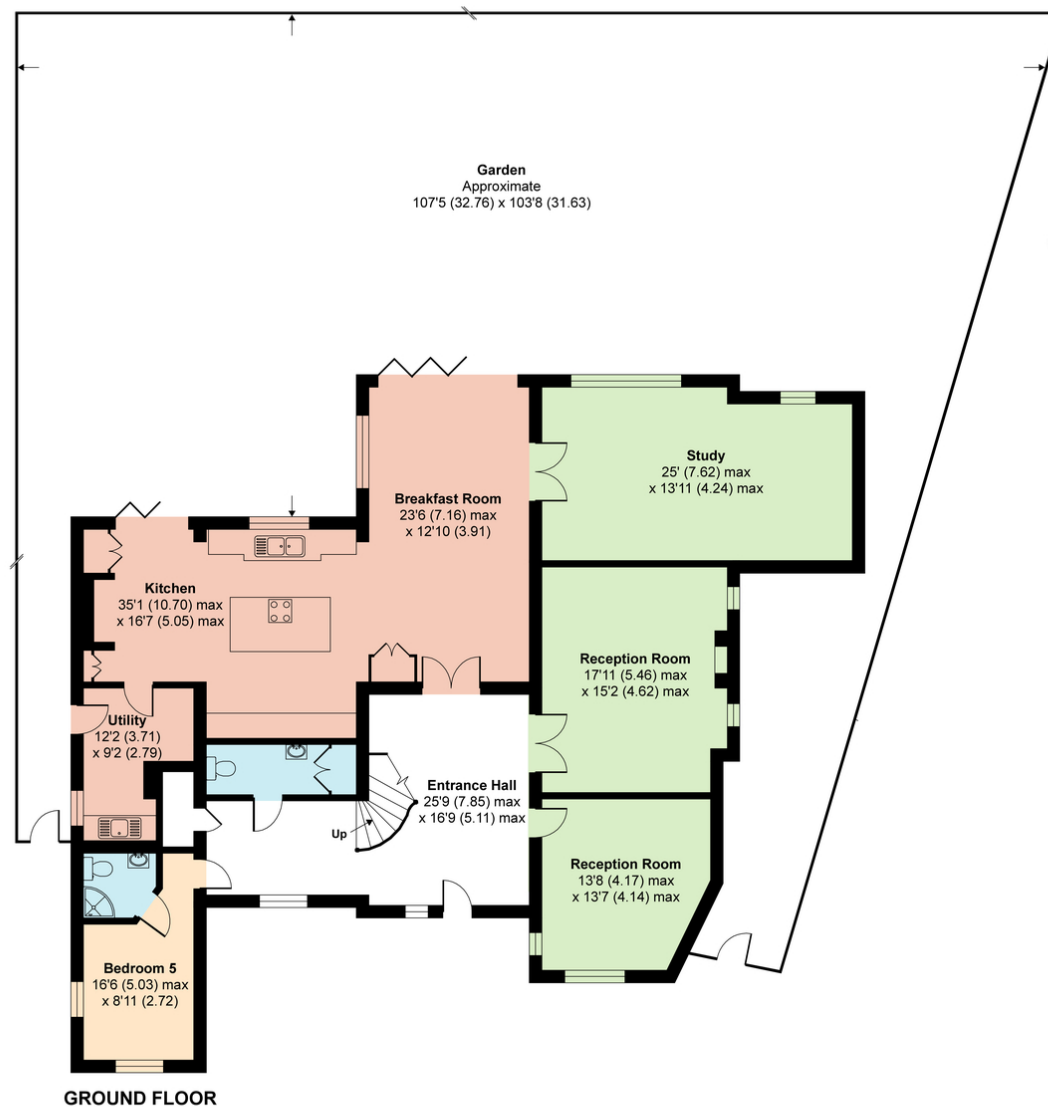

**Certified
Property
Measurer**

Floor plan produced in accordance with RICS Property Measurement Standards incorporating International Property Measurement Standards (IPMS2 Residential). ©nichecom 2021.
Produced for Statons. REF: 760902

STATONS
HADLEY WOOD
10 CRESCENT WEST
HADLEY WOOD
HERTS
EN4 0EJ
020 8440 9797
hadley@statons.com

