



## 66 Gladeville Road

Aigburth, Liverpool, L17 6DF

**Offers over £260,000**



Nestled on the charming Gladeville Road in Aigburth, Liverpool, this superbly presented terraced house offers a delightful blend of comfort and style. With two inviting reception rooms, this property is perfect for both relaxation and entertaining. The two well-proportioned bedrooms provide ample space for rest, while the truly stunning family bathroom adds a touch of luxury to everyday living.

The heart of the home is undoubtedly the beautiful kitchen, which is designed to inspire culinary creativity. Its modern features and thoughtful layout make it a joy to cook and gather with loved ones.

One of the standout features of this property is the tranquil and secluded rear courtyard, providing a peaceful outdoor space to unwind after a busy day. Whether you wish to enjoy a morning coffee or host a small gathering, this private area is a true gem.

Additionally, the location is ideal for those who appreciate the outdoors, as it is within walking distance to the picturesque Sefton Park. This vibrant area offers a variety of recreational activities, making it perfect for families and individuals alike.



Area Map

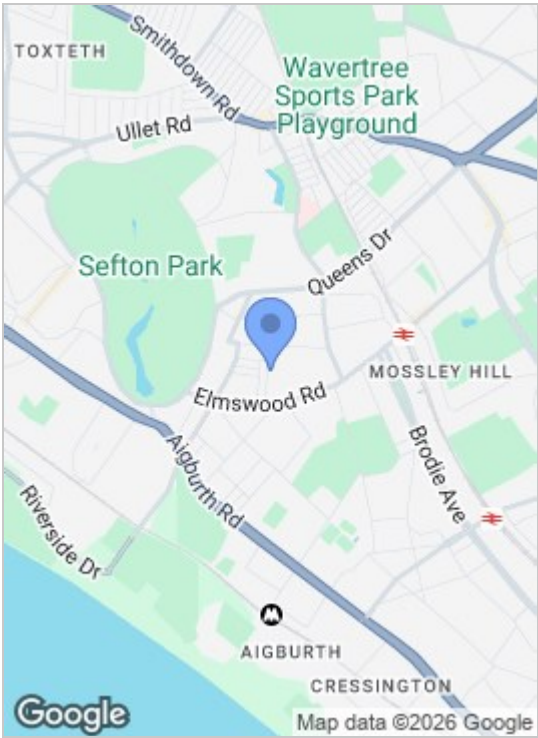

Floor Plans

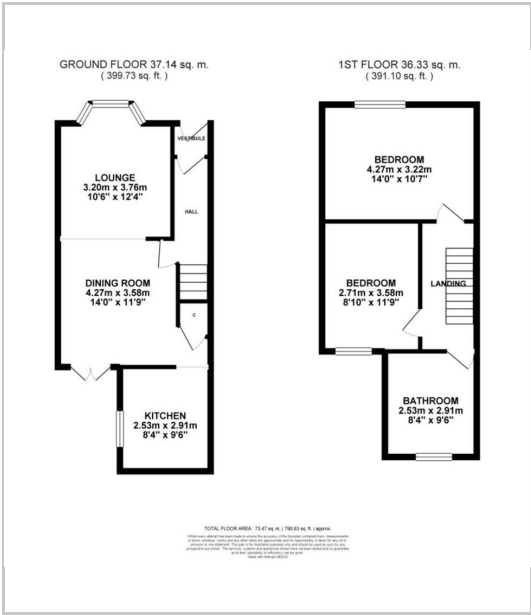

Energy Efficiency Graph



These particulars, whilst believed to be accurate are set out as a general outline only for guidance and do not constitute any part of an offer or contract. Intending purchasers should not rely on them as statements of representation of fact, but must satisfy themselves by inspection or otherwise as to their accuracy. No person in this firms employment has the authority to make or give any representation or warranty in respect of the property.

82 Coronation Road, Crosby, Liverpool L23 5RH  
**Tel:** 0151 909 3003  
**Email:** crosby@abode-group.co.uk  
**Web:** www.abode-group.co.uk

6 Allerton Road, Mossley Hill, Liverpool, L18 1LN  
**Tel:** 0151 601 3003  
**Email:** allerton@abode-group.co.uk  
**Web:** www.abode-group.co.uk

2 Chapel Lane, Formby, Liverpool, L37 4DU  
**Tel:** 01704 827 402  
**Email:** formby@abode-group.co.uk  
**Web:** www.abode-group.co.uk